



The Greaves Kingsbury Road, Minworth Sutton Coldfield B76 9DJ



welcome to

The Greaves Kingsbury Road, Minworth Sutton Coldfield

****LOCATED BETWEEN MINWORTH AND CURDWORTH**GROUND FLOOR APARTMENT**NO CHAIN**LOUNGE**FITTED KITCHEN**ONE DOUBLE BEDROOM**BATHROOM**ALLOCATED PARKING SPACE**CLOSE TO MOTORWAY NETWORK****



Agent Note

Council Tax Band C.

Entrance Hall

Intercom, storage and three ceiling light points.

Lounge

14' 6" x 10' 3" (4.42m x 3.12m)

Double glazed window to front, storage, door to airing cupboard, heater and two ceiling light points.

Kitchen

10' 4" max x 6' 5" (3.15m max x 1.96m)

Double glazed window to side, cupboard draw units, roll top work surfaces, steel sink and drainer, stainless steel hob and hood, stainless steel oven, fridge freezer, tiled splashback and floor and dishwasher.

Bedroom One

12' 7" max x 10' 5" (3.84m max x 3.17m)

Double glazed window to side, built in wardrobes, coving, electric wall heater and ceiling light point.

Bathroom

Panel bath with shower over, low level wc, pedestal basin, tiled walls and ceiling light point.

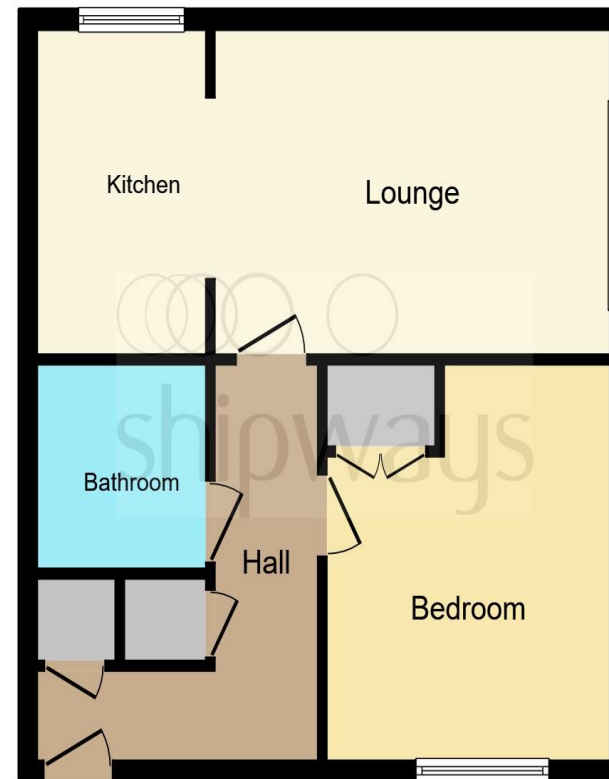

This floor plan is for illustrative purposes only. It is not drawn to scale. Any measurements, floor areas (including any total floor area), openings and orientation are approximate. No details are guaranteed, they cannot be relied upon for any purpose and they do not form part of any agreement. No liability is taken for any error, omission or misstatement. A party must rely upon its own inspection(s). Powered by www.focalagent.com



view this property online shipways.co.uk/Property/CAB111629



welcome to

The Greaves Kingsbury Road, Minworth Sutton Coldfield

- LARGER TYPE GROUND FLOOR APARTMENT
- OUTSKIRTS OF VILLAGE LOCATION
- ONE BEDROOM
- ALLOCATED PARKING SPACE
- NO CHAIN

Tenure: Leasehold EPC Rating: C

Council Tax Band: C Service Charge: 1606.00

Ground Rent: 111.30

This is a Leasehold property with details as follows; Term of Lease 125 years from 01 Jan 2001. Should you require further information please contact the branch. Please Note additional fees could be incurred for items such as Leasehold packs.

offers over

£120 000



Please note the marker reflects the
postcode not the actual property

view this property online shipways.co.uk/Property/CAB111629



Property Ref:
CAB111629 - 0007

1. MONEY LAUNDERING REGULATIONS Intending purchasers will be asked to produce identification documentation at a later stage and we would ask for your co-operation in order that there is no delay in agreeing the sale. 2. These particulars do not constitute part or all of an offer or contract. 3. The measurements indicated are supplied for guidance only and as such must be considered incorrect. Potential buyers are advised to recheck measurements before committing to any expense. 4. We have not tested any apparatus, equipment, fixtures or services and it is in the buyers interest to check the working condition of any appliances. 5. Where an EPC, or a Home Report (Scotland only) is held for this property, it is available for inspection at the branch by appointment. If you require a printed version of a Home Report, you will need to pay a reasonable production charge reflecting printing and other costs. 6. We are not able to offer an opinion either written or verbal on the content of these reports and this must be obtained from your legal representative. 7. Whilst we take care in preparing these reports, a buyer should ensure that his/her legal representative confirms as soon as possible all matters relating to title including the extent and boundaries of the property and other important matters before exchange of contracts.

Shipways is a trading name of Sequence (UK) Limited which is registered in England and Wales under company number 4268443, Registered Office is Cumbria House, 16-20 Hockliffe Street, Leighton Buzzard, Bedfordshire, LU7 1GN. VAT Registration Number is 500 2481 05.

shipways



0121 747 4722



castlebromwich@shipways.co.uk



258 Chester Road, Castle Bromwich,
BIRMINGHAM, West Midlands, B36 0JE



shipways.co.uk