



## VINEYARD PATH, SW14

£625,000

Two double bedrooms  
Split level  
Private balcony  
Garage  
Moments from the Thames  
Mortlake

@marshandparsons  
marshandparsons.co.uk

MARSH &  
PARSONS



# ABOUT THE PROPERTY

This well presented maisonette combines the charm and proportions of a townhouse with the convenience of modern living.

The property is located moments from Mortlake Green, the Thames and the charming Barnes Village, with its duck pond, boutique shops, cafés and restaurants, the apartment is also within easy reach of White Hart Lane, East Sheen High Street, and beautiful Thames towpath walks. Mortlake has regular trains into Clapham, Waterloo and Richmond.



# STEP INSIDE VINEYARD PATH

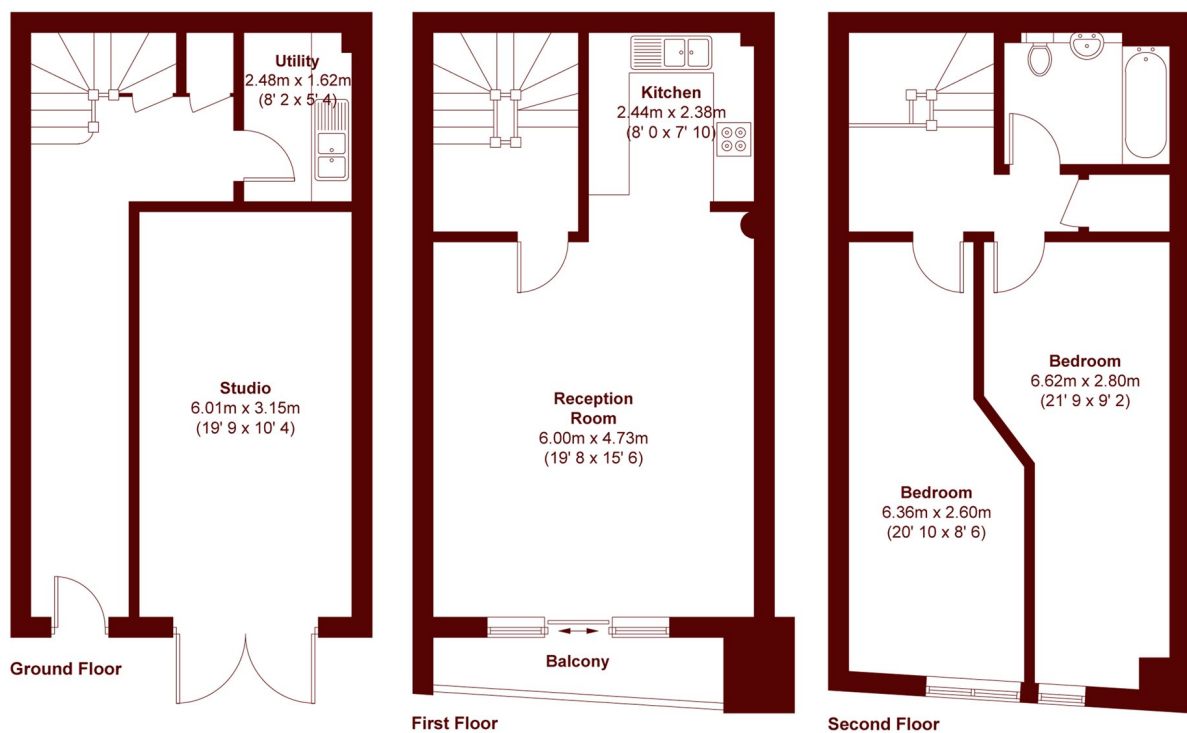

APPROX. GROSS INTERNAL FLOOR AREA = 1167 SQFT / 108.4 SQM  
APPROX. GROSS EXTERNAL STUDIO AREA = 207 SQFT / 19.2 SQM  
APPROX. GROSS EXTERNAL BALCONY AREA = 39 SQFT / 3.6 SQM

**Barnes & East Sheen**  
020 8563 8333

Energy Rating: B We aim to make our particulars both accurate and reliable. However, they are not guaranteed; nor do they form part of an offer or contract. If you require clarification on any points then please contact us, especially if you're traveling some distance to view. Please note that appliances and heating systems have not been tested and therefore no warranties can be given as to their good working order

**MARSH &  
PARSONS**