



Osborne Road, London NW2

£400,000 Leasehold

Welcome to Osborne Road — a generously proportioned one-bedroom first floor apartment set on a quiet residential road in this popular London location. Offering over 640 sq ft of internal space, the property is presented in good condition and features a bright reception room, a well-sized double bedroom, bathroom and a spacious eat-in kitchen, ideal for everyday living and entertaining. The apartment benefits from a 106-year lease and enjoys a superb position just a short walk from Willesden Green High Road, with its range of shops, cafés and amenities. Gladstone Park is also nearby, along with the Jubilee line, providing excellent transport links into Central London. A well-balanced home with generous proportions, perfect for first-time buyers, investors or those seeking a conveniently located London base.

- First floor apartment
- Double bedroom
- 645 square foot
- Great location
- Leasehold
- Quiet residential Road
- Eat-in kitchen
- Bright and airy
- Generous proportions
- Close to shops and transports

First Floor

Approx. 59.9 sq. metres (645.2 sq. feet)

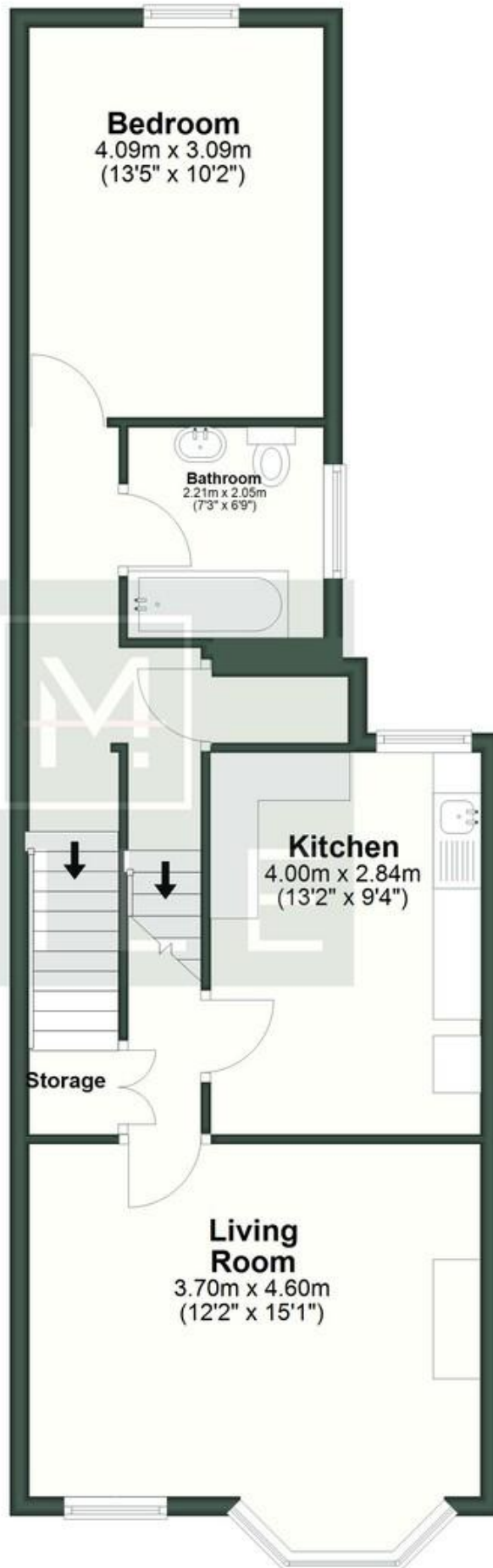

Ground Floor

Approx. 6.4 sq. metres (69.0 sq. feet)

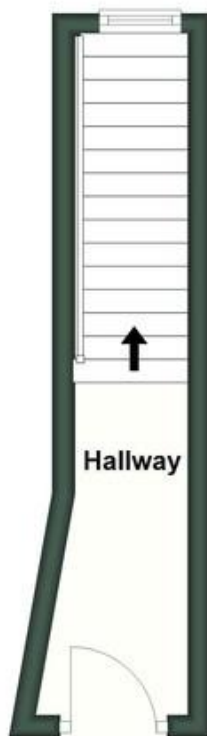

MONEY LAUNDERING REGULATIONS 2003: Intending purchasers will be asked to produce identification documentation at a later stage and we would ask for your co-operation in order that there will be no delay in agreeing the sale.

General: While we endeavour to make our sales particulars fair, accurate and reliable, they are only a general guide to the property and, accordingly, if there is any point which is of particular importance to you, please contact the office and we will be pleased to check the position for you, especially if you are contemplating travelling some distance to view the property.

Measurements: These approximate room sizes are only intended as general guidance. You must verify the dimensions carefully before ordering carpets or any built-in furniture.

Services: Please note we have not tested the services or any of the equipment or appliances in this property, accordingly we strongly advise prospective buyers to commission their own survey or service reports before finalising their offer to purchase.