

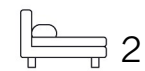

Living
made
better

Adriatic Apartments
Royal Victoria Dock, E16 1BU



Asking Price £495,000

Adriatic Apartments, Royal Victoria Dock, E16 1BU

Madison Brook

Property Summary

A spacious two bedroom dock-facing apartment offering approximately 1,194 sq.ft., featuring a large open-plan living space, two balconies (one south-facing) and impressive views across the Royal Docks. With underground parking, 24/7 concierge and excellent transport links via Custom House (Elizabeth Line) and Royal Victoria DLR, this is a superbly located and well-appointed home.

Service Charge: £6,700 pa | Ground Rent: £250 pa | Lease Remaining: 134 years

Floorplan

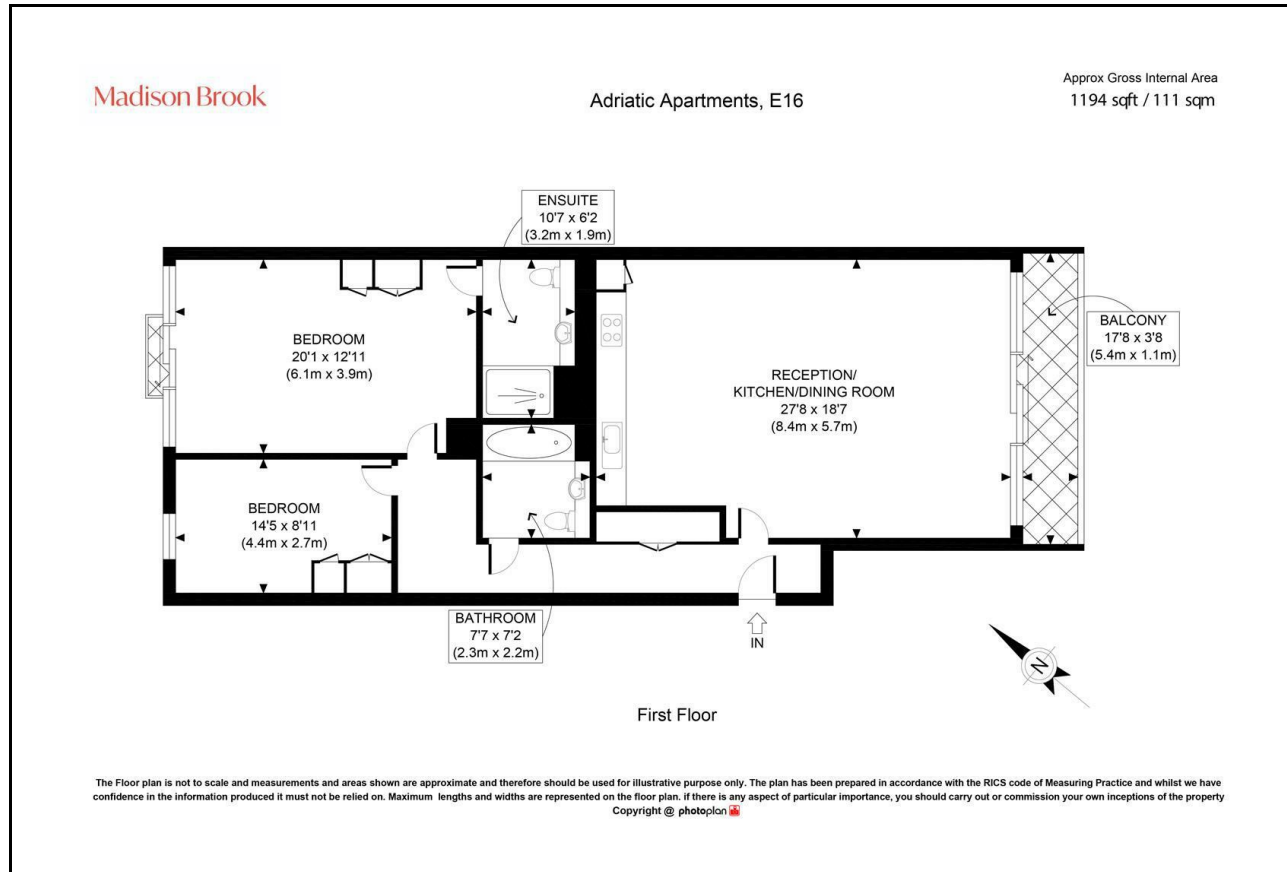

Area Map

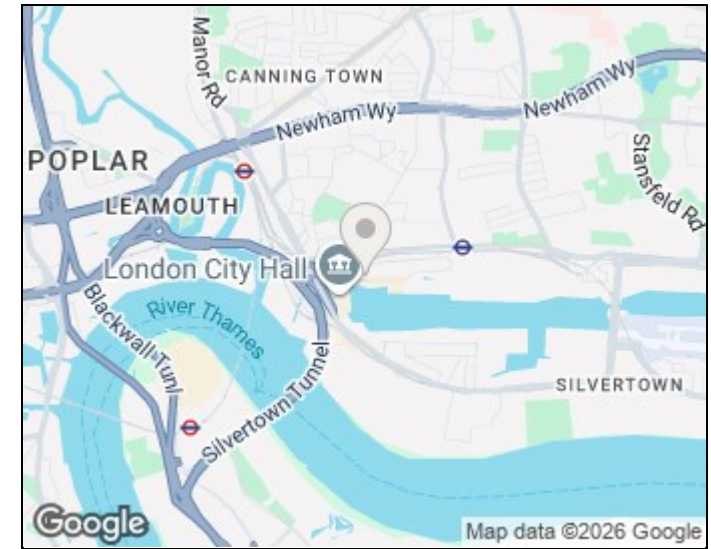

Energy Efficiency Graph

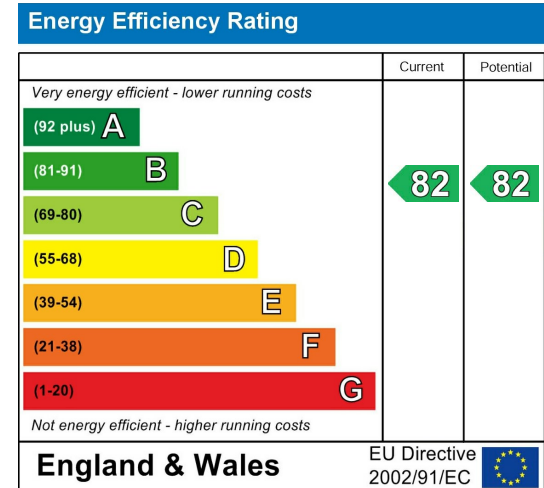

These particulars, whilst believed to be accurate are set out as a general outline only for guidance and do not constitute any part of an offer or contract. Intending purchasers should not rely on them as statements of representation of fact, but must satisfy themselves by inspection or otherwise as to their accuracy. No person in this firm's employment has the authority to make or give any representation or warranty in respect of the property.

Unit B 20 Western Gateway, Royal Victoria
Dock, London, E16 1BS
Tel: 020 3946 6000 Email:
docklands@madisonbrook.com
<https://madisonbrook.com/>