



ALASTAIR SAVILLE
ESTATE AGENTS

Bankhouse Drive, Maghull

£475,000

 4  3  2

- Detached Executive Residence
- Four Double Bedrooms, One With Ensuite (One Currently Used As A Dressing Room)
- Large Kitchen/ Diner With Bi Fold Doors Leading Out To The Garden
- Built By Redrow Homes in 2019
- EPC Rating- B
- Ideal Family Home With Spacious Accommodation Throughout
- Two Reception Rooms
- Low Maintenance Rear Garden With Artificial Lawns, Patio Area And Decking
- Detached Studio/ Office In Rear Garden
- Council Tax Band- E



WOW! BEAUTIFUL DETACHED EXECUTIVE RESIDENCE IN THE SOUGHT AFTER LOCATION OF BANKHOUSE DRIVE, BUILT BY REDROW HOMES IN 2019, CREDIT TO THE CURRENT VENDORS, FEATURES THROUGHOUT WHICH AREN'T EXPECTED IN NEW BUILT PROPERTIES, FOUR DOUBLE BEDROOMS (ONE USED AS A DRESSING ROOM)- ONE WITH AN ENSUITE, TWO RECEPTION ROOMS, LARGE KITCHEN/DINER TO THE REAR WITH BI FOLD DOORS LEADING OUT TO THE STUNNING REAR GARDENS, UTILITY ROOM AND WC, DETACHED OFFICE/ STUDIO IN THE REAR GARDEN, ENCLOSED LOW MAINTENANCE REAR GARDENS WITH ARTIFICIAL LAWNS, DECKING AND PATIOS, PERFECT FAMILY HOME. VIEWING ESSENTIAL!

Having been built by Redrow Homes in 2019, the current vendors of this property have lovingly made it a superb family home with adaptations and additions making it a real one off property. Being beautifully presented throughout, the property

enjoys a lovely plot with a detached studio/office which is perfect for anyone looking to work from home.



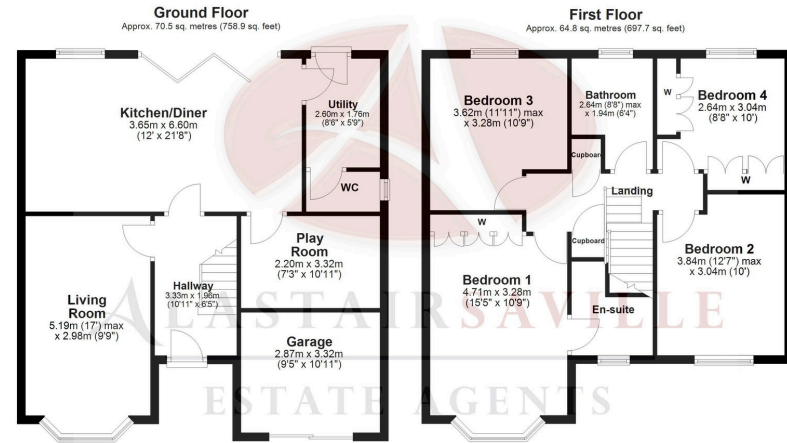

Total area: approx. 135.3 sq. metres (1456.6 sq. feet)

