



St. Johns Court St. Johns Road  
Isleworth, TW7 6PA

£385,000

Situated in a quiet cul-de-sac, this beautifully presented two bedroom ground floor maisonette is offered to the market. Ideally located for access to Isleworth Train Station and the cafes, shops and amenities of Isleworth Village.

Service Charge: N/A

Tenure: Share of Freehold

Ground Rent: N/A

- Two Bedrooms
- Beautifully Presented
- Private Rear Garden
- Allocated Off Street Parking
- Close to Public Transport
- Insulated Outbuilding
- Share of Freehold
- No Ground Rent & Service Charge



570 sq.ft. (53.0 sq.m.) approx.

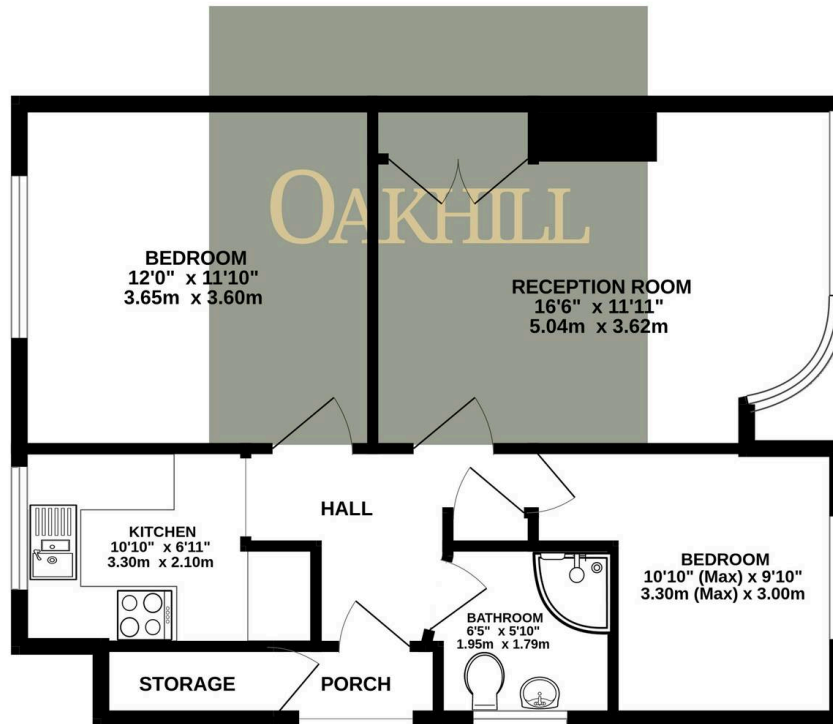
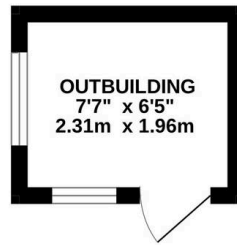

TOTAL FLOOR AREA : 570 sq.ft. (53.0 sq.m.) approx.

Whilst every attempt has been made to ensure the accuracy of the floorplan contained here, measurements of doors, windows, rooms and any other items are approximate and no responsibility is taken for any error, omission or mis-statement. This plan is for illustrative purposes only and should be used as such by any prospective purchaser. The services, systems and appliances shown have not been tested and no guarantee as to their operability or efficiency can be given.  
Made with Metropix ©2025