



Ogmore Crescent, £125,000

- No Onwards Chain
- Off Road Parking
- Larger Corner Plot
- Bags of Potential
- Close To Local Amenities
- Council Tax Band - B
- EPC Rating: Awaited



 3  1  1



About the property

Three bedroom end terraced property, situated on Ogmore Crescent in Bettws, Newport. The property has local shops and amenities nearby and is set in a popular location for commuters, benefiting from easy access on to the M4 for Cardiff and Bristol. The property is set on a large plot with off road parking and has bags of potential.

Call Today to book your viewing.



Accommodation

Entrance Hallway

Kitchen

23' 7" x 7' 2" (7.19m x 2.18m)

Living Room

23' 7" x 10' 9" (7.19m x 3.28m)

Bedroom One

11' 11" x 12' 8" (3.63m x 3.86m)

Bedroom Two

10' 5" x 11' (3.17m x 3.35m)

Bedroom Three

13' 7" x 5' 8" (4.14m x 1.73m)

Bathroom

Wc

Outside

Floorplan

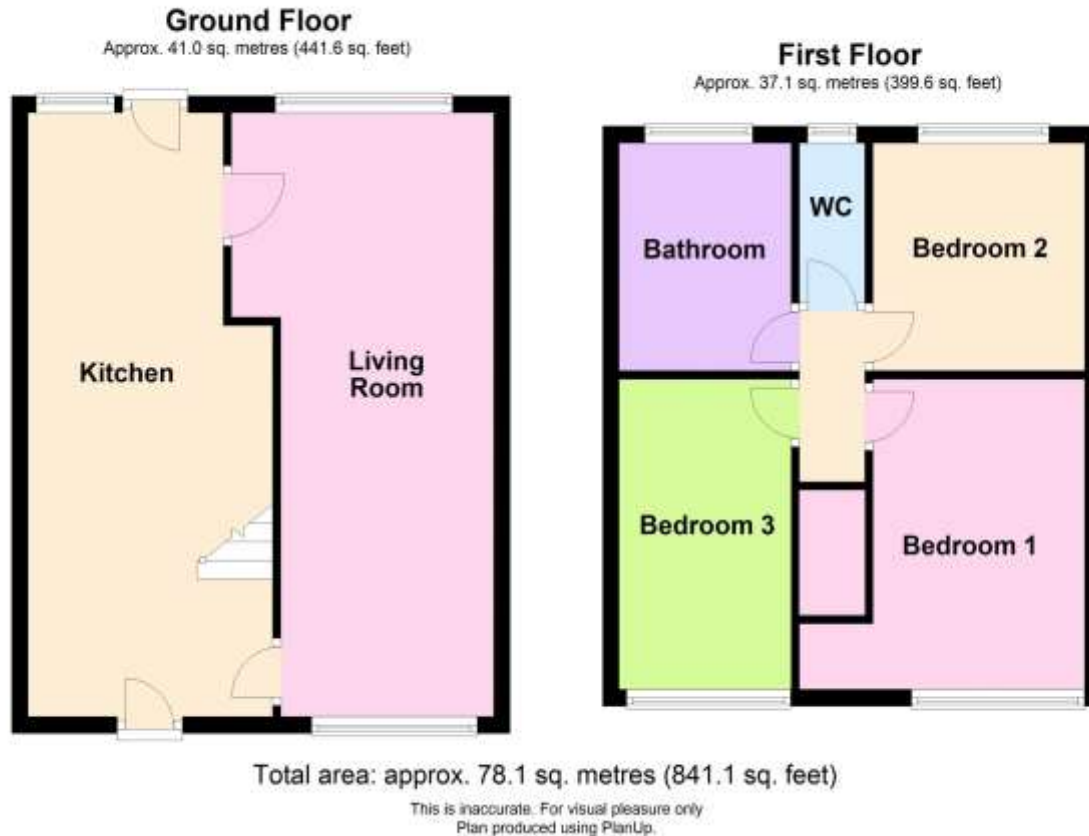

Important Information

Note while we endeavour to make our sales details accurate and reliable, if there is any point which is of particular interest to you, please contact the office and we will be pleased to confirm the position for you. We have not personally tested any apparatus, equipment, fixtures, fittings or services and cannot verify they are in working order or fit for their purposes. Nothing in these particulars is intended to indicate that carpets or curtains, furnishings or fittings, electrical goods (whether wired or not). Gas fires or light fittings or any other fixtures not expressly included form part of the property offered for sale. This computer generated Floorplan, if applicable, is intended as a general guide to the layout and design of the property. It is not to scale and should not be relied upon for dimensions. Tenure: We cannot confirm the tenure of the property as we have not had access to the legal documents. The buyer is advised to obtain verification from their solicitor or surveyor.