



5 CLARENDON MEWS BEXLEY KENT
DA5 1JS
PRICE: £300,000 | Leasehold



CHAIN FREE. Park Estates are delighted to present this well-appointed two bedroom ground floor retirement apartment, enjoying a bright, sunny aspect in the desirable clock tower corner with attractive river views. Set within the highly sought-after Clarendon Mews development, the property sits peacefully in the heart of Old Bexley Village, offering both convenience and charm. The accommodation features an entrance hall, shower room, fitted kitchen, two bedrooms and a generous reception room opening directly onto a private terrace and the beautifully maintained communal gardens overlooking the River Cray. Additional benefits include new extended lease, a gated entrance, double glazing, electric Fischer radiators, a welcoming residents' lounge, on-site warden manager, parking and landscaped communal grounds. Early viewing is strongly advised.

Local Authority: Bexley
Council Tax Band: D

Score	Energy rating	Current	Potential
92+	A		
81-91	B		
69-80	C		
55-68	D	55 D	77 C
39-54	E		
21-38	F		
1-20	G		

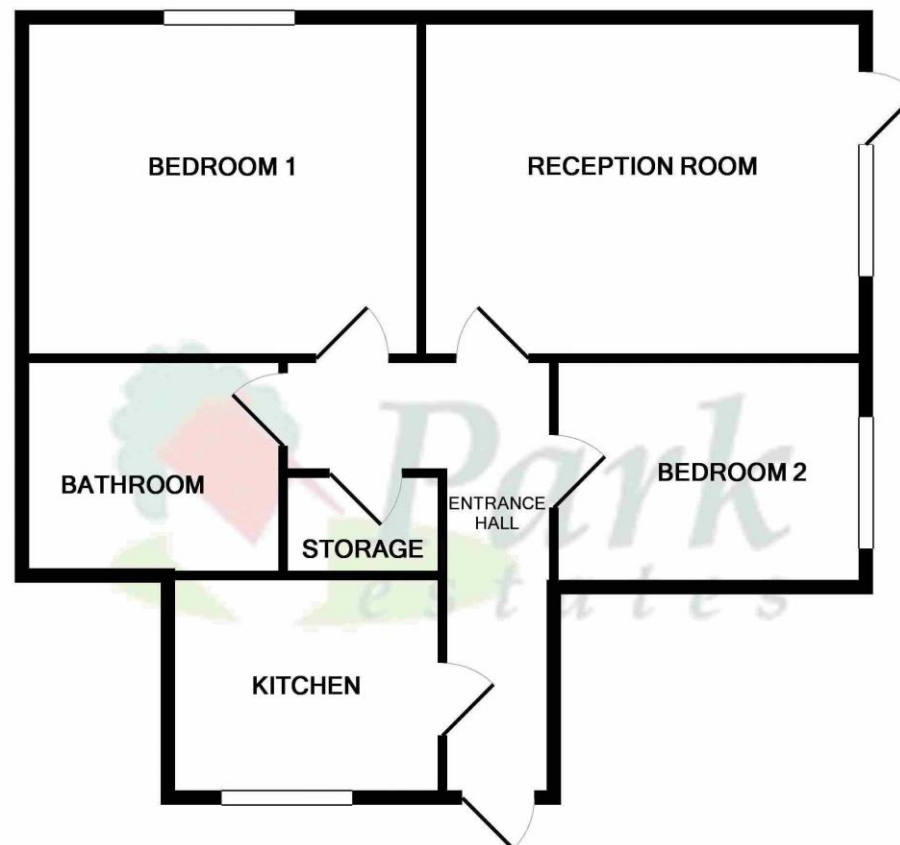

TOTAL APPROX. FLOOR AREA 651 SQ.FT. (60.4 SQ.M.)

Whilst every attempt has been made to ensure the accuracy of the floor plan contained here, measurements of doors, windows, rooms and any other items are approximate and no responsibility is taken for any error, omission, or mis-statement. This plan is for illustrative purposes only and should be used as such by any prospective purchaser. The services, systems and appliances shown have not been tested and no guarantee as to their operability or efficiency can be given.
Made with Metropix ©2018



01322 553322

60-62 High Street, Bexley, Kent DA5 1AH
bexley@parkestates.co.uk
www.parkestates.co.uk

Every care has been taken with the preparation of details, but accuracy is in no way guaranteed. These particulars do not constitute a contract and are issued and accepted on the express understanding that all negotiations will be conducted through Park Estates. The seller does not make or give, nor do we or our employees have any authority to give a representation or warranty in relation to the property. Please contact this office before viewing the property. If there is any point which is of particular importance to you, we will be pleased to check the information for you and confirm that the property remains available. This is particularly important if you are contemplating travelling some distance to view the property. We would strongly recommend that all the information that we provide about the property is verified by yourself on inspection and also by your conveyancer, especially where statements have been made by us to the effect that the information provided by us has not been verified.