



## Grange Road, SE1

### £595,000

A rarely available south-facing apartment, with large windows and a dual aspect, a very generous living room and a separate modern kitchen, two double bedrooms and a three piece family bathroom. Presented chain-free, this property represents a superb opportunity in a sought-after location.

The Alaska Buildings is a landmark development just a short stroll from the cafés, boutiques, and restaurants of Bermondsey Street and the shops along Tower Bridge Road. Bermondsey and London Bridge stations are within easy walking distance, offering effortless access to central London, while the area blends historic charm with modern city living.

### Features

- South-Facing Apartment
- Wonderful Natural Light
- Two Bedrooms
- Large Living Space
- 24 Hour Concierge
- Communal Gardens
- Chain Free Sale

# Grange Road, London, SE1

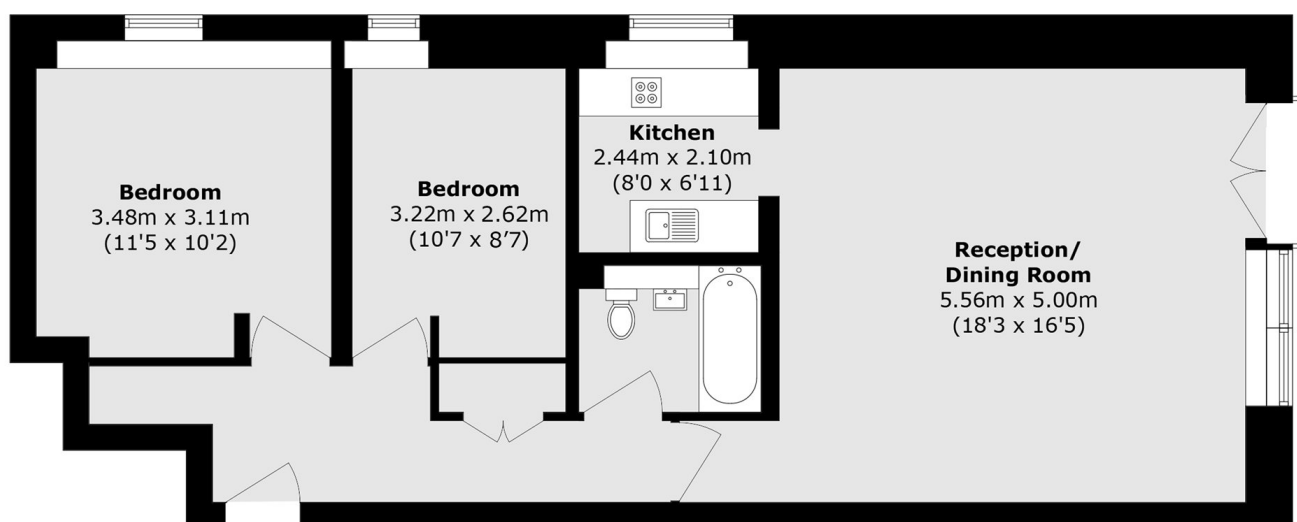

Total area (approx.): 72.9 sq. m (784.6 sq. ft)