



Connells

Medeswell
Orton Malborne Peterborough



Property Description

Located in the popular residential area of Orton Malborne, this three-bedroom semi-detached house is offered to the market with no onward chain, making it an ideal choice for a smooth and speedy move.

Upon entering, you're welcomed by an entrance hall leading into a spacious lounge/diner, perfect for both relaxing and entertaining. The kitchen is well-appointed with ample storage and workspace, ideal for everyday cooking and family meals.

Upstairs, the property boasts three well-proportioned bedrooms and a family bathroom, offering comfortable living space for a growing family or professional couple.

Outside, the home benefits from an enclosed rear garden, providing a safe and private space for children or pets. To the front, there is a driveway and a single garage, offering convenient off-road parking and additional storage.

Situated close to local schools, shops, and transport links, this property combines comfort, convenience, and potential—ready for its next chapter.

A well-presented three-bedroom semi-detached home in Orton Malborne, offered with no onward chain. Featuring a spacious lounge/diner, modern kitchen, enclosed rear garden, driveway, and garage—perfect for families or first-time buyers.

Entrance Hall

Carpet, door to front stairs to first floor and cupboard under stairs.

Lounge/Diner

11' 6" x 20' max (3.51m x 6.10m max)
Window to front, two radiators, carpet and window to the rear.

Kitchen

9' 2" x 11' 4" (2.79m x 3.45m)
Window and door to rear, space for fridge/freezer, space for gas oven and washing machine, sink/drain, high and low level storage with worktops over, wall mounted boiler, vinyl flooring and tiled walls.

First Floor Landing

Double airing cupboard, loft hatch and carpet.

Bedroom One

10' 6" max x 11' 2" (3.20m max x 3.40m)
Window to rear, carpet and radiator.

Bedroom Two

8' 2" x 11' 1" (2.49m x 3.38m)
Window to front, radiator and carpet.

Bedroom Three

8' 3" x 6' (2.51m x 1.83m)

Measurements plus fitted wardrobe - Window to front, fitted wardrobe, radiator and carpet.

Bathroom

Window to rear, bath with shower over and glass screen, tiled walls, vinyl flooring, wash hand basin, WC and radiator.

Outside

Rear Garden

Grass, patio area, shed and side access to drive.

Garage

11' 6" x 8' (3.51m x 2.44m)

Electric and up and over door.







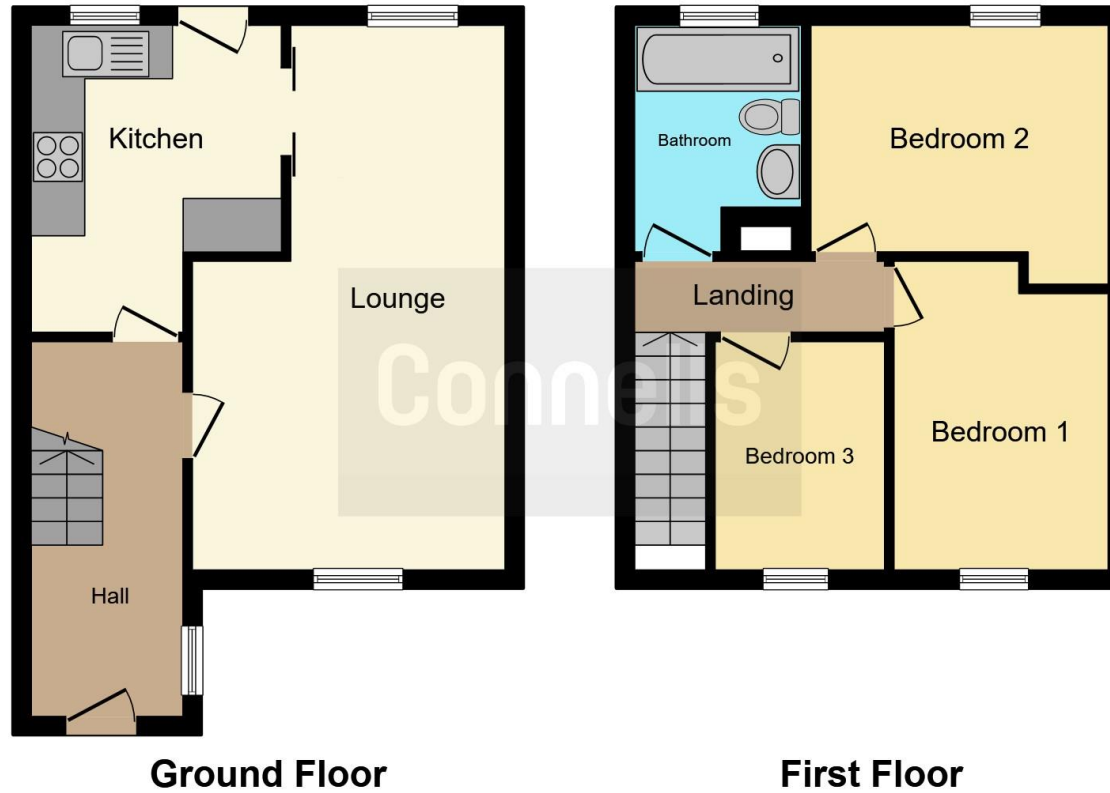

This floor plan is for illustrative purposes only. It is not drawn to scale. Any measurements, floor areas (including any total floor area), openings and orientation are approximate. No details are guaranteed, they cannot be relied upon for any purpose and they do not form part of any agreement. No liability is taken for any error, omission or misstatement. A party must rely upon its own inspection(s). Powered by www.focalagent.com

To view this property please contact Connells on

T 01733 314 775
E peterborough@connells.co.uk

14 Cowgate
 PETERBOROUGH PE1 1NA

EPC Rating: Council Tax
 Awaited Band: B

Tenure: Freehold

view this property online connells.co.uk/Property/PBO312302



1. MONEY LAUNDERING REGULATIONS Intending purchasers will be asked to produce identification documentation at a later stage and we would ask for your co-operation in order that there will be no delay in agreeing the sale. 2. These particulars do not constitute part or all of an offer or contract. 3. The measurements indicated are supplied for guidance only and as such must be considered incorrect. Potential buyers are advised to recheck measurements before committing to any expense. 4. We have not tested any apparatus, equipment, fixtures, fittings or services and it is in the buyers interest to check the working condition of any appliances.

Connells Residential is registered in England and Wales under company number 1489613, Registered Office is Cumbria House, 16-20 Hockliffe Street, Leighton Buzzard, Bedfordshire, LU7 1GN. VAT Registration Number is 500 2481 05.

See all our properties at www.connells.co.uk | www.rightmove.co.uk | www.zoopla.co.uk

Property Ref: PBO312302 - 0002