



Turner Street, E1 £385,000

Two bedroom apartment in a private block and a sought after location. The property has a spacious, bright, open plan living area with a fully integrated kitchen and ample space to dine. The property has two double bedrooms, the principle bedroom has in-built storage. There is also further additional storage in the hallway along with the bathroom.

Located on Turner Street and is conveniently located close to many local hot spots including Brick Lane, Spitalfields, Shoreditch and within walking distance to the City and Whitechapel Station.

Features

- Two bedrooms
- Private block
- Modern interiors
- Great location
- Great transport links

Turner Street,
London, E1

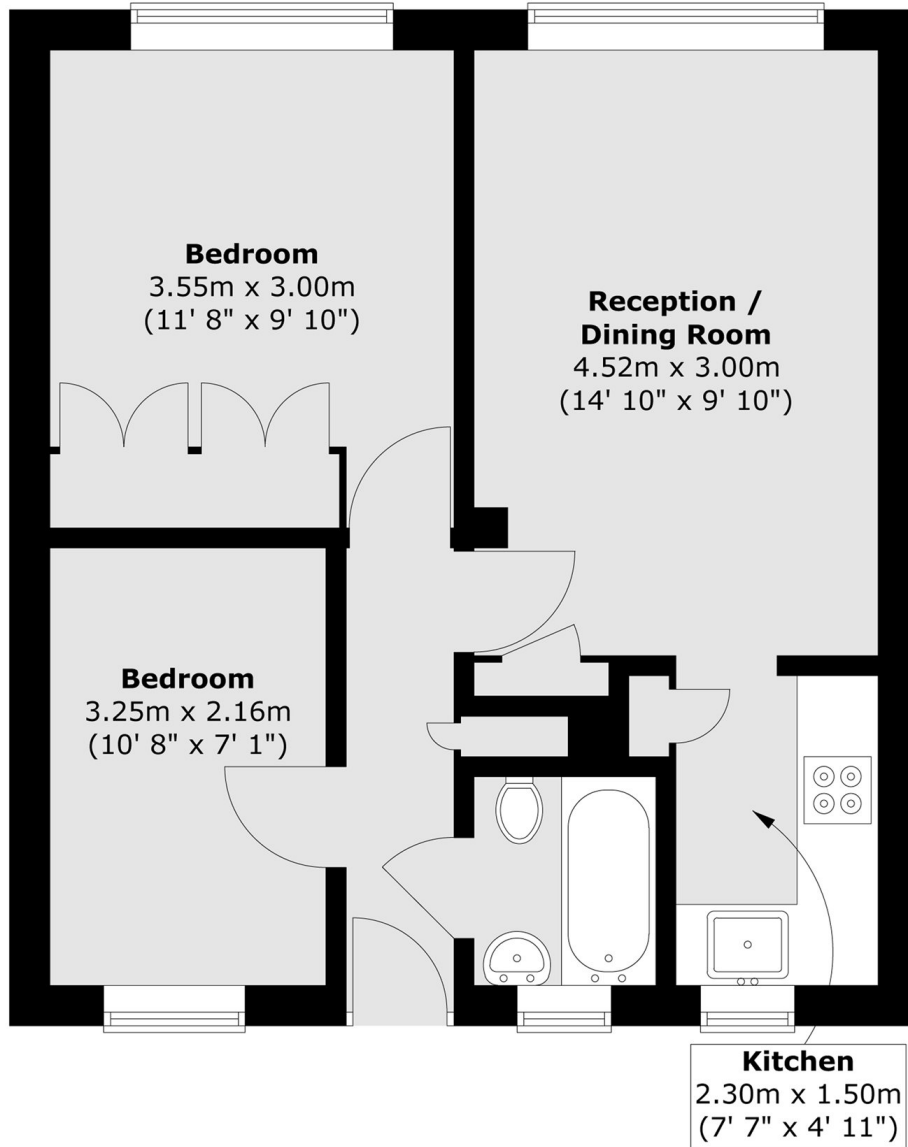

Total area (approx.) :42.9 sq. m (462 sq. ft)