



Sidford High Street, Sidmouth

Guide Price £650,000

3 1 2



- Covered Porch & Entrance Hallway
- Kitchen with a separate Utility area and adjoining Breakfast Room
- Family Bathroom
- One Double Garage and Two Single Garages with plenty of off road parking
- No Onward Chain
- Two Spacious Reception Rooms
- Three Double Bedrooms
- Southerly Facing Balcony with Fabulous Views
- Generously Sized Plot
- Energy Rating TBC



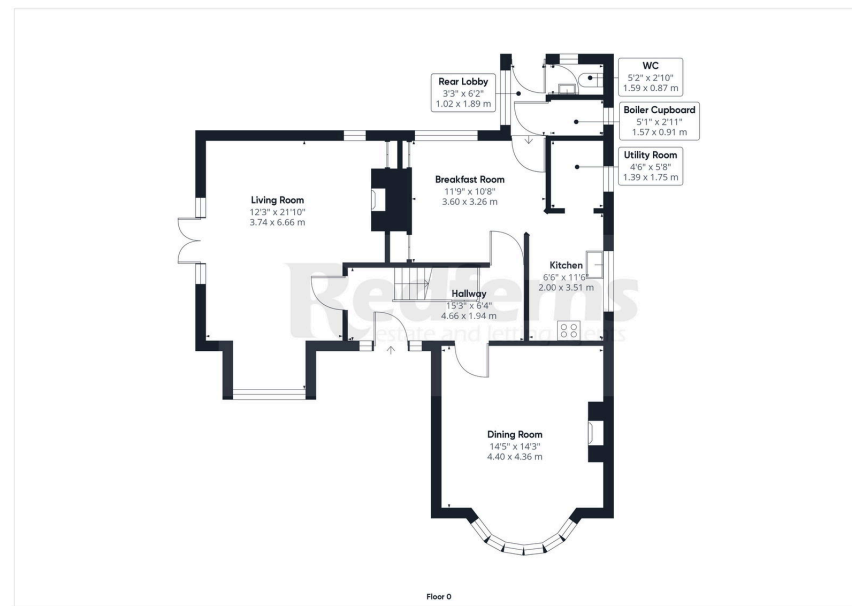

An attractive 1930's detached house occupying a generously sized plot with previously approved outline planning permission, four garages, and a large driveway. Now requiring general modernisation throughout. Offered with NO ONWARD CHAIN.

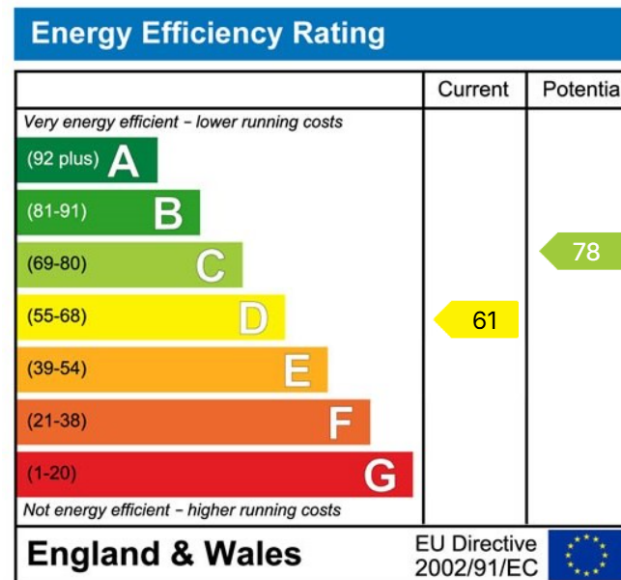

Ottery St. Mary
Exeter
Sidmouth

01404 814 306
01392 984 511
01395 512 544

www.redfernsproperty.co.uk | sales@redfernsproperty.co.uk



Redferns is a trading name of Redferns Ottery St Mary Limited. Registered in England and Wales 48170778. Registered office 8 Mill Street, Ottery St Mary, EX11 1AD