



£205,000

At a glance...



2



1



1

EPC

C

COUNCIL
TAX

B

**holland
& odam**

38 Gould Close
Street
Somerset
BA16 0AZ

TO VIEW

3 Farm Road, Street,
Somerset BA16 0BJ

01458 841411

street@hollandandodam.co.uk



Directions

From the High Street proceed in an easterly direction until reaching the Wessex Hotel on the right. Proceed straight across the mini roundabout into Church Road and take the first right hand turning into Strode Road, passing the indoor swimming pool. Continue crossing the junction at the bottom of Bove Moor Road into the development, where the turning to Gould Close is the second on your left. Follow the road around to the right and no 38 will be found on the left handside and identified by our for sale board.

Services

Mains electricity, gas, water and drainage are connected. Gas central heating system.

Local Authority

Somerset Council
0300 1232224
somerset.gov.uk

Tenure

Freehold



Location

The property is situated within an established area of the town which offers a good range of shopping facilities including Clarks Village complex of factory shopping outlets. Street also offers recreational facilities including theatre, tennis, bowls, and both indoor and outdoor swimming pools. The historic town of Glastonbury is within 3 miles, the Cathedral City of Wells 9 miles and the nearest M5 motorway interchange at Dunball, Bridgwater is within 14 miles. Bristol, Bath, Taunton and Exeter are each within an hours drive.

Insight

Available with no onward chain, this modern two bedroom terrace house represents an ideal first time purchase or buy-to-let investment. Conveniently positioned within a popular residential area of Street, the property enjoys driveway parking, an enclosed rear garden and countryside views to the rear. Offering well proportioned accommodation throughout, this is a practical and easily manageable home within reach of local amenities and schools.

- Modern two bedroom terrace house situated within a popular residential area of Street, ideal for first time buyers or investment purchasers.
- Driveway parking to the front for two to three vehicles together with a lawned frontage and entrance porch.
- Sitting room with stairs rising to the first floor and useful built-in understair storage cupboards.
- Kitchen/dining room fitted with a modern range of wall, base and drawer units with integrated electric oven and gas hob. Further space for an upright fridge/freezer.
- Two evenly sized double bedrooms, with the rear bedroom enjoying views over the garden and across adjoining fields
- Family bathroom comprising a panel bath with electric shower over, wash hand basin and WC.
- Enclosed rear garden with patio terrace, lawned garden, pedestrian side access and further seating area to the rear.



GROUND FLOOR

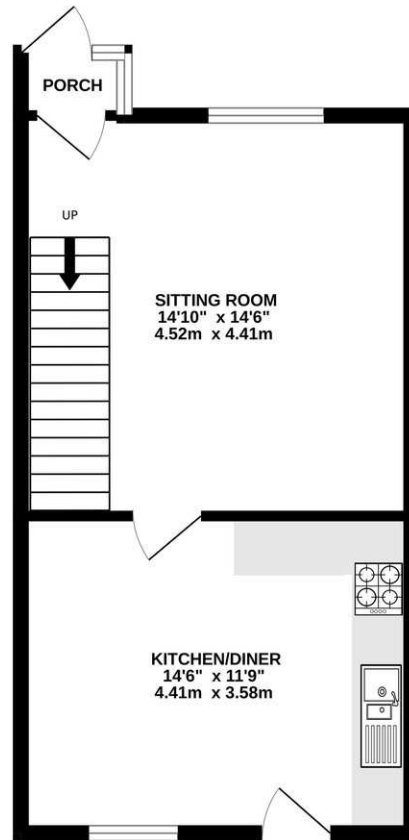

1ST FLOOR

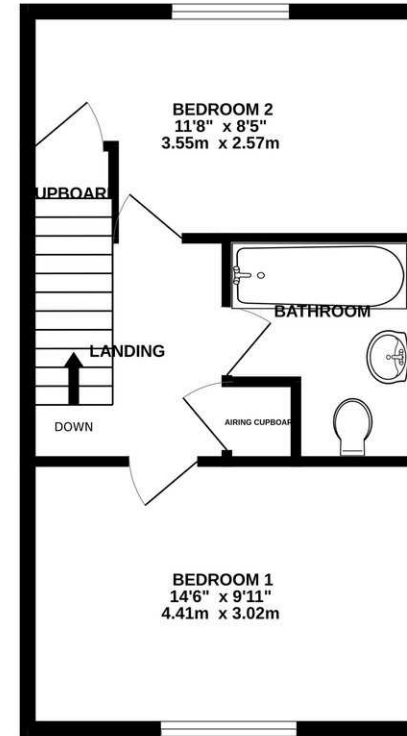

Whilst every attempt has been made to ensure the accuracy of the floorplan contained here, measurements of doors, windows, rooms and any other items are approximate and no responsibility is taken for any error, omission or mis-statement. This plan is for illustrative purposes only and should be used as such by any prospective purchaser. The services, systems and appliances shown have not been tested and no guarantee as to their operability or efficiency can be given.
Made with Metrepix ©2026

DISCLAIMER

CONSUMER PROTECTION FROM UNFAIR TRADING REGULATIONS 2008. The Agent has not tested any apparatus, equipment, fixtures and fittings or services and so cannot verify that they are in working order or fit for the purpose. A Buyer is advised to obtain verification from their Solicitor or Surveyor. References to the Tenure of a Property are based on information supplied by the Seller. The Agent has not had sight of the

title documents. A Buyer is advised to obtain verification from their Solicitor. Items shown in photographs are not included unless specifically mentioned within the sales particulars. They may however be available by separate negotiation. Buyers must check the availability of any property and make an appointment to view before embarking on any journey to see a property.

DATA PROTECTION. Personal information provided by customers wishing to receive information and/or services from the estate agent and the Property Sharing Experts (of which it is a member) for the purpose of providing services associated with the business of an estate agent but specifically excluding mailing or promotions by a third party. If you do not wish your personal information to be used for any of these purposes, please notify us.