



## 17 George Road

, Fleet, GU51 3PS

£575,000

Nicholsons Estate Agents welcome to the market this four bedroom detached family home set within a cul-de-sac road and within walking distance to local school's, Oakley Park playing fields, Fleet High Street & Mainline station. The property offers living room, dining room, kitchen, cloakroom, refitted family bathroom, private garden, garage and driveway parking for multiple vehicles.

- Four Bedrooms
- Detached Family Home
- Cul-De-Sac Road
- Stones Throw From Oakley Park Playing Fields
- Walking Distance To Fleet High Street & Mainline Station
- Private Rear Garden With Summer House (With Power & Light)
- Garage With Power & Driveway Parking For Multiple Vehicles
- Refitted Family Bathroom
- Kitchen With Larder Cupboard
- Walking Distance To Local Catchment School's

### Viewing

Please contact our Fleet Office on 01252 628400 if you wish to arrange a viewing appointment for this property or require further information.



## Floor Plan

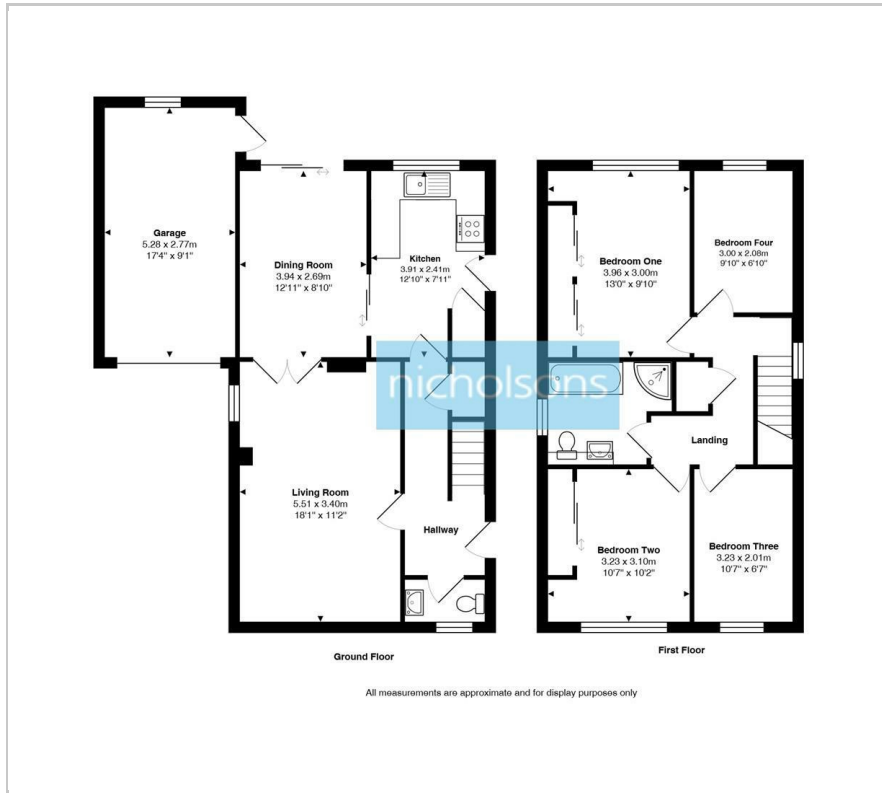

## Area Map



## Energy Efficiency Graph

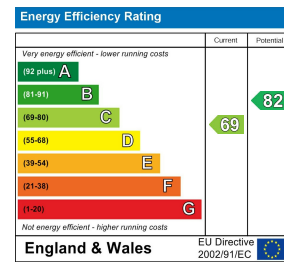

These particulars, whilst believed to be accurate are set out as a general outline only for guidance and do not constitute any part of an offer or contract. Intending purchasers should not rely on them as statements of representation of fact, but must satisfy themselves by inspection or otherwise as to their accuracy. No person in this firm's employment has the authority to make or give any representation or warranty in respect of the property.