



## Wellmeadow Road, W7

£1,600 Per calendar month

Spacious one-bedroom ground-floor apartment with wooden floors in a purpose-built development. Features a secure video entry system and is conveniently located close to local amenities. Ideal for comfortable and modern living.

Wellmeadow Road is 120 yards from Boston Manor Station (Piccadilly Line). The property is also 1 mile from Brentford Station (South Western Railway) which will take you to Waterloo in 20 minutes.

### Features

- One Bedroom
- Ground Floor
- Video Entry System
- Purpose Built
- Wooden Floors
- Close to Local Amenities

# Wellmeadow Road, London, W7

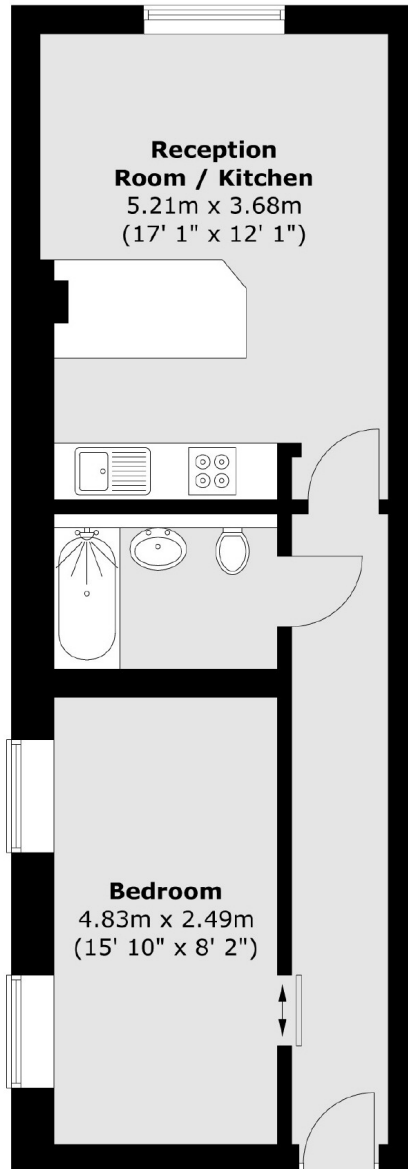

Total area (approx.) : 44.1 sq. m (475 sq. ft)