



Parritt Road, Redhill

£2,750 Per Month







Situated in the highly desirable residential area of Parritt Road, this beautifully presented four-bedroom end-of-terrace home offers contemporary living, generous accommodation, and an exceptional outdoor entertaining space, making it an ideal choice for growing families.

The heart of the home is the impressive open-plan ground floor, thoughtfully designed to create a bright and sociable living environment. The stylish kitchen features a central island, providing the perfect space for cooking, dining and entertaining, while seamlessly flowing into the living and dining areas. A convenient downstairs toilet completes the ground floor accommodation.

Large sliding doors span the rear of the property, flooding the living space with natural light and opening onto a beautifully landscaped, south facing garden. Finished with premium artificial lawn, an attractive decking area and a pergola, the garden provides the perfect setting for outdoor dining, entertaining guests or simply relaxing throughout the year.

Upstairs, the property boasts four generously proportioned bedrooms, all offering excellent space and versatility. Two of the bedrooms benefit from their own contemporary en-suite shower rooms, while the remaining bedrooms are served by a modern family bathroom, making this home perfectly suited to busy family life.

As an end-of-terrace property, the home enjoys additional privacy and a greater sense of space, whilst being ideally located within easy reach of Redhill town centre. Residents benefit from an excellent selection of shops, cafés, restaurants and leisure facilities, as well as highly regarded local schools. Redhill railway station is within easy reach, offering regular services to London Bridge, London Victoria and Gatwick Airport, making the property an excellent option for commuters. The area also enjoys an abundance of nearby parks, countryside walks and recreational facilities, providing the perfect balance between town and country

Need to know

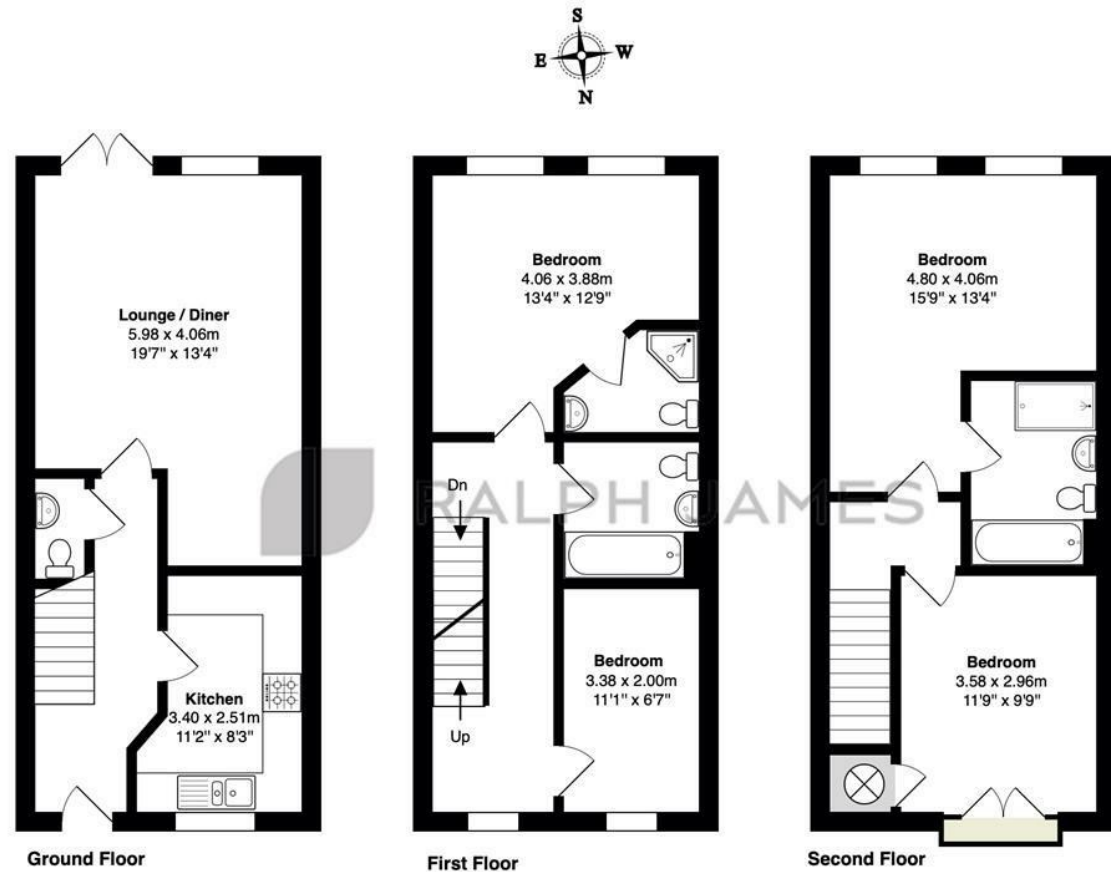

Parritt Road, Redhill

Total Area: 117.9 m² ... 1269 ft² (excluding balcony, garden, garage)

FOR ILLUSTRATIVE PURPOSES ONLY.

Whilst every attempt has been made to ensure the accuracy of the floor plan shown, all measurements, positioning, fixtures, features, fittings and any other data shown are an approximate interpretation for illustrative purposes only and are not to scale.

No responsibility is taken for any error, omission, miss-statement or use of data shown.

The above statement applies to both 'Still Moving London LTD' and the Company or individual displaying this floor plan.

Unauthorised reproduction prohibited.

© Still Moving London LTD (www.stillmoving.london)



Interested?

redhill@ralphjames.co.uk
01737 765 555

1

ralphjames.co.uk