



**Tibbats Close, Birmingham B32 3TE**

**welcome to**

## **Tibbats Close, Birmingham**

\*\*\*THREE-BEDROOM FAMILY HOME\*\*\*DRIVEWAY AND GARAGE\*\*\*MODERN FITTED KITCHEN\*\*\*PRIVATE ENCLOSED REAR GARDEN\*\*\*DOWNSTAIRS CLOAKROOM\*\*\*NEW ROOF COMPLETED 2025\*\*\*NEAR TO LOCAL SCHOOLS, AMENITIES AND TRANSPORT LINKS\*\*\*PERFECT FOR FIRST TIME BUYERS\*\*\*

### **Agent Note**

This property is council tax band A.

### **Entrance Hall**

Stairs to first floor, doors to lounge, kitchen & w/c.

### **Downstairs W/C**

Low level flush w/c, wash hand basin.

### **Lounge**

15' 7" x 10' 2" ( 4.75m x 3.10m )

Double glazed large window to front, ceiling light connection, carpet.

### **Kitchen**

16' 1" x 9' 10" ( 4.90m x 3.00m )

Double glazed window & door to rear, lino flooring, ceiling spotlights, range of wall & base units with drawers and worktops over, integrated oven, grill & hob with extractor over, space for washing machine, sink & drainer with mixer tap, integrated fridge & freezer.

### **Landing**

Door to all three bedrooms & bathroom, ceiling light connection, carpet.

### **Bedroom 1**

13' excluding cupboard. x 9' 9" ( 3.96m excluding cupboard. x 2.97m )

Double glazed window to front, built in cupboard, ceiling light connection, carpet.

### **Bedroom 2**

9' 9" excluding cupboard. x 6' 11" ( 2.97m excluding cupboard. x 2.11m )

Double glazed window to rear, built in cupboard, ceiling light connection, carpet.

### **Bedroom 3**

6' 11" x 6' 2" ( 2.11m x 1.88m )

Double glazed window to rear, built in cupboard, ceiling light connection, carpet.

### **Bathroom**

9' 2" including cupboard. x 5' 11" ( 2.79m including cupboard. x 1.80m )

Double glazed frosted window, fully tiled, built in cupboard, shower cubical with glass doors, wash hand basin with mixer tap & mirrored unit above, low level flush w/c, heated towel rail.

### **Front Garden**

Paved and gravel, driveway & garage to side.

### **Rear Garden**

Mainly laid to lawn, decked patio area, fencing surrounds garden, stone/gravel area for potted plants, brick- built storage/shed.

### **Parking**

Driveway & garage.

### **Garage**

15' 9" x 8' 2" ( 4.80m x 2.49m )

Up and over door to front, door to rear.





***view this property online*** [shipways.co.uk/Property/HBN112174](http://shipways.co.uk/Property/HBN112174)



welcome to

## Tibbats Close, Birmingham

- Three Bedroom Family Home in Quinton
- Driveway Parking and Garage
- Cul-de-sac Location
- New Roof Completed in 2025
- Modern Kitchen with Appliances

Tenure: Freehold EPC Rating: D  
Council Tax Band: A

offers over

**£225,000**

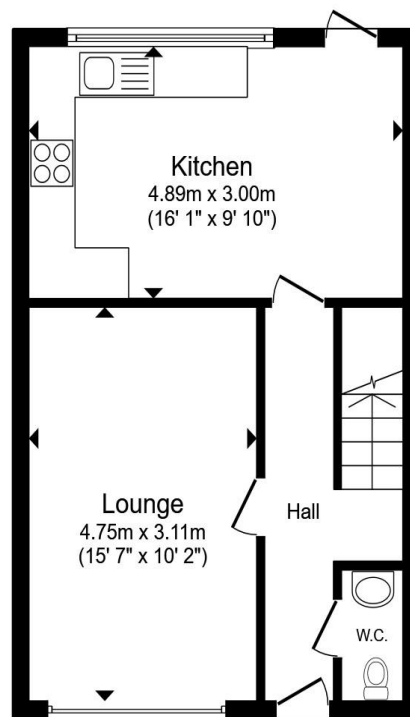

**Ground Floor**

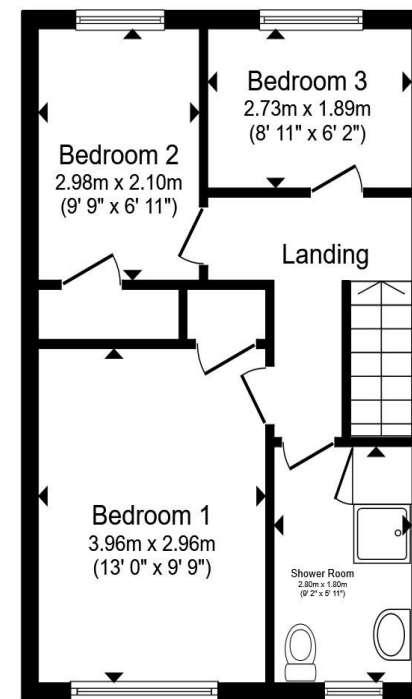

**First Floor**

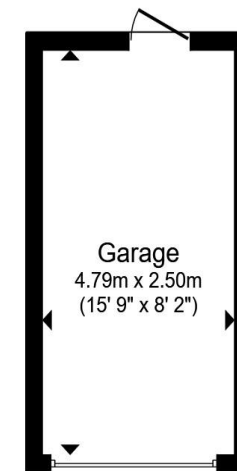

**Garage**

Total floor area 87.2 m<sup>2</sup> (938 sq.ft.) approx

This floor plan is for illustrative purposes only. It is not drawn to scale. Any measurements, floor areas (including any total floor area), openings and orientation are approximate. No details are guaranteed, they cannot be relied upon for any purpose and they do not form part of any agreement. No liability is taken for any error, omission or misstatement. A party must rely upon its own inspection(s). Powered by [www.propertybox.io](http://www.propertybox.io)



**view this property online** [shipways.co.uk/Property/HBN112174](http://shipways.co.uk/Property/HBN112174)



Property Ref:  
HBN112174 - 0003

1. MONEY LAUNDERING REGULATIONS Intending purchasers will be asked to produce identification documentation at a later stage and we would ask for your co-operation in order that there is no delay in agreeing the sale. 2. These particulars do not constitute part or all of an offer or contract. 3. The measurements indicated are supplied for guidance only and as such must be considered incorrect. Potential buyers are advised to recheck measurements before committing to any expense. 4. We have not tested any apparatus, equipment, fixtures or services and it is in the buyers interest to check the working condition of any appliances. 5. Where an EPC, or a Home Report (Scotland only) is held for this property, it is available for inspection at the branch by appointment. If you require a printed version of a Home Report, you will need to pay a reasonable production charge reflecting printing and other costs. 6. We are not able to offer an opinion either written or verbal on the content of these reports and this must be obtained from your legal representative. 7. Whilst we take care in preparing these reports, a buyer should ensure that his/her legal representative confirms as soon as possible all matters relating to title including the extent and boundaries of the property and other important matters before exchange of contracts.

Shipways is a trading name of Sequence (UK) Limited which is registered in England and Wales under company number 4268443, Registered Office is Cumbria House, 16-20 Hockliffe Street, Leighton Buzzard, Bedfordshire, LU7 1GN. VAT Registration Number is 500 2481 05.



**0121 427 3264**



[harborne@shipways.co.uk](mailto:harborne@shipways.co.uk)



172 High Street, Harborne, BIRMINGHAM,  
West Midlands, B17 9PP



[shipways.co.uk](http://shipways.co.uk)