



Connells

Springhill Road
Grendon Underwood Aylesbury

Property Description

Connells are delighted to present this three double bedroom semi-detached home, tucked away within a private road development just outside the highly sought-after village of Grendon Underwood, and within the Waddesdon School catchment area.

Offering generous living space throughout, the property is ideal for families or anyone looking for a quieter countryside setting with excellent room sizes.

The ground floor features a spacious living room centred around a charming log burner fireplace, creating a warm and welcoming atmosphere. To the rear, there is a bright kitchen diner with plenty of space for both cooking and entertaining, along with the added benefit of a conservatory overlooking the garden.

Upstairs, the property offers three double bedrooms and a family bathroom fitted with both a bath and separate shower cubicle.

Outside, the home enjoys a spacious rear garden, perfect for outdoor dining or family use, while the front garden includes a private driveway providing off-road parking.



Entrance Hall

Carpet, access to living room, kitchen diner, stairs

Living Room

Carpet, log burner with brick fireplace surround, window to front of property

Kitchen Diner

Tiled floor, wall and base units, range cooker, space for washing machine, dishwasher, fridge freezer, ceiling fan, double doors to conservatory, stable door to rear garden

Conservatory

Laminate flooring

Landing

Carpet, access to bedrooms and bathroom, built in airing cupboard and loft access point

Bedroom One

Double bedroom, carpet, built in storage, window to front of property

Bedroom Two

Double bedroom, carpet, ceiling fan, window to front of property

Bedroom Three

Double bedroom, carpet, ceiling fan, window to rear of property

Bathroom

Carpet, tiled walls, bath, shower cubicle, wc, basin, towel rail, window to rear of property





Ground Floor

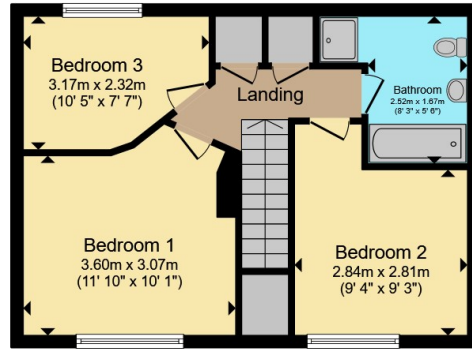

First Floor

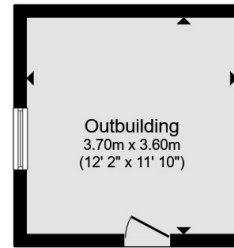

Outbuilding



Total floor area 107.1 m² (1,153 sq.ft.) approx

This floor plan is for illustrative purposes only. It is not drawn to scale. Any measurements, floor areas (including any total floor area), openings and orientation are approximate. No details are guaranteed, they cannot be relied upon for any purpose and they do not form part of any agreement. No liability is taken for any error, omission or misstatement. A party must rely upon its own inspection(s). Powered by www.propertybox.io

Connells

To view this property please contact Connells on

T 01869 244761

E bicester@connells.co.uk

5 Market Square
BICESTER OX26 6AA

EPC Rating: D Council Tax
Band: B

Tenure: Freehold

view this property online connells.co.uk/Property/BIC309749



1. MONEY LAUNDERING REGULATIONS Intending purchasers will be asked to produce identification documentation at a later stage and we would ask for your co-operation in order that there will be no delay in agreeing the sale. 2. These particulars do not constitute part or all of an offer or contract. 3. The measurements indicated are supplied for guidance only and as such must be considered incorrect. Potential buyers are advised to recheck measurements before committing to any expense. 4. We have not tested any apparatus, equipment, fixtures, fittings or services and it is in the buyers interest to check the working condition of any appliances.

Connells Residential is registered in England and Wales under company number 1489613, Registered Office is Cumbria House, 16-20 Hockliffe Street, Leighton Buzzard, Bedfordshire, LU7 1GN. VAT Registration Number is 500 2481 05.

See all our properties at www.connells.co.uk | www.rightmove.co.uk | www.zoopla.co.uk

Property Ref: BIC309749 - 0004