



## 19 SKIMMER CLOSE NORTHAMPTON, NN4 9FD

**£175,000**  
**FREEHOLD**

Stonhills are pleased to offer this two double bedroom shared ownership home located in the popular Pineham area of Northampton. The accommodation includes a lounge, kitchen/dining room and downstairs WC, with two double bedrooms and a bathroom to the first floor. The property also benefits from a rear garden and allocated parking. The property is available on a 70% shared ownership basis for £182,000 with Orbit Homes retaining a 30% share. Current rent payable on the remaining share is £247 per month.

  
stonhills  
LAND & ESTATE AGENTS

GROUND FLOOR  
364 sq.ft. (33.8 sq.m.) approx.

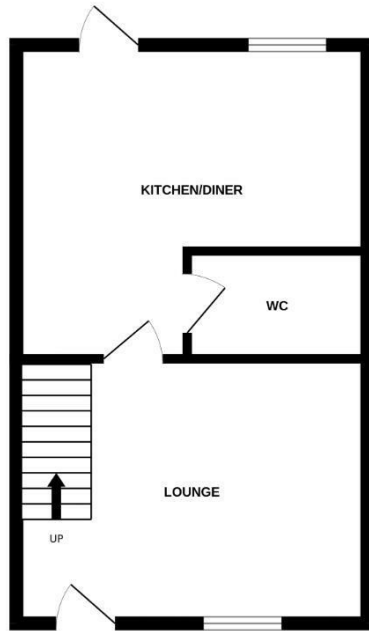

1ST FLOOR  
364 sq.ft. (33.8 sq.m.) approx.

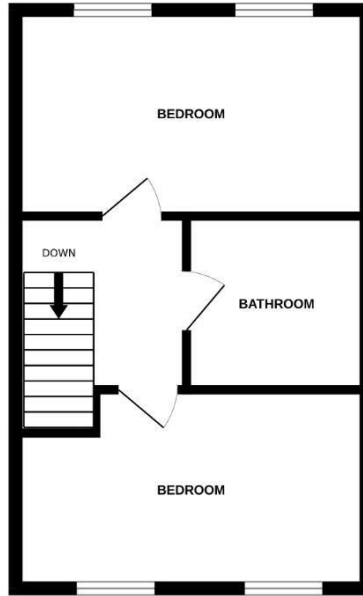

TOTAL FLOOR AREA: 727 sq.ft. (67.6 sq.m.) approx.

Whilst every attempt has been made to ensure the accuracy of the floorplan contained here, measurements of doors, windows, rooms and any other items are approximate and no responsibility is taken for any error, omission or mis-statement. This plan is for illustrative purposes only and should be used as such by any prospective purchaser. The services, systems and appliances shown have not been tested and no guarantee as to their operability or efficiency can be given.  
Made with Metropix ©2026



Energy Efficiency Rating		Current	Potential
Very energy efficient - lower running costs			
(92 plus) A			
(81-91) B		82	
(69-80) C			
(55-68) D			
(39-54) E			
(21-38) F			
(1-20) G			
Not energy efficient - higher running costs			
<b>England &amp; Wales</b>		EU Directive 2002/91/EC	

Agents Note: Whilst every care has been taken to prepare these particulars, they are for guidance purposes only. All measurements are approximate and are for general guidance purposes only and whilst every care has been taken to ensure their accuracy, they should not be relied upon and potential buyers/tenants are advised to recheck the measurements

Northampton Office Sales  
39 St Giles Street  
Northampton  
Northamptonshire  
NN1 1JF

01604 624424  
lewis@stonhills.co.uk  
<https://www.stonhills.co.uk/>

