



LAITWOOD ROAD, SW12

£1,850 PCM

- First floor flat
- Modern kitchen
- Two double bedrooms
- Private garden
- Close to station
- Energy rating: C





ABOUT THE HOME

A beautifully presented two double bedroom Victorian garden flat with a spacious reception room and a modern kitchen. Also the property benefits from a private garden. This property would be suitable for professional sharers.

Located on Laitwood Road in Balham, the property is just moments away from amenities including popular restaurants and bars as well as the supermarkets and other local shops. Balham mainline & underground stations are located nearby, providing excellent transport links into the city via the Northern line.





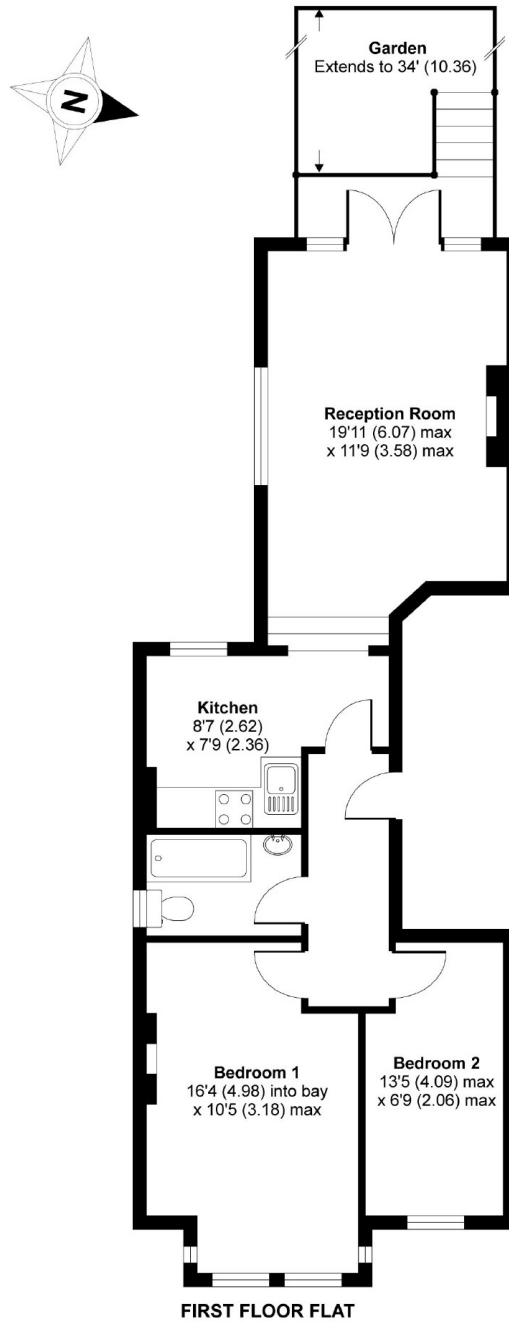

APPROX. GROSS INTERNAL FLOOR AREA 647 SQFT / 60.1 SQM

Laitwood Road, Balham SW12

Copyright nichecom.co.uk 2009 Produced for Jacksons the Independent Estate Agents REF : LE090893

JACKSONS BALHAM

8-11 Balham Station Road,
London, SW12 9SG
Sales: 020 8675 6555
Lettings: 020 8675 6565

Energy Rating: C We aim to make our particulars both accurate and reliable. However they are not guaranteed; nor do they form part of an offer or contract. If you require clarification on any points then please contact us, especially if you're traveling some distance to view. Please note that appliances and heating systems have not been tested and therefore no warranties can be given as to their good working order.