



**Keegan White**  
ESTATE AGENTS

101 Arnison Avenue | £415,000





## Features

- Semi-Detached Home
- Driveway Parking & Garage
- Guest Cloakroom / WC
- No Onward Chain
- Walk To Station
- West Facing Garden

The main front door opens into a wide entrance porch that has a secondary front door that leads into the house. The hallway has stairs rising to the first floor with an understairs storage cupboard and please note that the stairlift is being removed by the vendor. To the front is a well decorated sitting room which has been opened up to the dining room at the rear that has patio doors leading out to the garden. Adjacent to this is the kitchen with a window to side aspect and a back door. It has a decent range of base and eye level storage units and all the appliances can be included in the sale.

Completing the ground floor is the guest cloakroom that has a WC, handbasin and window to side aspect. To the first floor landing there is a window to side aspect and a loft hatch giving access to the loft. The three bedrooms are well proportioned, and there is a separate WC that is adjacent to the modern shower room that has a window to rear. Externally, there is a lawn, gardens and driveway parking to the front, with gated side access to the garage and the back garden, which comprises of a patio, lawn, a variety of shrubs, and fencing to borders.





Located to the north of High Wycombe's town centre, the house is conveniently located for the Royal Grammar School and has an array of local shopping stores in close proximity. For out door enthusiasts, there is open countryside within a few minutes walk. High Wycombe has wide range of retail shopping, leisure and hospitality outlets to suit everyone's needs, with the excellent Swan Theatre and the new sports centre at Handy Cross drawing people from far and wide. In this regard, the town has always been in high demand from people relocating here to take advantage of its excellent commuting

opportunities with the Chiltern Railway service to London Marylebone, as well as having Junctions 3 & 4 of the M40 on its doorstep. Schooling is another major factor with some outstanding primary schools and the highly regarded Wycombe High School for girls, the RGS (as mentioned) and John Hampden Grammar School for boys.

Additional Information:  
Council Tax: Band D.  
Energy Performance Rating: EPC C (74).







Approx Gross Internal Area  
107 sq m / 1148 sq ft

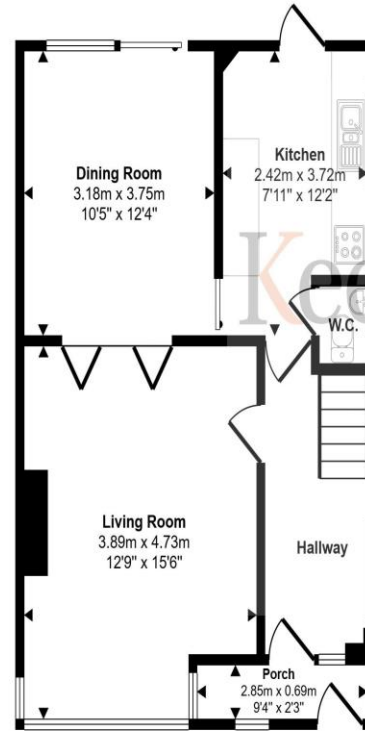

Ground Floor  
Approx 49 sq m / 531 sq ft

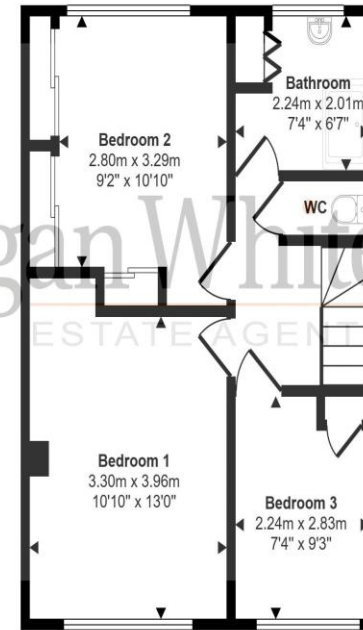

First Floor  
Approx 45 sq m / 483 sq ft

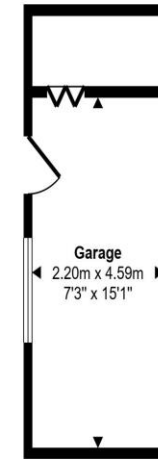

Storage Room  
Approx 12 sq m / 134 sq ft

This floorplan is only for illustrative purposes and is not to scale. Measurements of rooms, doors, windows, and any items are approximate and no responsibility is taken for any error, omission or mis-statement. Icons of items such as bathroom suites are representations only and may not look like the real items. Made with Made Snappy 360.

These particulars are not an offer or contract, nor part of one. You should not rely on statements by Keegan White Ltd. in the particulars or by word of mouth or in writing as being factually accurate about the property, its condition or its value. Keegan White Ltd. has no authority to make any representations about the property, and accordingly any information given is entirely without responsibility on the part of the agents, seller(s) or lessor(s). The photographs show only certain parts of the property as they appeared at the time they were taken. Areas, measurements and distances given are approximate only. Any reference to alterations to, or use of, any part of the property does not mean that any necessary planning, building regulations or other consent has been obtained. A buyer or lessee must find out by inspection or in other ways that these matters have been properly dealt with and that all information is correct. Keegan White Ltd. is a limited company registered in England & Wales with company number 9726292. Our registered office is 102-104 High Street, Great Missenden, Bucks, HP16 0BE

33-35 Crendon Street, High Wycombe, Buckinghamshire HP13 6LJ  
Tel: 01494 417007  
Email: wyc@keeganwhite.co.uk

keeganwhite.co.uk

**Keegan White**  
ESTATE AGENTS