



**37, Ladycroft Close, Radbrook, Shrewsbury, SY3 6BB**  
£800 Per Month



37, Ladycroft Close, Radbrook, Shrewsbury, SY3 6BB

**£800 Per Month**

Well Maintained Two Bedroom Semi Detached House in the Extremely Popular Location of Radbrook Green.  
Excellent Access to a Range of Local Amenities.

Available: 28/04/26

## Description

Living Room with Gas Fire, Kitchen including Oven, Hob and fridge/freezer, Spacious Conservatory. Stairs to Master Bedroom including Double Wardrobe, Further Bedroom, Bathroom including Shower, Loft Ladder to Partially Boarded Roof Space. Full Double Glazing, Gas Central Heating, Private & Well Maintained Rear Garden, Two Car Driveway. EPC D



Unfurnished

Council Tax Band: B

Available: 28th April 2026

EPC: D

## Floor Plans

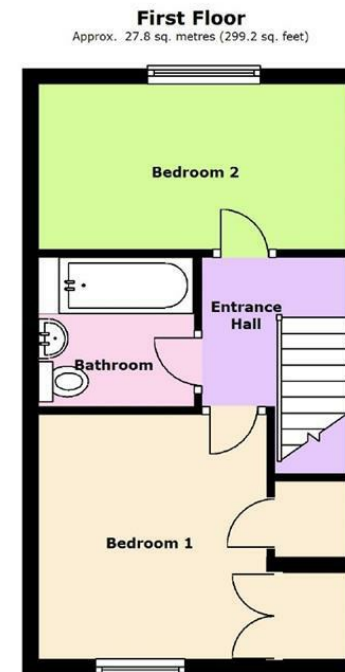
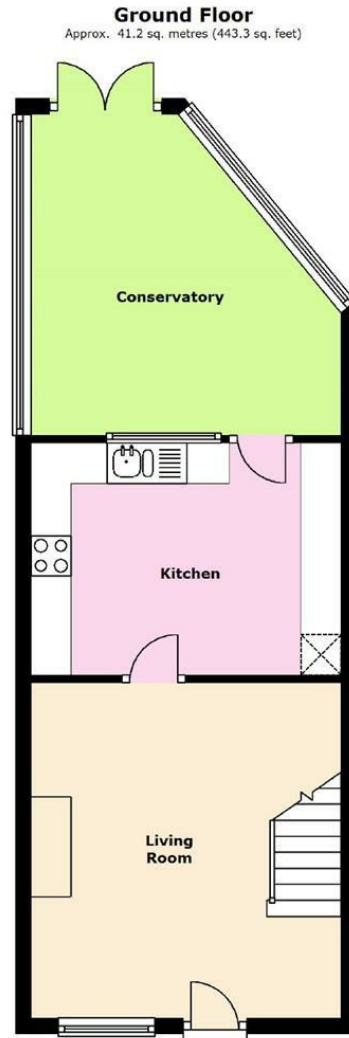

Total area: approx. 69.0 sq. metres (742.5 sq. feet)

We accept no responsibility for any mistake or inaccuracy contained within the floorplan. The floorplan is provided as a guide only and should be taken as an illustration only. The measurements, contents and positioning are approximations only and provided as a guidance tool and not an exact replication of the property.  
Plan produced using PlanUp.

These particulars, whilst believed to be accurate are set out as a general outline only for guidance and do not constitute any part of an offer or contract. Intending purchasers should not rely on them as statements of representation of fact, but must satisfy themselves by inspection or otherwise as to their accuracy. No person in this firm's employment has the authority to make or give any representation or warranty in respect of the property.