



Woodbourne Avenue, SW16

£1,550 PCM

An attractive two bed, two bath apartment which is ideal for two sharers. Offering a bright and spacious reception room, a modern fully fitted kitchen, two double bedrooms and two bathrooms.

- Two Double Bedrooms
- Two Bathrooms
- Victorian Conversion
- Close to Tooting Bec Common
- Close to Streatham High Road
- Part Furnished

For further information on the costs associated with renting a property, please pop into our office or visit our website.



Woodbourne Avenue is conveniently placed a few minutes walk from Tooting Common with both Balham and Streatham town centres easily accessible. Streatham Hill mainline station providing rail links to London Victoria via Clapham Junction and bus routes to the city are within easy reach.



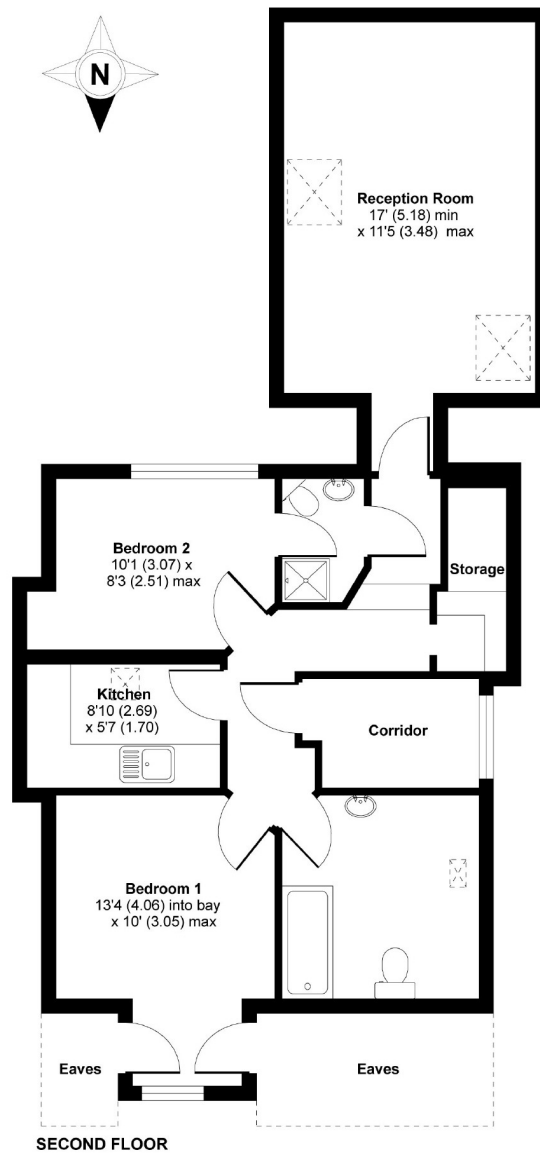

APPROX. GROSS INTERNAL FLOOR AREA 710 SQFT / 65.9 SQM

Woodbourne Avenue, London SW16

Copyright nichecom.co.uk 2009 Produced for Jacksons the Independent Estate Agents REF : LE094170

Jacksons Streatham
1-3 De Montfort Parade
Streatham High Road
Streatham
London
SW16 1BU

Energy Rating: D We aim to make our particulars both accurate and reliable. However they are not guaranteed; nor do they form part of an offer or contract. If you require clarification on any points then please contact us, especially if you're traveling some distance to view. Please note that appliances and heating systems have not been tested and therefore no warranties can be given as to their good working order.