

## Woodside, SW19

### £450,000

A refurbished, two double bedroom, ground floor apartment located within a beautiful 1930 art deco building. The property is sold with a share of freehold, beautiful communal gardens and no onward chain.

Woodside is a family orientated street, located between Wimbledon High Street and Village. The schools are exceptional, the district line, overground, bus routes and fantastic shops are all on your doorstep.

### Features

- Two Double Bedrooms
- Communal Gardens
- Parking Available
- Share Of Freehold
- Refurbished
- No Onward Chain

# Woodside, London, SW19

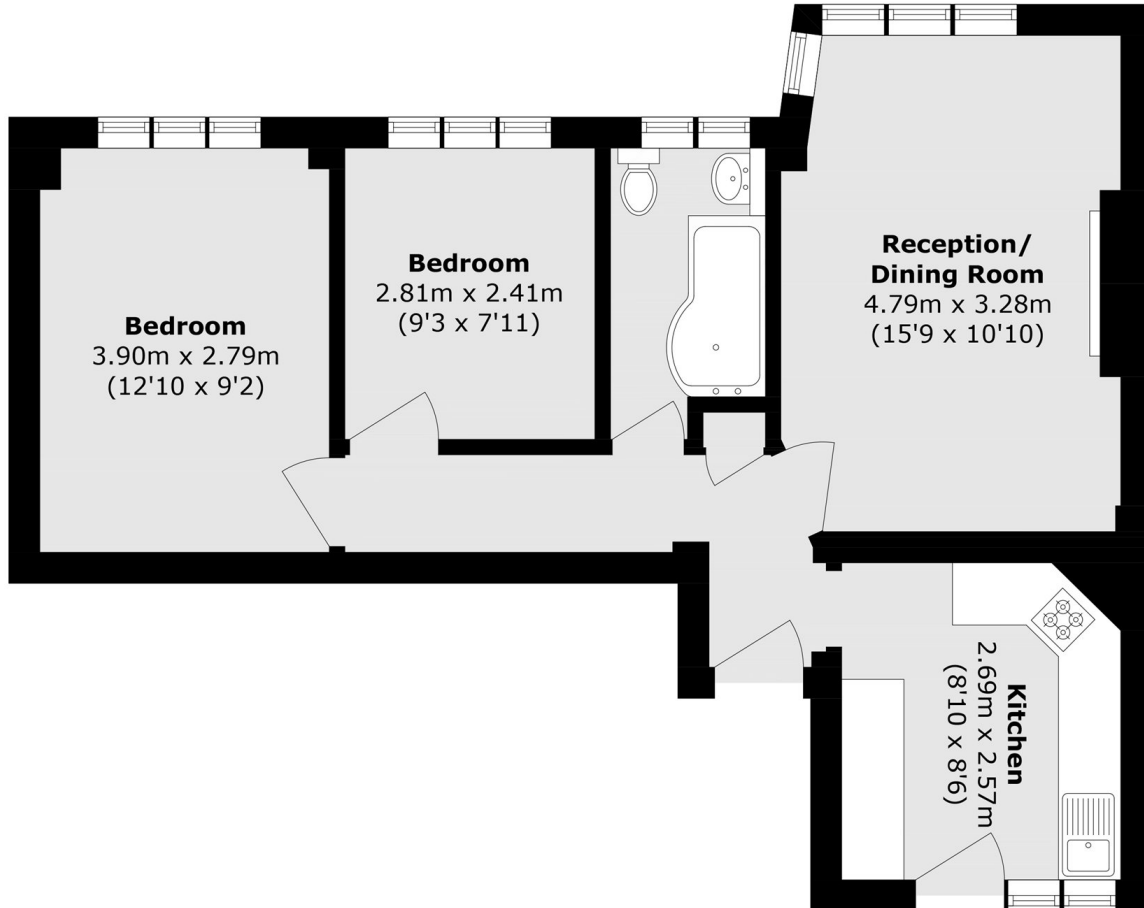

Total area (approx.): 53.8 sq. m (578.9 sq. ft)