

Symonds  
& Sampson

All  
routes

47 Icen Way  
Dorchester, Dorset

# 47 Icen Way

Dorchester, Dorset,  
Dorset, DT1 1EW

A charming Grade II Listed terraced townhouse with period features, modern interiors, three bedrooms, and a sunny low-maintenance garden with summer house.



- Grade II Listed
- Beautifully presented terraced townhouse
  - Period charm with modern finishes
  - Three well-proportioned bedrooms
- South-westerly facing, low-maintenance garden
  - No forward chain

Guide Price **£275,000**

Freehold

Dorchester Sales  
01305 261008  
dorchester@symondsandsampson.co.uk



## THE PROPERTY

This beautifully presented Grade II Listed terraced townhouse offers an attractive and thoughtfully arranged interior, combining charming period features with modern fittings throughout.

Upon entering, a small porch leads into the inviting sitting/dining room, featuring an exposed brick fireplace with a wood-burning stove. To the rear is the kitchen, fitted with a range of floor and wall units and providing space for freestanding appliances. A rear hall gives access to both the garden and the first floor.

On the first floor, there is a generous double bedroom with fitted storage, along with a tastefully appointed bathroom comprising a WC, wash hand basin, and a bath with mixer taps and shower over.

The second floor offers two further well-proportioned bedrooms.

## OUTSIDE

The pretty rear garden, partly walled and enjoying a south-westerly aspect, has been designed for easy maintenance. A patio adjoins the back of the house, leading to a stretch of lawn, bordered with flowers and shrubs, and a delightful summer house at the far end.

Residents parking scheme is available in the area.

## SITUATION

The County town provides a good range of shops, restaurants and leisure facilities. There are numerous sports clubs around the town including cricket, rugby, football, tennis and golf. There are many footpaths and bridleways across the beautiful surrounding countryside.

The Jurassic Coastline is a few miles to the south with some sandy beaches, outstanding walks and the opportunity to enjoy a number of water sports activities.

Nearby Brewery Square boasts a development with a variety of eateries, including Cote Brasserie, Wagamama, Zizzi, Pizza Express, Vivo Lounge, Nandos, Brewhouse & Kitchen and Costa. The square also includes a Premier Inn, an Odeon Cinema and multiple fashion retailers. The Dorset County Hospital is nearby.

Dorchester south and west train stations provide services to London Waterloo and Bristol Temple Meads respectively.

## DIRECTIONS

What3words///sake.hotspot.caused



# Icen Way, Dorchester

Approximate Area = 879 sq ft / 81.6 sq m  
 Limited Use Area(s) = 48 sq ft / 4.4 sq m  
 Outbuilding = 77 sq ft / 7.1 sq m  
 Total = 1004 sq ft / 93.1 sq m

For identification only - Not to scale



## SERVICES

Mains water, electric and gas are connected. Gas fired central heating.

Council Tax Band C. Dorset Council 01305 251010

There is mobile coverage in the area, please refer to Ofcom's website for more detail.

## MATERIAL INFORMATION

The property is situated in a Conservation Area. The property is Grade II Listed.

Residents on Street parking via permit is available in the area.

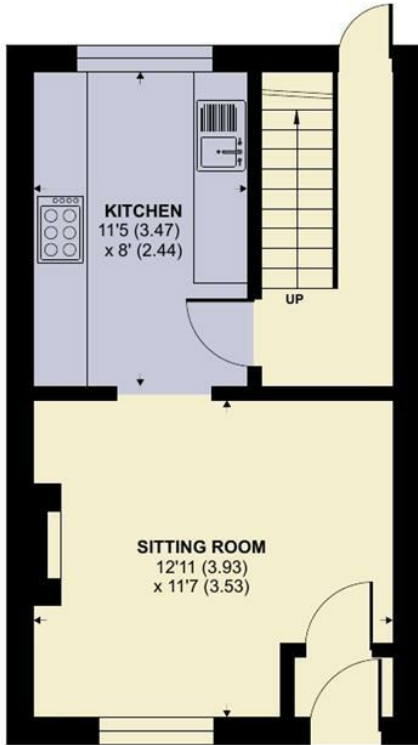

GROUND FLOOR



FIRST FLOOR



SECOND FLOOR

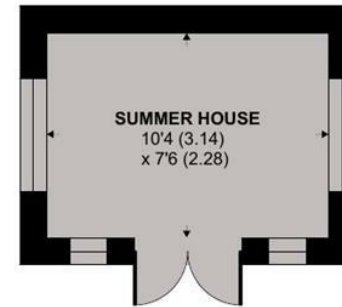

OUTBUILDING

Dorchester/ATR/06.05.2026 rev



Floor plan produced in accordance with RICS Property Measurement 2nd Edition, Incorporating International Property Measurement Standards (IPMS2 Residential). © nche.com 2025. Produced for Symonds & Sampson. REF: 1382346

01305 261008

dorchester@symondsandsampson.co.uk  
 Symonds & Sampson LLP  
 9 Weymouth Avenue, Brewery Square,  
 Dorchester, Dorset DT1 1QR



no authority to make or give any part of any offer or contract and must not be relied upon as statements or representations of fact. 2. Any areas, measurements or distances are approximate. The text, photographs and plans are for guidance only and are not necessarily comprehensive. It should not be assumed that the properties have all necessary planning, building regulation or other consents and Symonds and Sampson LLP have not tested any services, equipment or facilities. 3. We have not made any investigation into the existence or otherwise of any issues concerning pollution of the land, air or water contamination and the purchaser is responsible for making his/her own enquiries in this regard. 4. The property is sold subject to and with the benefit of all existing wayleaves, easements and rights of way whether public or private, specifically mentioned or not. The vendors shall not be required to define any such rights, privileges or advantages.

SALES | LETTINGS | AUCTIONS | FARMS & LAND | COMMERCIAL | NEW HOMES | PLANNING & DEVELOPMENT

