



17 South Road, Portsmouth

£240,000

 chinneckshaw



17 South Road

Portsmouth

Step inside this beautifully presented two-bedroom terraced house and discover a home that's ready to move straight into. The welcoming hallway leads to a bright, modern kitchen with ample storage and workspace, ideal for everyday living. The spacious living room provides a comfortable place to relax, while the adjoining sunroom fills the home with natural light and offers lovely views over the garden. Upstairs are two well-proportioned bedrooms, both with built-in wardrobes, along with a stylish modern bathroom finished to a high standard.

Outside, the property benefits from a delightful low-maintenance rear garden with the added advantage of rear access, making it both practical and enjoyable. Whether relaxing in the sunshine or entertaining friends, the outdoor space is easy to maintain and perfect for modern living.

Ideally located close to local amenities, schools and transport links, the property also benefits from allocated parking.

Material Information • Tenure: Freehold • Council Tax: Band B • Electricity: Mains Supply • Heating: Gas • Water Supply: Mains Supply • Sewage: Mains Supply • Broadband: Standard, Superfast and Ultrafast Fibre are all available in this area • Parking: Allocated Parking • Mobile: Ofcom official website checker states that EE, Vodafone, O2 and Three available in the area • Flood Risk: Low Risk





Ground Floor

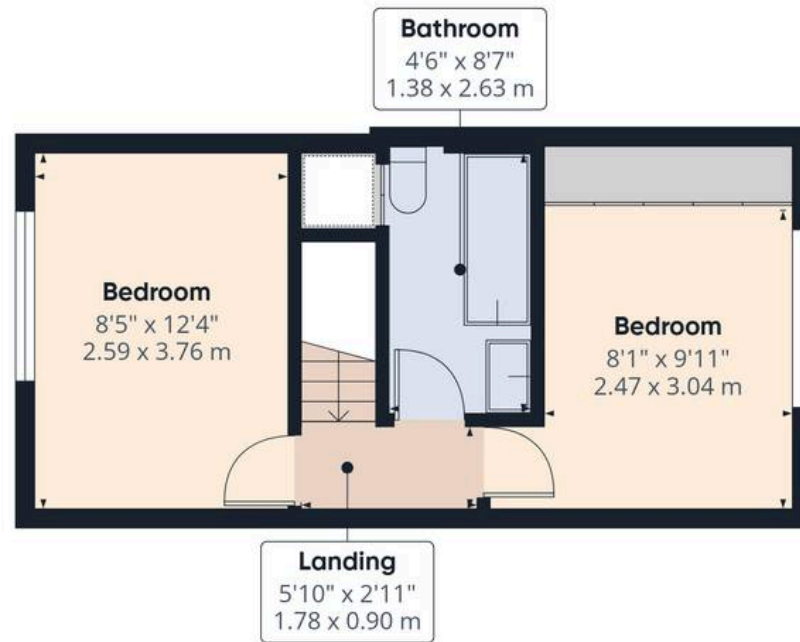

Floor 1



Approximate total area⁽¹⁾

664 ft²

61.7 m²

Reduced headroom

7 ft²

0.6 m²

(1) Excluding balconies and terraces

Reduced headroom

----- Below 5 ft/1.5 m

Calculations reference the RICS IPMS 3C standard. Measurements are approximate and not to scale. This floor plan is intended for illustration only.

GIRAFFE 360

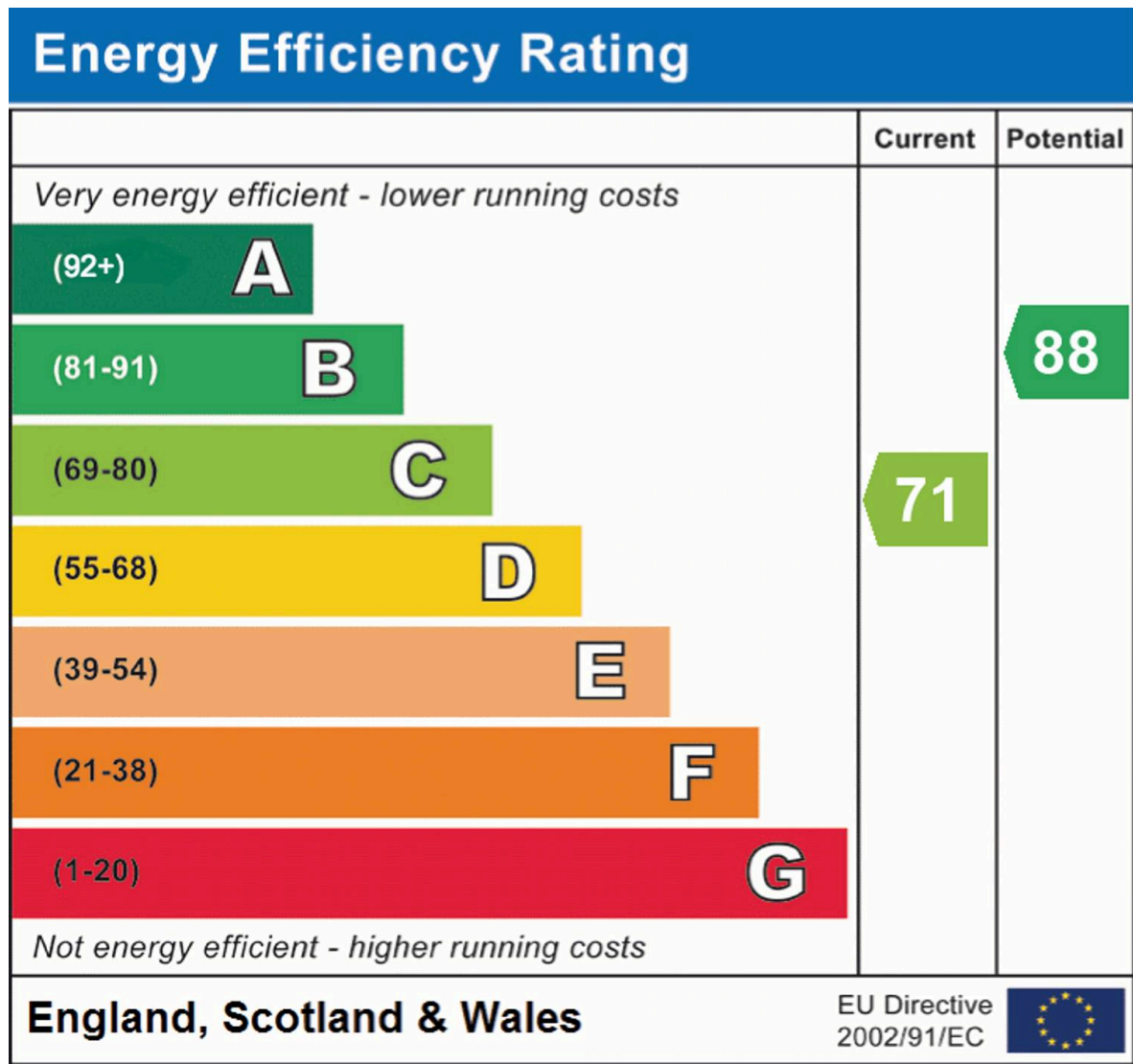

Chinneck Shaw

Bridge House, Milton Road, Portsmouth – PO3 6AN

023 9282 6731

hello@chinneckshaw.co.uk

www.chinneckshaw.co.uk/

Chinneck Shaw, Bridge House, Milton Road, PO3 6AN Consumer Protection from Unfair Trading Regulations 2008: These details are for guidance only and complete accuracy cannot be guaranteed. If there is any point which is of particular importance, verification should be obtained. They do not constitute a contract or part of a contract. All measurements are approximate. No guarantee can be given with regard to planning permissions or fitness for purpose. No apparatus, equipment, fixture or fitting has been tested. Items shown in the photographs are NOT necessarily included. Interested Parties are advised to check availability and make an appointment to view before travelling to see a property.