



Sheen Court, TW10

£2,200 Per calendar month

A larger than average two double bedroom apartment, ideal for a couple or a family. With a spacious living room, a bright kitchen, ample storage and beautiful communal gardens. **Rent includes heating and hot water**.

Sheen Court is a prestige gated development ideally positioned for Richmond and North Sheen Stations. With great transport links and close to the open space of Richmond Park.

Features

- Two Double Bedrooms
- Includes Heating & Hot Water
- Fantastic Location
- Spacious Apartment
- Beautifully Presented
- Ample Storage

Sheen Court, Richmond, TW10

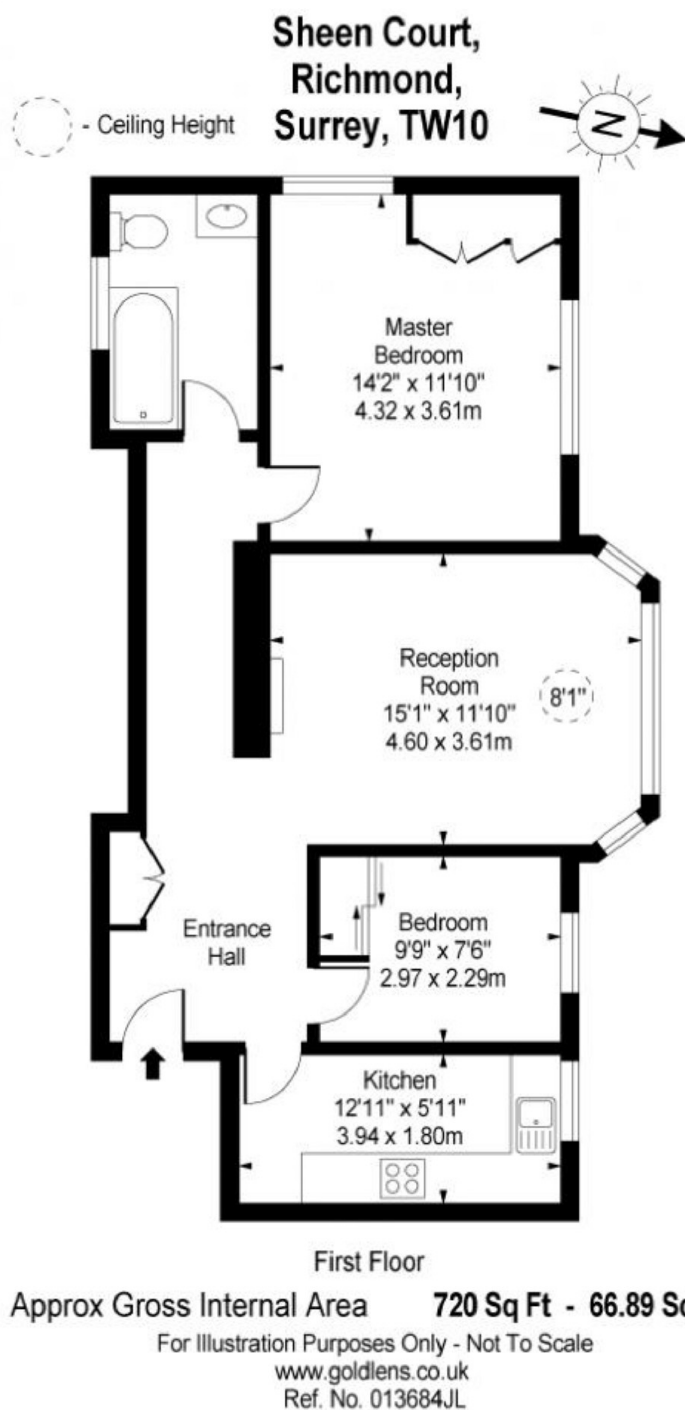

Dexters

Richmond
1 Sheen Road
Richmond
TW9 1AD
Lettings
020 8288 0828

Energy Rating: C. We aim to make our particulars both accurate and reliable. However they are not guaranteed; nor do they form part of an offer or contract. If you require clarification on any points then please contact us, especially if you're traveling some distance to view. Please note that appliances and heating systems have not been tested and therefore no warranties can be given as to their good working order.

 **RICS** | Regulated
Estate Agent
and Letting Agent

dexters.co.uk