

35 St. Davids Road, Cheadle, SK8 2HF

Offers Over £240,000

 2  1  1



If you're searching for a home with space to grow, this bay-fronted end quasi semi-detached house could be the perfect opportunity. Occupying a generous plot in a location popular with first-time buyers and young families, the property offers exciting potential to extend to the side or rear, subject to the necessary approvals, allowing buyers to create a home that evolves with their needs. The current accommodation includes a bright bay-fronted living room, a spacious fitted dining kitchen ideal for family life and a rear conservatory overlooking the garden. Upstairs are two well-proportioned bedrooms and a shower room/WC. Outside, the property benefits from a good size lawned rear garden, front garden, driveway parking and a detached garage to the side, offering excellent flexibility, outdoor space and superb long-term potential.

Key Features

- Bay fronted end quasi semi detached home
- Generous plot with extension potential
- Ideal first home or investment opportunity
- Front living room with bay window
- Large well fitted dining kitchen
- Rear conservatory (scope to replace)
- Two good size bedrooms
- Shower room/WC
- Good size lawned rear garden
- Driveway parking and detached garage

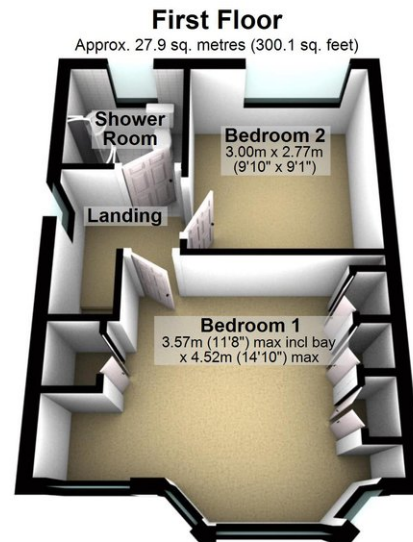
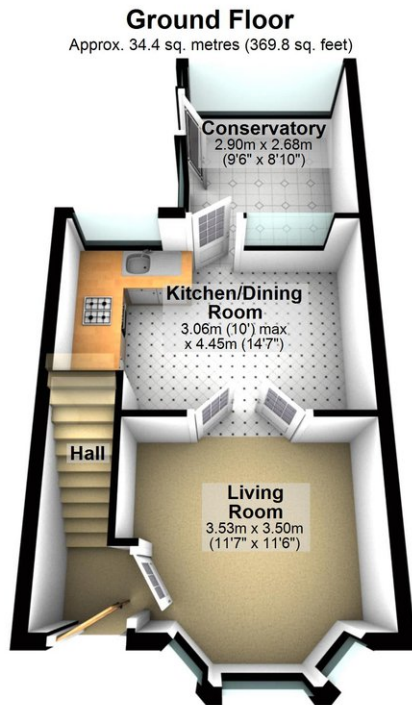

Total area: approx. 62.2 sq. metres (669.8 sq. feet)