



THE KEY TO YOUR NEXT MOVE

[www.keyestateagents.com](http://www.keyestateagents.com)

To Let

Tel: 024 7632 2022



**£975 Per Month**

54 Triumph Close, Coventry CV2 5AR



E-mail: [lettings@keyestateagents.com](mailto:lettings@keyestateagents.com)

KEY ESTATE AGENTS

Website: [www.keyestateagents.com](http://www.keyestateagents.com)



A newly redecorated two bedroom apartment ideally located on Triumph Close, within close proximity to Coventry City Centre and excellent transport links.

The property offers a spacious open-plan kitchen, dining and living area with a brand new modern kitchen with breakfast bar, new flooring throughout and freshly painted décor. There is also a newly fitted contemporary three piece bathroom and two generous double bedrooms.

Finished to a high standard and ready to move into. Early viewing recommended.

Holding Deposit £225  
Security Deposit £1125  
EPC C  
Council Tax Band A  
No Deposit Option Available

### Entrance



Enter from a communal hallway via a UPVC door into a hallway with doors leading to bedrooms, bathroom and living area.

### Kitchen 16'4" x 8'11" (5 x 2.73)



Newly Fitted kitchen with wall and base cabinets, gas hob and cooker, stainless steel sink and breakfast bar.

### Dining/Living Room 14'11" x 10'9" (4.551 x 3.3)



Large open plan kitchen, diner and living room with double aspect windows, fresh paint and new flooring.

### Bedroom One 14'9" x 10'7" (4.5 x 3.24)



Generous Double bedroom with double aspect windows letting in ample light.

### Bedroom Two 9'0" x 11'5" (2.75 x 3.48)



Spacious Double bedroom with front aspect window.

### Bathroom 5'10" x 7'3" (1.78 x 2.21)



Fully tiled with new three piece bathroom suite, with low level W/C, bath with overhead shower and basin.

### Agents Notes

Floor plans are for identification purposes only and not to scale. All room measurements in these lettings details are approximate and are usually stated in respect to the furthest point in the room. Subjective comments in these details are the opinion of KEY Estate Agents at the time these details were prepared, these opinions may vary from your own. Photos, floorplans and videos used within these details are under copyright to KEY Estate Agents and under no circumstances are to be reproduced by a third party without prior permission.

## Floor Plan

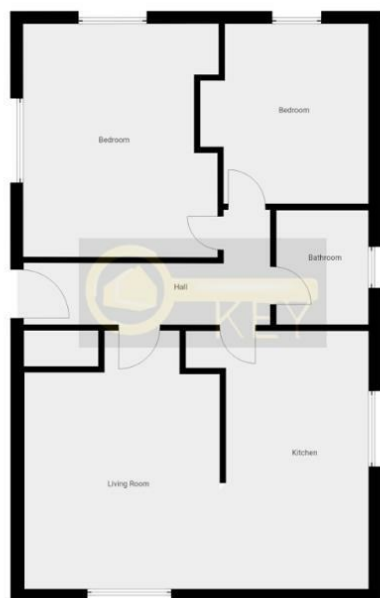

## Area Map

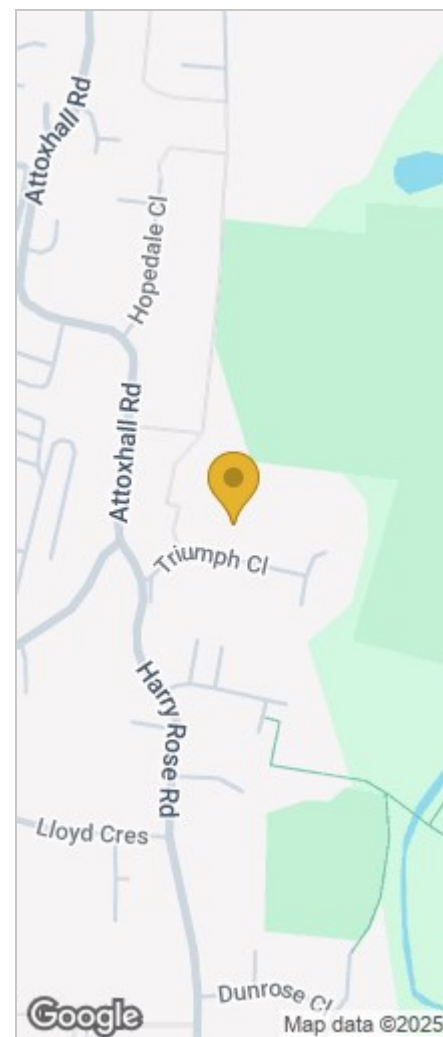

## Energy Efficiency Graph

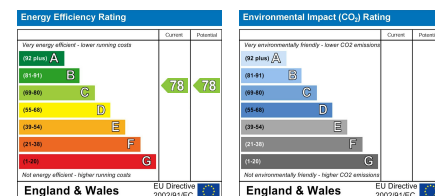

## HAVE YOU GOT A PROPERTY TO SELL OR LET?

KEY Estate Agents offer a complete and professional service to Home Owners and Landlords throughout the **Nuneaton**, **Bedworth** and **Hinckley** and surrounding villages.

If you are thinking of selling or letting your home we would be delighted to offer you a **Free Valuation** with **No Obligation** whatsoever.

Please call us today for details on all of our services, along with information about our competitive fee structure.

**KEY Estate Agents**

**2 The Courtyard, Goldsmith Way, Eliot Business Park, Nuneaton CV10 7RJ**

**lettings@keyestateagents.com**



Zoopla.co.uk



rightmove



These particulars do not constitute an offer contract and have been prepared for guidance only, and must not be relied upon as statement of fact. Area measurements or distances are given as guidance only and are not precise. Boundaries are subject to verification. Appliances and fittings have not been tested. Floor plans are not drawn to scale. The inclusion of any fixtures and fittings are subject to the vendor's confirmation, subject to contract. Internal photographs may well show furnishings, fixtures and fittings which are not included in the sale.



024 7632 2022