



Seacon Tower

5 Hutchings Street, E14

Asking Price £325,000

Stunning one bedroom apartment to rent in Seacon Tower, E14, a modern riverside development just a short walk to Canary Wharf, with 24hr concierge, gym, jacuzzi, sauna and steam room on-site.

CHESTERTONS



Seacon Tower

5 Hutchings Street, E14

- Spectacular views of London and River Thames
- Spacious Open-plan Living Area
- Fully Fitted Kitchen
- One Double Bedrooms
- Generous Bathroom Suite
- Balcony with Expansive Views Across London
- Access to Gym and Concierge Services
- Proximity to Canary Wharf's Financial District



Stunning one bedroom apartment for sale in Seacon Tower, E14, a modern riverside development just a short walk to Canary Wharf, with 24hr concierge, gym, jacuzzi, sauna and steam room on-site. This fantastic apartment is south-west facing, offering an abundance of natural light throughout the day, and stunning uninterrupted views of the River Thames and the City beyond.

Seacon Tower boasts an exceptional location very close to Canary Wharf's business district, Jubilee Line station & subterranean shopping centre. The building possesses a satisfactory EWS1 form and the apartment is offered chain-free.

Excellent transport connections are available via Heron Quays DLR 0.7 mile, Canary Wharf London Underground (Jubilee Line Services) 0.7 mile away

Tenure: Leasehold 974 years approx. remaining

Service Charge: £4,033 pa approx.

Ground Rent: £770 pa Reviewed every 21 years in line with building value.

Local Authority: Tower Hamlets

Council Tax Band: E

Score	Energy rating	Current	Potential
92+	A		
81-91	B		
69-80	C	79 C	82 B
55-68	D		
39-54	E		
21-38	F		
1-20	G		

Chestertons Canary Wharf & Greenwich Sales

Harbour Island
 28 Harbour Exchange Square
 London
 E14 9GE
canarywharf@chestertons.co.uk
 020 7510 8300
chestertons.co.uk

Seacon Tower, Hutchings Street, E14

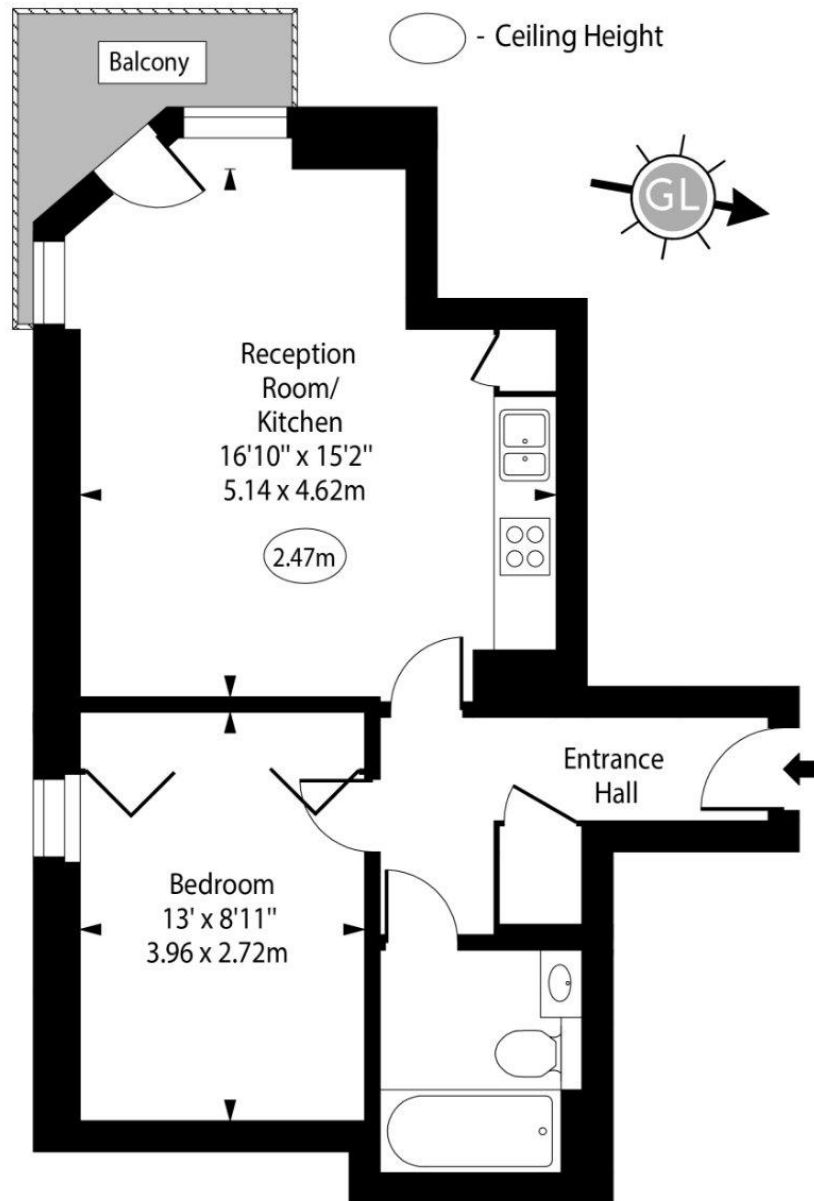

Second Floor

Approx Gross Internal Area 476 Sq Ft - 44.22 Sq M

For Illustration Purposes Only - Not To Scale

www.goldlens.co.uk

Ref. No. 021203.1MS

