

Living
made
better

Hoola Apartments
Royal Victoria Dock, E16 1UP



Asking Price £550,000

Hoola Apartments, Royal Victoria Dock, E16 1UP

Madison Brook

Property Summary

This two-bedroom apartment, located on the seventh floor of the sought-after Hoola Apartments, offers approximately 911 sq. ft. of internal living space. The property features a spacious open-plan living area with an integrated kitchen, a principal bedroom with an en-suite bathroom, a well-proportioned second bedroom, a contemporary three-piece family bathroom, and a separate balcony. Both bedrooms and the living room benefit from access to a wrap-around balcony overlooking the dock, providing excellent natural light throughout. Perfectly positioned, the apartment is just moments from Royal Victoria Station (DLR), Canning Town Station (Jubilee Line & DLR), and Custom House Station (Elizabeth Line).

Service charge: £4,500 pa | Ground rent: £450 pa | Lease: 989 years remaining

Floorplan

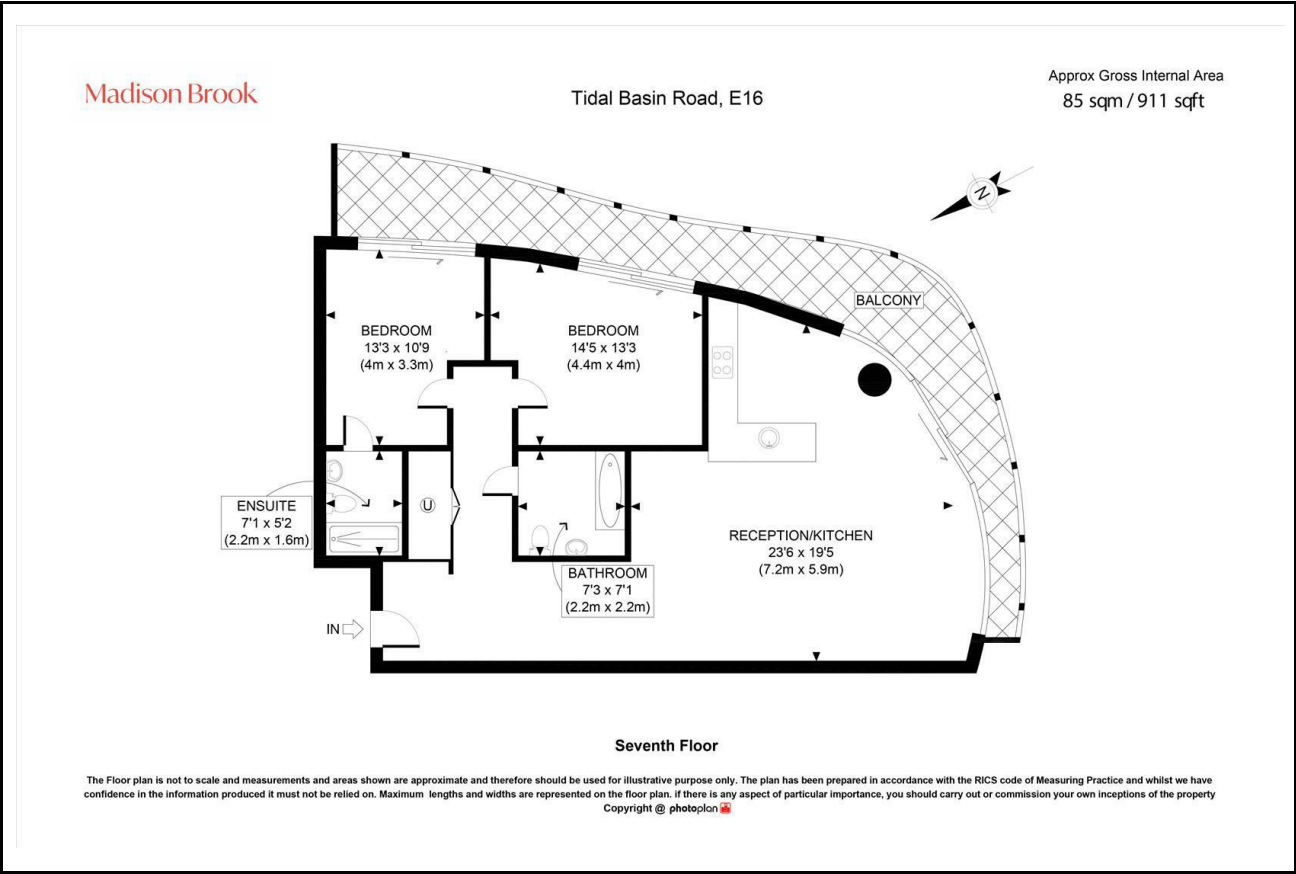

These particulars, whilst believed to be accurate are set out as a general outline only for guidance and do not constitute any part of an offer or contract. Intending purchasers should not rely on them as statements of representation of fact, but must satisfy themselves by inspection or otherwise as to their accuracy. No person in this firm's employment has the authority to make or give any representation or warranty in respect of the property.

Area Map

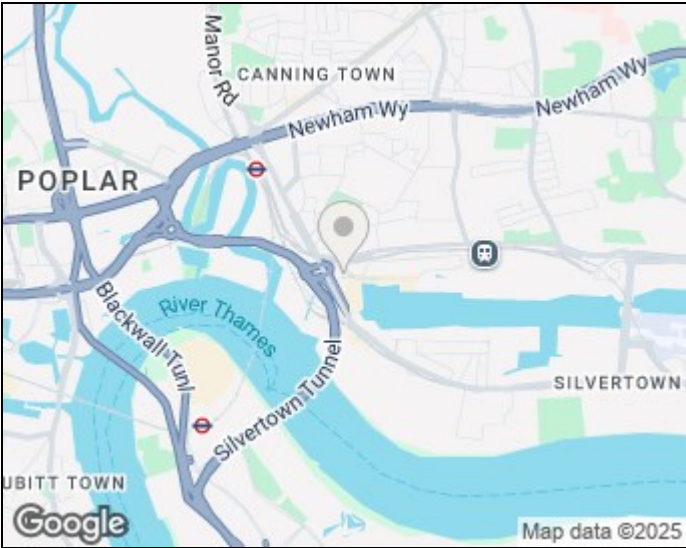

Energy Efficiency Graph

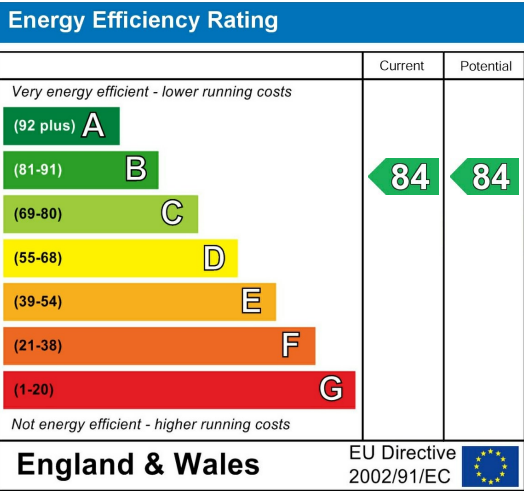

Unit B 20 Western Gateway, Royal Victoria
Dock, London, E16 1BS
Tel: 020 3946 6000 Email:
docklands@madisonbrook.com
<https://madisonbrook.com/>