



17 Otters Court, Witney OX28 1GJ

Draft details - may be subject to alterations.

A large 1 bedroom ground floor retirement apartment in an appealing position within this sought after McCarthy and Stone retirement development, situated close to the town centre shops and amenities. The accommodation includes an entrance hall a good size living room with french doors to a sunny aspect patio, a kitchen (with space for a washing machine), a bedroom and shower room plus double glazing and electric heating. There is the benefit of a lift to all floors and parking available. There is a minimum age of 60 for one occupier. Some images show Otters Court generically.

THOMAS
MERRIFIELD

SALES LETTINGS

e. witney@thomasmerrifield.co.uk

t. 01993 772000

Price £115,000

www.thomasmerrifield.co.uk



17 Otters Court, Witney, Oxfordshire OX28 1GJ

- Entrance Hall
- Living/Dining Room
- Kitchen
- Bedroom
- Shower Room
- Double Glazing & Electric Heating
- Otters Court Facilities
- Parking Is Available
- Close To The Town Centre
- No Onward Chain

Directions

Leave our office in Market Square and proceed along Langdale Gate, turning left at the roundabout onto Witan Way. Follow this road along, turning right into New Bridge Street. Continue over the bridge and bear left. Turn left and left again and Otters Court is found on the left hand side. 10G26

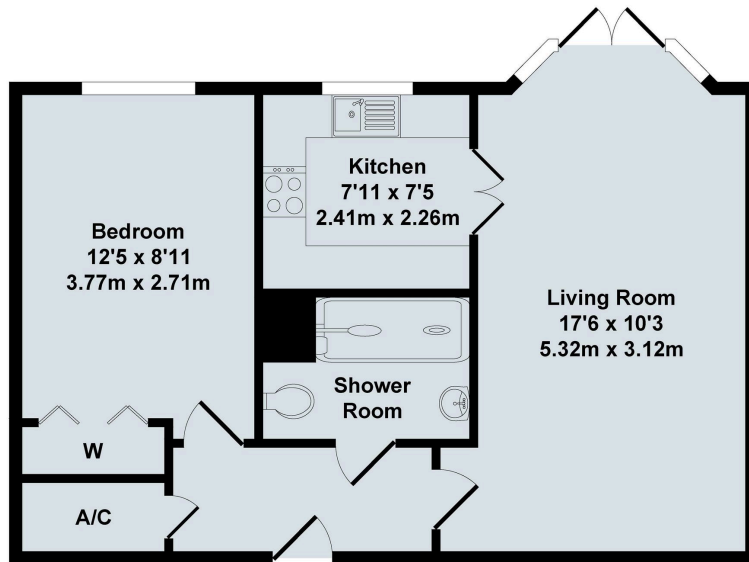

17 Otters Court



Total Approx. Floor Area 493 Sq.Ft. (45.80 Sq.M.)

All items illustrated on this plan are included in the "Total Approx Floor Area"

Local Authority:

WODC Tax Band C / EPC Rating: 84/C

Contact:

52 Market Square, Witney,
Oxfordshire, OX28 6AF

Material Information

All mains are connected, expect gas. Ultrafast broadband is available. Mobile & Data Signals - outdoor: good for EE, Three, Vodafone & O2.

Tenure:

Leasehold - 125 from 2007 - 106 years remaining
Current (2026) Service Charge £2972.24 p.a. Current (2026) Ground Rent £425 p.a.

Tel: 01993 772000

Email: witney@thomasmerrifield.co.uk

Important Notice

Thomas Merrifield for themselves and their clients give notice that:-

1. They are not authorised to make or give representation or warranty in relation to this property, either on their own behalf or on behalf of the Seller. They assume no responsibility for any statement made in these particulars. These particulars do not form part of any offer or contract and must not be relied upon as statements or representations of fact.
2. Whilst every attempt has been made to ensure the accuracy of the floorplan contained here, measurements of doors, windows, rooms and any other items are approximate and no responsibility is taken for any error, omission, or mis- statement.
3. All areas, measurements or distances are approximate. The particulars are intended for guidance only and are not necessarily comprehensive. A wide angle lens may have been used in photography. Thomas Merrifield have not tested appliances or services and it should not be assumed that the property has all necessary planning, building regulation and other consents. Buyers must satisfy themselves with the property by inspection or otherwise.
4. Reference to any mechanical or electrical equipment does not constitute a representation that such equipment is capable of fulfilling its function and prospective Buyers must make their own enquiries.
5. They have no responsibility for any expenses or costs incurred by prospective Buyers in inspecting properties which have been sold, let or withdrawn. Applicants are advised to contact the Agent to check availability and any other information of particular importance to them, prior to inspecting the property, particularly if travelling some distance.