



9 CHICHESTER COURT EWELL KT17 1TP

MICHAEL EVERETT & Co

... A Moving Experience

A second floor bright and spacious two bedroom apartment in this sought after location within a short walk of Ewell Village and West Ewell station providing regular trains to Waterloo. The area boasts an excellent range of both state and private schools, including Rosebery Girls School, Glyn School, Ewell Castle, Epsom College and City of London Freeman's School. The property is offered to the market with the benefit of no onward chain.

Communal Entrance Hall: stairs to Second Floor. Front door to spacious Entrance Hall with three storage cupboards, double doors opening into Living Room: generously proportioned with two wall light points, coved cornice to ceiling. Kitchen: comprehensive range of eye level units with cupboards and drawers below, single stainless steel sink unit with drainer, gas hob, electric oven, space for fridge/freezer, space for washing machine, tiled splashbacks. Bedroom One: spacious double bedroom with double built-in wardrobe, coved cornice to ceiling, two wall light points. Bedroom Two: double bedroom. Bathroom: panel enclosed bath, shower attachment, mixer taps, wash hand basin, low level w.c., walls fully tiled.

Outside: Well maintained communal gardens. Garage. Visitor Parking.

EPC=E
Council Tax Band: C

Unexpired Lease: 956 Years
Service/Maintenance Charge: Approx. £ 2,520.01 per annum
Ground Rent: Nil

Asking Price £295,000 Share of Freehold

Chichester Court
Floor area 65.6 Sq. Metres (705.7 Sq. Feet)
Measurements are approximate. Not to scale. Illustrative purposes only.

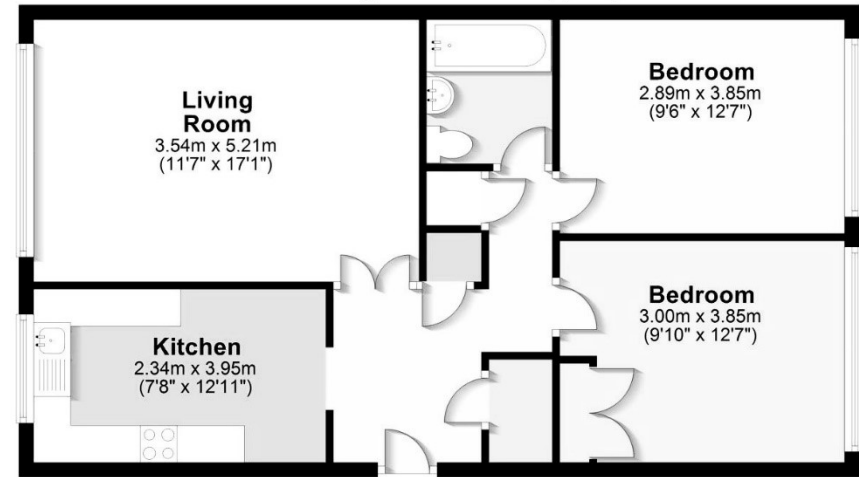

Michael Everett & Co. 87 High Street Epsom Surrey KT19 8DP
Tel: 01372 724477 Email: epsom@michael-everett.co.uk www.michael-everett.co.uk

Disclaimer: This plan is an illustration and is therefore for layout guidance only. Not drawn to scale, unless stated. Whilst every care is taken in the preparation of this plan, please check all dimensions and shapes before making any decisions reliant upon them.