



St Peters Street

Angel, N1

Asking Price £750,000

A 2 double bedroom garden flat set within this Victorian end of terrace house occupying a prominent position on the corner of St Peters Street and Cruden Street, located within the Duncan Terrace/ Colebrooke Row conservation area.

CHESTERTONS



St Peters Street

Angel, N1

- A 2 double bedroom garden flat in central Islington, moments from Islington Green
- Situated within the Duncan Terrace/ Colebrooke Row conservation area
- Sole use of private patio garden
- Fantastic access to the amenities of Upper Street & Essex Road



A charming 2 double bedroom garden flat set within this Victorian end of terrace house occupying a prominent position on the corner of St Peters Street and Cruden Street, located within the Duncan Terrace/ Colebrooke Row conservation area. Accommodation comprises 2 double bedrooms, bathroom, reception room, separate kitchen and sole use of a private patio garden. St Peters Street is situated within the heart of Islington, moments from Islington Green and the hustle and bustle of both Upper Street & Essex Road. Angel Underground is the closest station and provides good links to Bank, along with Kings Cross/ St Pancras International. The major supermarkets of Waitrose, Marks & Spencer and Sainsburys can be found towards the bottom of Liverpool Road, close to Angel, with the renowned bars & restaurants of Exmouth Market located close to Sadlers Wells Theatre.

Tenure: Leasehold 109 years 4 months
Service Charge: £240
Ground Rent: £250
Local Authority: Islington
Council Tax Band: D

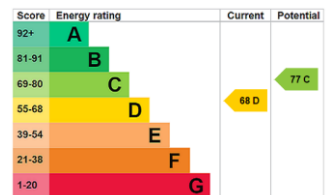

Chestertons Islington Sales

327-329 Upper Street
 Islington
 London
 N1 2XQ
 islington@chestertons.co.uk
 020 7359 9777
 chestertons.co.uk

St Peters Street,
Angel, N1

○ - Ceiling Height

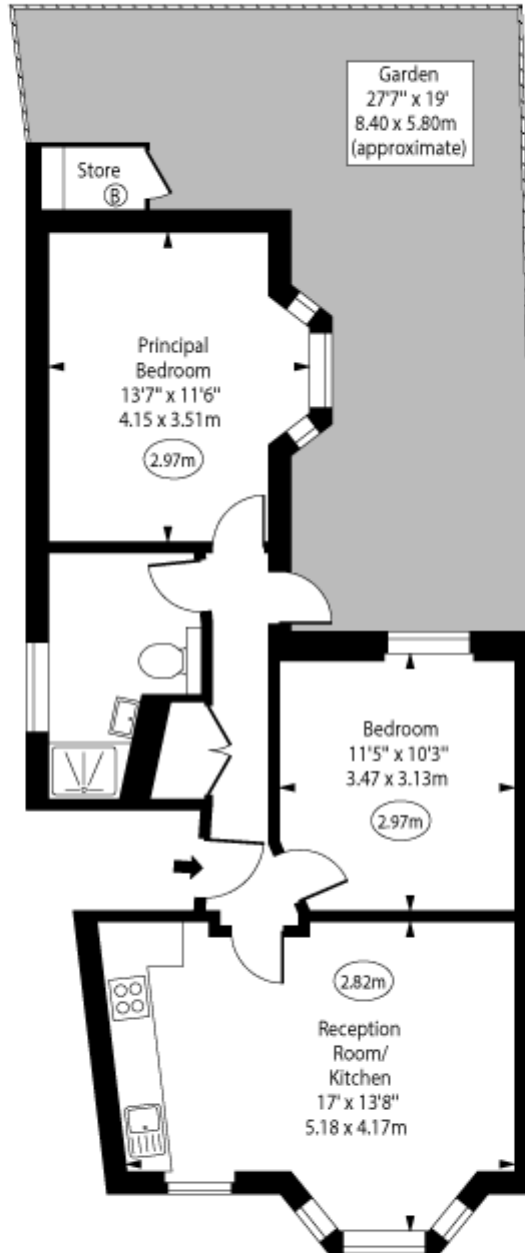

Ground Floor

Approx Gross Internal Area 603 Sq Ft - 56.02 Sq M

Every attempt has been made to ensure the accuracy of the floor plan shown. However, all measurements, fixtures, fittings, and data shown are approximate interpretations and for illustrative purposes only. Measured according to the RICS. Not To Scale.

www.goldlens.co.uk

Ref. No. 031595J

