



## Fingal Street, SE10

£750,000

A five-bedroom, two-bathroom period family home, ideally located within the catchment area for Halstow Primary School and set in a highly sought-after location. Extending to over 1,500 sq ft, this property presents an excellent opportunity for buyers looking to put their own stamp on a home and create something truly special. A viewing is highly recommended to fully appreciate the potential on offer.

Fingal street is well located in East Greenwich, and sits at the foot of the Peninsula. The O2 arena and underground is close by, as is Maze Hill station. Westcombe Park mainline station is a short walk away, as well as local shopping parks and access to buses, which can take you directly into Greenwich town centre.

### Features

- Freehold
- Family Home
- Period
- Five Bedrooms
- Two Bathrooms
- Sought after location

# Fingal Street, London, SE10

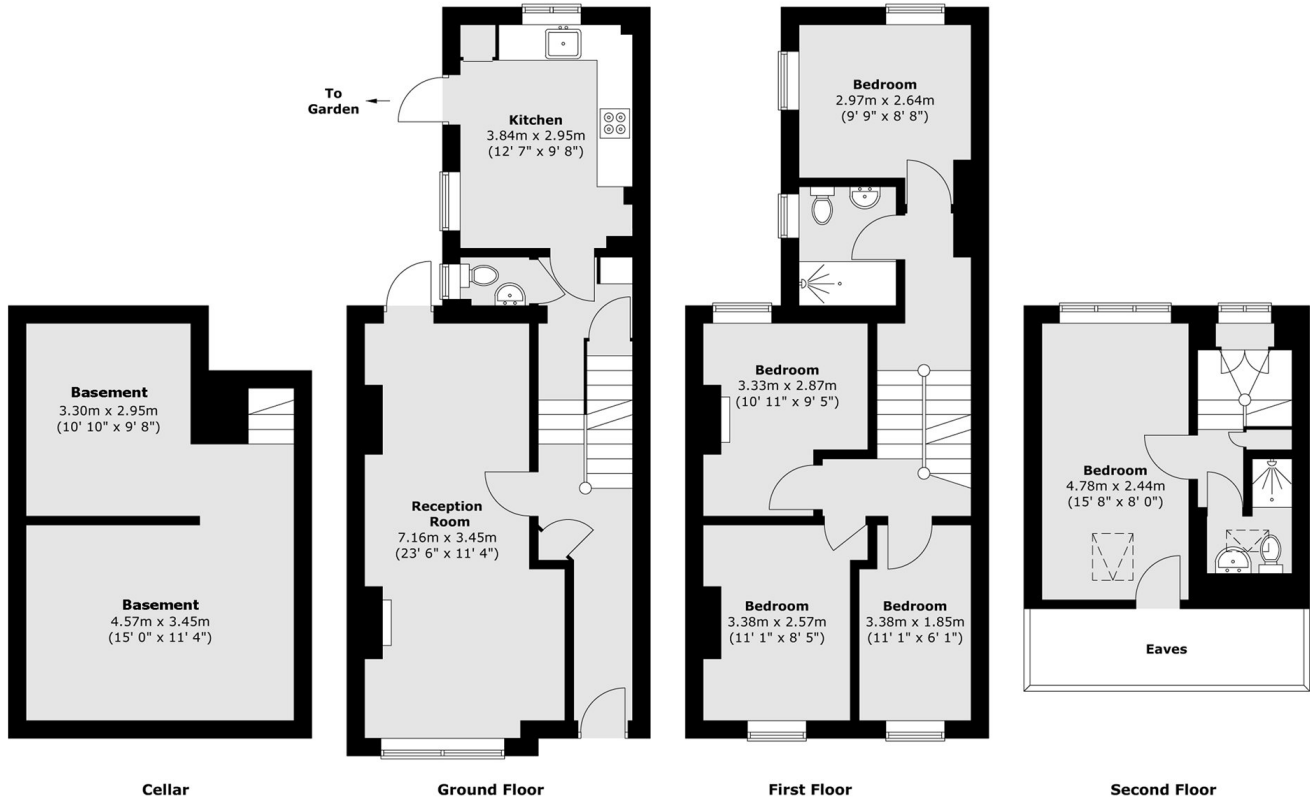

Total area (approx.) : 144.9 sq. m (1560 sq. ft)  
(Excluding eaves)