



# ASPIRE RESIDENTIAL

Service | Expertise | Accountability



Exmoor Drive, Worthing, BN13 2PH

Offers Over £425,000

Nestled in sought-after Salvington, this detached three-bedroom bungalow delivers single-level comfort and contemporary flair. A block-paved drive offers ample parking and flows to a large garage for storage or hobbies. Inside, a central hall leads to three well-proportioned bedrooms, a sleek fully-tiled bathroom and a handy utility. At the rear, a modern shaker-style kitchen adjoins a bright dining room, while a full-length west-facing conservatory floods the home with light and opens to a private lawn bordered by mature shrubs and colourful borders. Double glazing and gas central heating ensure year-round ease. Shops, buses, parks and the South Downs are all a short stroll away, giving village calm with daily convenience.



Council Tax Band: E



- Detached three-bed bungalow
- Modern shaker-style kitchen
- Full-length west conservatory
- Fantastic natural light throughout
- Private west-aspect rear garden
- Sought-after Salvington location
- Luxury fully-tiled bathroom
- Utility Room plus Dining Room
- Driveway parking & large garage
- Easy walk to shops & South Downs





Worthing, a charming seaside town on the south coast of England, strikes a balance between Victorian elegance and contemporary energy. Its extensive pebble beach, historic pier and scenic promenade make for a quintessential coastal experience. A thriving cultural scene, including theatres, galleries and local events, brings vibrancy to the town. With lush green spaces such as Beach House Park and Highdown Gardens, plus a bustling town centre full of shops, restaurants and entertainment, Worthing is a well-connected, welcoming community with a rich history and enduring appeal.

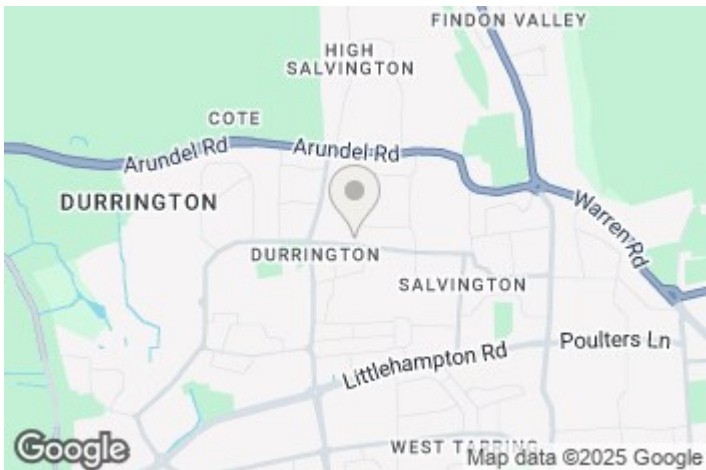

EPC Rating:  
D

Energy Efficiency Rating		
	Current	Potential
Very energy efficient - lower running costs		
(92 plus) A		
(81-91) B		
(69-80) C		79
(55-68) D	61	
(39-54) E		
(21-38) F		
(1-20) G		
Not energy efficient - higher running costs		
England & Wales	EU Directive 2002/91/EC	

## Ground Floor

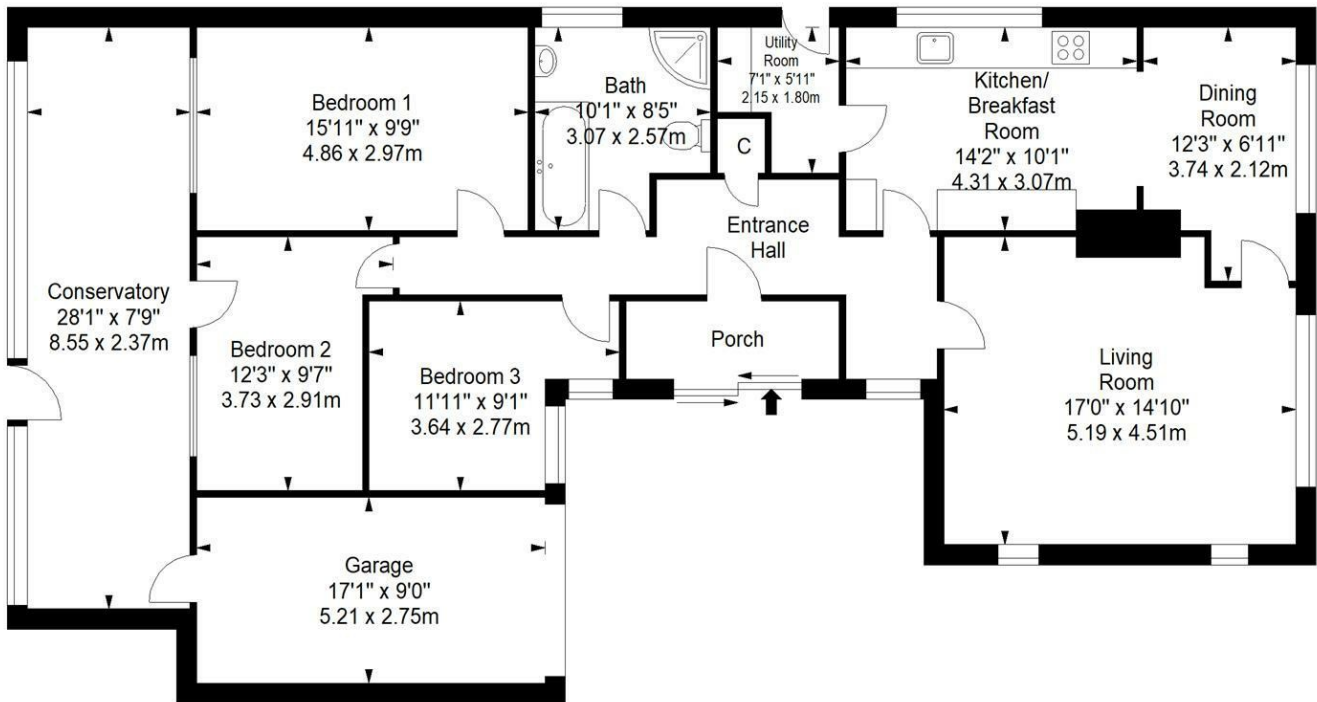

Approximate gross internal floor area 140.1 sq m/ 1508.1 sq ft

Whilst every care has been taken to ensure accuracy, dimensions are approximate and for illustrative purposes only.  
All rights reserved.

### Aspire Residential | Goring-by-Sea

28 Goring Road  
Goring-by-Sea  
Worthing  
BN12 4AD  
Telephone: 01903 259 961  
Email: [info@aspireresidential.co.uk](mailto:info@aspireresidential.co.uk)



### Aspire Residential | Durrington / Salvington

5 Selden Parade  
Salvington Road  
Worthing  
BN13 2HL  
Telephone: 01903 910 424  
Email: [enquiries@aspireresidential.co.uk](mailto:enquiries@aspireresidential.co.uk)

Aspire Residential and Aspire Residential Estate Agents are trading names of Aspire Residential Sales Limited, a Company registered in England and Wales with registration number 11659289. VAT No. 317450614

**IMPORTANT NOTICE TO PURCHASERS:** We endeavour to make our sales particulars accurate and reliable, however, they do not constitute or form part of an offer or any contract and none is to be relied upon as statements of representation or fact. The services, systems and appliances listed in this specification have not been tested by us and no guarantees as to their operating ability or efficiency are given. All measurements have been taken as a guide to prospective buyers only, and are not precise. If you require clarification or further information on any points, please contact us, especially if you are traveling some distance to view.