



# BURNT ASH HILL, SE12

£325,000

- Two Bedroom
- Second Floor
- Modern
- Allocated Parking
- Long Lease
- Communal Garden

@marshandparsons  
marshandparsons.co.uk

MARSH &  
PARSONS



# ABOUT THE PROPERTY

A fantastic two bedroom apartment set on the middle floor of Ash House. The property benefits from a bright and airy reception room, opening onto a south west facing juliette balcony that brings in an abundance of light and frames the treetop outlook. The separate kitchen is neatly laid out with good storage, and both double bedrooms are spacious with built in wardrobe space. The bathroom has been beautifully modernised, additionally there is allocated parking available and a communal garden.

Set on Burnt Ash Hill, you have easy access to Lee Station for fast links into London Bridge and the City, with local cafés, groceries and open green spaces all within easy reach.



# STEP INSIDE BURNT ASH HILL

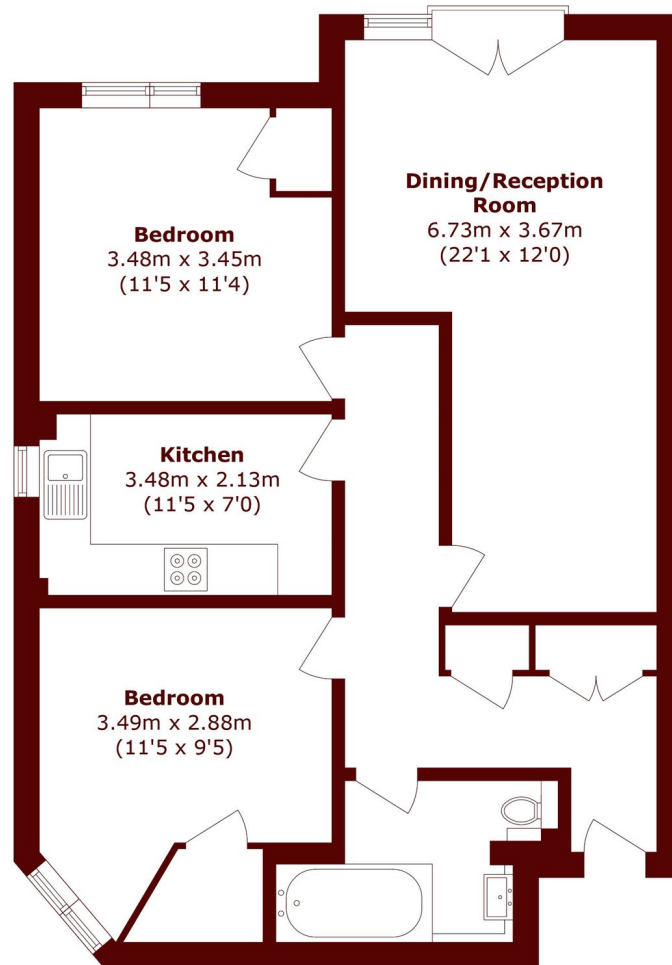

Total area (approx.): 71.8 sq. m (772.8 sq. ft)

Lee  
020 8102 0123

Energy Rating: B We aim to make our particulars both accurate and reliable. However, they are not guaranteed; nor do they form part of an offer or contract. If you require clarification on any points then please contact us, especially if you're traveling some distance to view. Please note that appliances and heating systems have not been tested and therefore no warranties can be given as to their good working order

MARSH &  
PARSONS