



**Apartment C, 2-5 Claremont Buildings, Shrewsbury, SY1 1RJ**

2 bedroom first floor apartment—£248,000 Leasehold (Share of Freehold)

## Apartment C, 2-5 Claremont Buildings, Shrewsbury, SY1 1RJ

Coopergreenpooks.co.uk

£248,000 Leasehold (Share of Freehold)—2 bedroom first floor apartment  
sales@cgpooks.co.uk

Located in one of Shrewsbury's finest Georgian buildings, this impressive two double bedroomed first floor apartment has the benefit of lift access and secure underground parking. The light and spacious interior provides views over the adjoining communal gardens and Quarry Park, whilst being perfectly placed for beautiful riverside walks, an impressive range of restaurants, bars, and independent shops, as well as Theatre Severn, Shrewsbury swimming pool and railway station.

### KEY FEATURES

- Well configured accommodation with large feature sash windows and high ceilings.
- Attractive and spacious communal areas with access either via lift or original staircase.
- Entrance hall with entry phone system and built in storage.
- Good sized open plan living/dining room connecting to a separate fitted kitchen, from both of which there are communal garden and Quarry park views.
- 2 double bedrooms (again with lovely views) and 2 well-fitted shower rooms, one of which is en-suite to the main bedroom.
- Gas fired hive heating system and secondary glazing.
- Well-kept private communal gardens for resident's use, having direct gated access to the stunning Quarry Park.
- Secure underground gated car parking for residents, with easily accessible designated space and bike storage area. From which there is direct access into the main building and also bin storage area.
- Sold with no onward chain.
- Payment of the service charge for 2025/26 will be included in the sale of the property

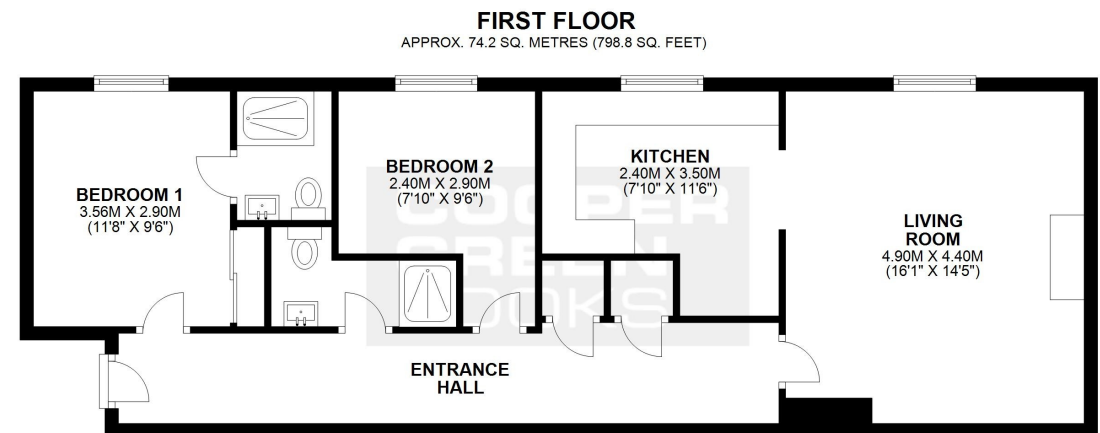

TOTAL AREA: APPROX. 74.2 SQ. METRES (798.8 SQ. FEET)

We accept no responsibility for any mistake or inaccuracy contained within the floorplan. The floorplan is provided as a guide only and should be taken as an illustration only. The measurements, contents and positioning are approximations only and provided as a guidance tool and not an exact replication of the property.  
Plan produced using PlanUp.





## Apartment C, 2-5 Claremont Buildings, Shrewsbury, SY1 1RJ

Coopergreenpooks.co.uk

£248,000 Leasehold (Share of Freehold)—2 bedroom first floor apartment  
sales@cgpooks.co.uk



Cooper Green Pooks  
3 Barker Street  
Shrewsbury  
SY1 1QF

www.cgpooks.co.uk  
sales@cgpooks.co.uk  
01743 276666



# Apartment C, 2-5 Claremont Buildings, Shrewsbury, SY1 1RJ

£248,000 Leasehold (Share of Freehold)—2 bedroom first floor apartment  
sales@cgpooks.co.uk

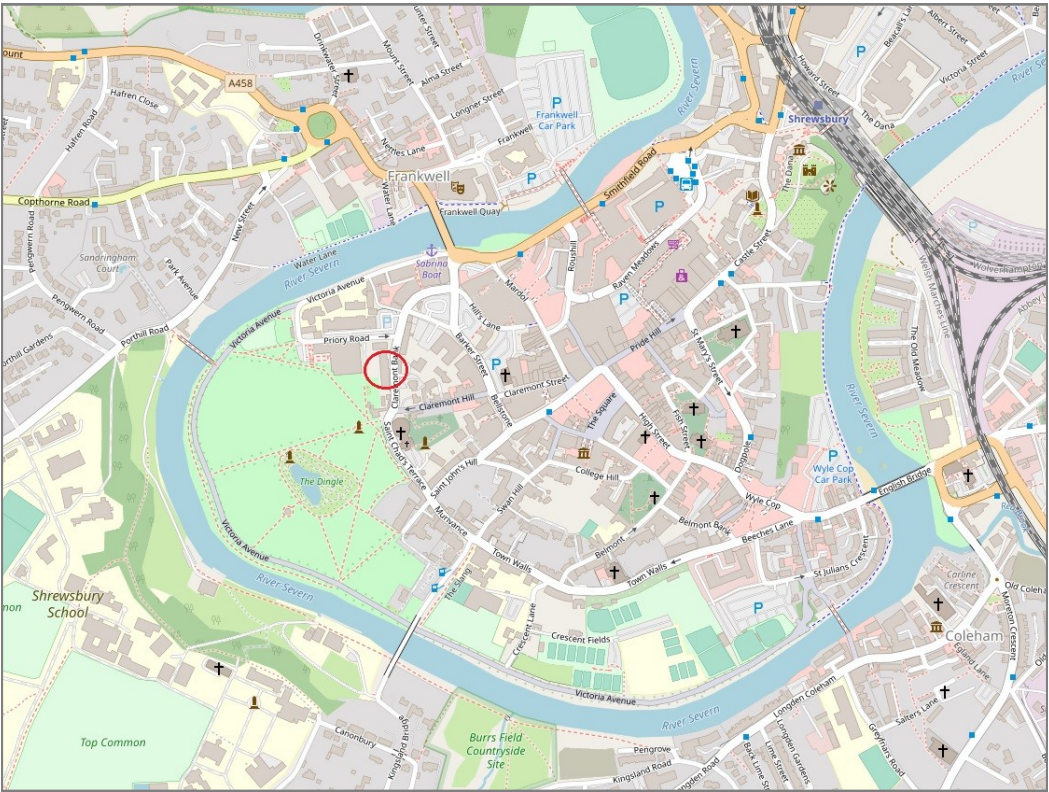

Tenure                   **Leasehold**  
Lease Length       **199 years from 1998**  
Service Charge      **£236.47 paid monthly**

Local Authority      **Shropshire Council**  
Council Tax          **Band E**  
EPC                    **Band C**  
Services              **All mains services are connected**

# Apartment C, 2-5 Claremont Buildings, Shrewsbury, SY1 1RJ

Coopergreenpooks.co.uk

£248,000 Leasehold (Share of Freehold)—2 bedroom first floor apartment

sales@cgpooks.co.uk



**IMPORTANT NOTICE:** Cooper Green Pooks for themselves and for the lessors or vendors of this property whose agents they are give notice that: 1 No appliances, services or service installations have been tested and no warranty as to suitability or serviceability is implied. Any prospective purchaser or lessee is advised to obtain verification from their surveyor or solicitor. 2. The particulars are set out as a general outline only for the guidance of the intended purchasers or lessees and do not constitute, nor constitute part of, an offer or contract. 3. All descriptions, reference to condition and necessary permissions for use and occupation and other details are given in good faith and are believed to be correct but any intending purchasers or lessees should not rely on them as statements or representation of fact but satisfy themselves by inspection or otherwise as to the correctness of each of them. 4. No person in the employment of Cooper Green Pooks has any authority to make or give any representation or warranty whatsoever in relation to this property. 5. All rentals and prices are quoted exclusive of Stamp Duty, legal and surveyors fees and any other associated purchasers or lessees costs. 6. Floor plans are indicative only and should not be relied on. 7. The plan showing the boundary of the property is indicative only and has not been checked against the legal title so should not be relied on. 8. All dimensions, floor areas and site areas are only approximate and should not be relied on. Dimensions are generally maximum room dimension.