

Pembroke Road

CLIFTON

APPROXIMATE FLOOR AREA
54.1 SQM / 582 SQFT



RAISED GROUND FLOOR
582 sq.ft. (54.1 sq.m.) approx.

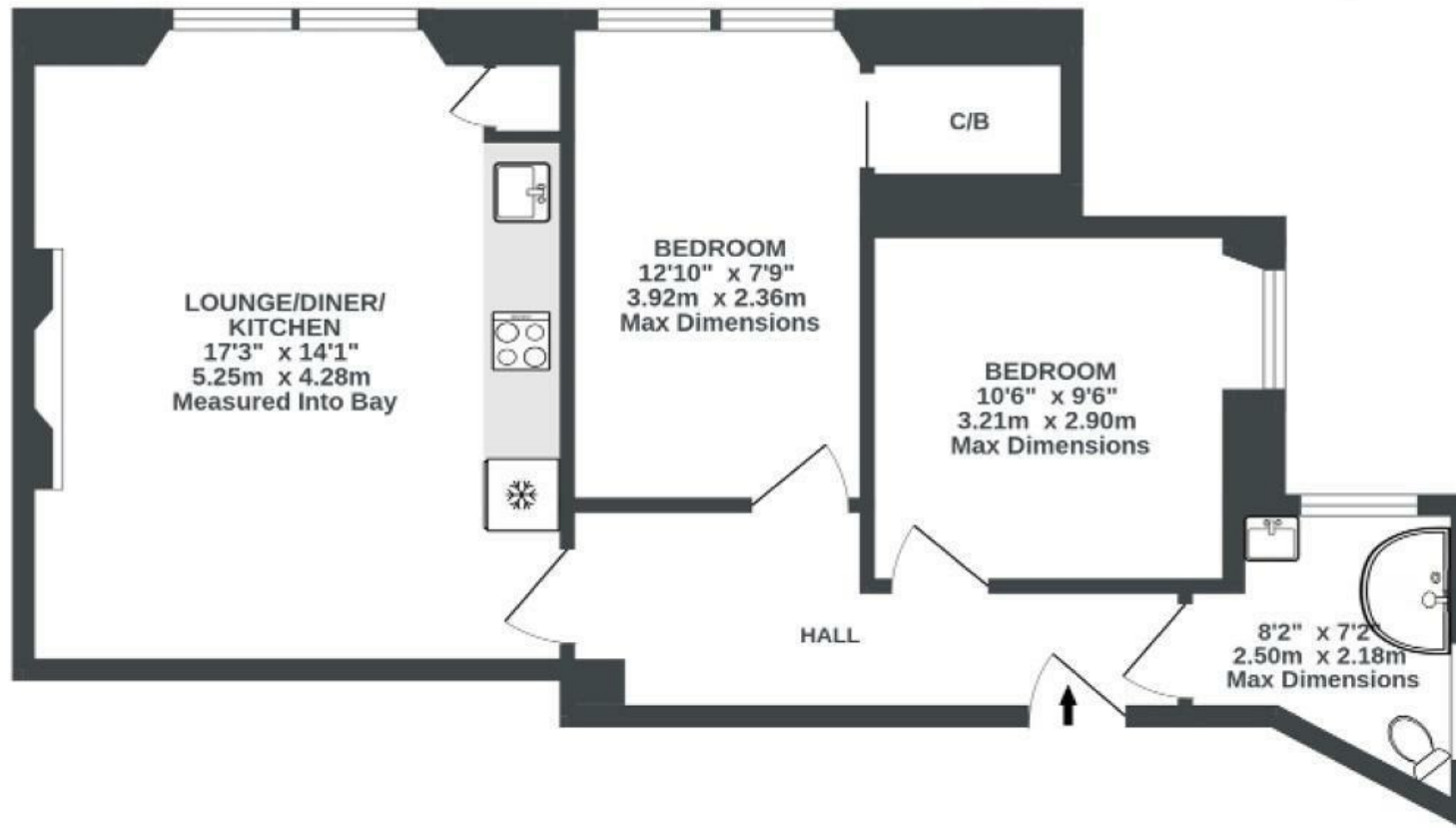

Illustrations are for reference purposes only, measurements are approximate, not to scale.

Boardwalk

Pembroke Road

CLIFTON, BRISTOL

£

£365,000

zzz

2 Bedrooms

📍

BS8 3ER

🛁

1 Bathrooms

"The apartment has wonderfully high ceilings and feels so much more spacious than you might expect. We love waking up on a Sunday morning when the sun is shining and wandering into Clifton for a coffee, or heading up to the Downs for a breath of fresh air."

