



**Station Lane, Ingatestone, CM4 0BL**  
**£450,000**

**Jenkins Property**

T: 01277228620

E: SALES@JENKINS-PROPERTY.COM

WWW.JENKINS-PROPERTY.COM

# Jenkins Property

In a lovely location with secluded gardens this substantial two bedroom ground floor apartment is in a beautiful converted listed Gatehouse. Set within established well tended grounds enjoying own private rear access and patio area. This fine property benefits from its own garage and is favourably positioned for Ingatestone village and station having links to London Liverpool Street.



**Entrance Area** 4'1" x 5'4" (1.24m" x 1.63m")

**Living Room** 19'5" x 16'10" (5.92m" x 5.13m")

**Kitchen** 11'2" x 7'3" (3.40m" x 2.21m")

**Bedroom/Dining Room** 12'10" x 8'6" (3.91m" x 2.59m")

**Bedroom** 10'2" x 4'8" (3.10m" x 1.42m")

**Bathroom** 10'2" x 4'8" (3.10m" x 1.42m")

#### **Garage**

In Block

#### **Exterior**

Communal Gardens, own own private patio area.



- Ground Floor
- Two Bedrooms
- Popular Village

- Own Patio Area
- Garage

- Versatile Living
- Close To Station

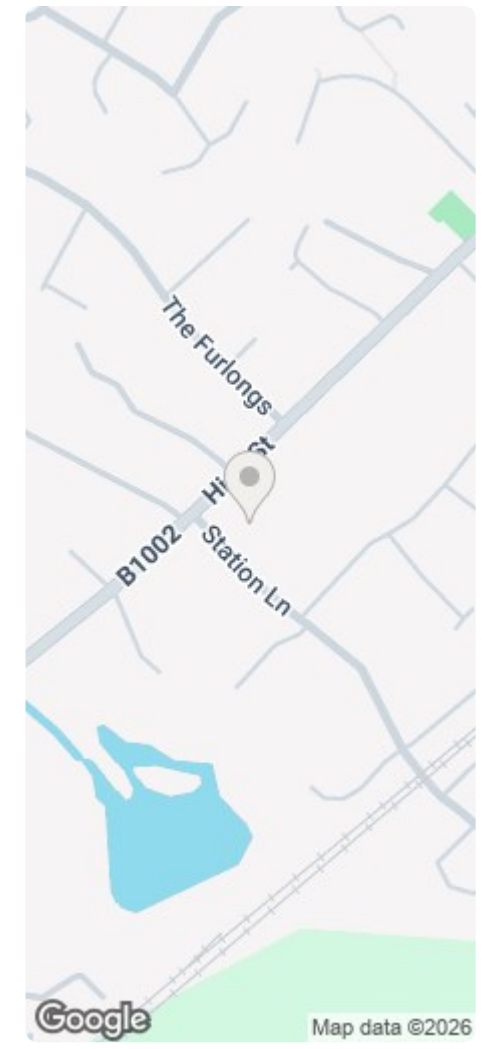
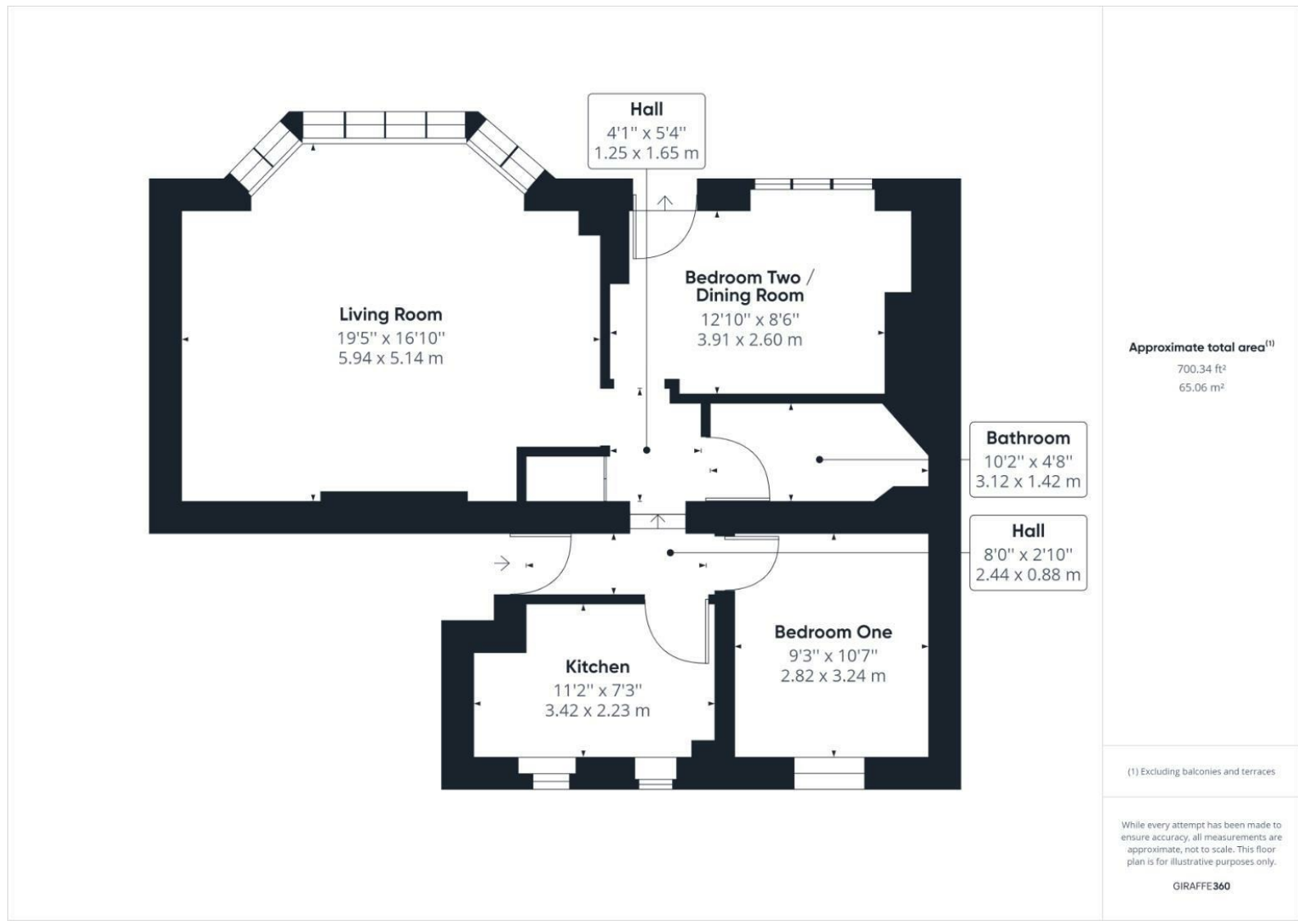

Energy Efficiency Rating		Environmental Impact (CO <sub>2</sub> ) Rating	
Current	Target	Current	Target
68	71		

Best energy efficient - lower running costs  
 Worst energy efficient - higher running costs  
 Best environmentally friendly - lower CO<sub>2</sub> emissions  
 Worst environmentally friendly - higher CO<sub>2</sub> emissions

England & Wales  
 EU Directive 2002/91/EC

