

9 Reed Lane - Offers Over £280,000

Red Lodge Bury St. Edmunds IP28 8ZA



"Consistently providing outstanding service to our clients"

Offers Over £280,000

The Property

Shires Residential Sales are delighted to present this modern and beautifully presented three-bedroom semi-detached house, located on the sought-after Reed Lane in the popular village of Red Lodge.

Built in 2017 and offering approximately 807 sq ft of well-designed accommodation, the property provides an excellent balance of modern living, comfort and space.

Inside, the home features:

Three double bedrooms, including an en-suite to bedroom one
A modern kitchen/diner
Separate living room/reception room
Cloakroom / Family bathroom

Externally, the property benefits from a private rear garden and a double car port, providing parking for two vehicles.

Situated near Bury St Edmunds, Cambridge and Newmarket, Red Lodge offers a peaceful village setting while remaining close to local amenities, schools and transport links.

This is an ideal home for first-time buyers, families or anyone seeking a stylish and well-located modern property. Early viewing is highly recommended. Feel free to call Shires.

Agent's Note:

Please be aware that images of the property may have been digitally enhanced, edited, or staged using artificial intelligence, and may not reflect the current presentation or furnishings.

Features

- THREE DOUBLE BEDROOMS
- POPULAR LOCATION
- MODERN THROUGHOUT
- STILL WITHIN 10 YEAR NHBC WARRANTY
- PARKING
- DOUBLE CAR PORT
- IDEAL FAMILY HOME
- MODERN GARDEN
- WELL MAINTAINED
- ENCLOSED GARDEN





These sales particulars have been produced as a general guide only and we would draw to your attention that we have not carried out a detailed Survey of the property nor have we tested services, appliances or specific fittings. Whilst measurements and statements given within the details are provided in good faith, their accuracy should not be relied upon. If there are any points about which you may be uncertain or would like further clarification, we would suggest that you telephone this office and speak to our staff who will endeavour to assist you.

Shires
 To view this property or request more details, contact
 01638 597090
 About Shires Estate & Letting Agents, Mildenhall



Floorplan for 3 bedroom house for sale

These floor plans are shown to give an impression of the layout of the property. They are not intended to be used as a guide to the actual layout of the property. The actual layout of the property may vary from the floor plans shown. The actual layout of the property may vary from the floor plans shown. The actual layout of the property may vary from the floor plans shown.

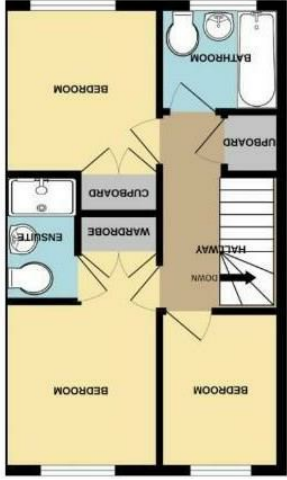

1ST FLOOR

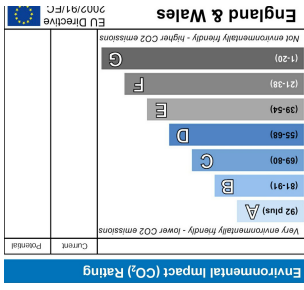
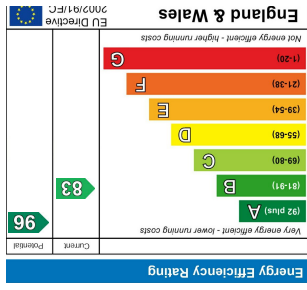

Shires Residential
 4 New Street, Mildenhall, Suffolk, IP28 7EN
 T: 01638 712132
 E: mildenhall@shiresestateagents.co.uk
 www.shiresresidential.com