



£217,500

At a glance...



2



1



1

EPC

C

COUNCIL
TAX

B

**holland
& odam**

19 Mendip View
Street
Somerset
BA16 9PQ

TO VIEW

3 Farm Road, Street,
Somerset BA16 0BJ

01458 841411

street@hollandandodam.co.uk



Directions

Proceeding along the High Street, Bear Inn on your left hand side. Turn right into Farm Road and continue past Clarks Village until you reach a set of traffic lights. Turn right and then immediately left into Grange Avenue. Continue along Grange Avenue and turn right into Mendip View, follow the road down the hill and around the bend where the property can be found on the right hand side and will be identified by our for sale board.

Services

Mains electricity, gas, water and drainage are connected. Gas central heating system.

Local Authority

Somerset Council
0300 1232224
somerset.gov.uk

Tenure

Freehold



Location

Mendip View is situated on the northern side of Street within walking distance of the High Street and Clarks Village with its comprehensive range of shopping facilities and restaurants. Street also offers recreational and sporting facilities including Strode Theatre, both indoor and open air swimming pools, tennis, football, cricket etc. The historic town of Glastonbury is within 2 miles whilst the nearest M5 motorway interchange at Dunball, Bridgwater is 12 miles. Bristol, Bath, Taunton and Yeovil are within commuting distance.

Insight

A well-presented two-bedroom mid-terrace home, ideal for first-time buyers or investors, offering comfortable living with a private rear garden and off-road parking. Conveniently located within walking distance of the High Street and Clarks Village.

- Spacious sitting room which is bright and welcoming, featuring sliding doors that open directly onto the rear garden, providing easy access and a pleasant garden outlook.
- The kitchen has been fitted with a comprehensive range of wall, base and drawer units with space for washing machine and free-standing cooker and fridge/freezer.
- Affording two well proportioned double bedrooms both of which are light and bright; with one benefiting from a built in cupboard and the other with views across to Glastonbury Tor.
- Serviced by the family bathroom comprising bath with shower over, wash basin and WC.
- Fully enclosed rear garden featuring a lawn, paved patio area and space for outdoor furniture ideal for dining, entertaining, or simply relaxing.
- Benefiting from two allocated off-road parking spaces positioned directly to the front of the property, offering convenient parking.



GROUND FLOOR
271 sq.ft. (25.1 sq.m.) approx.

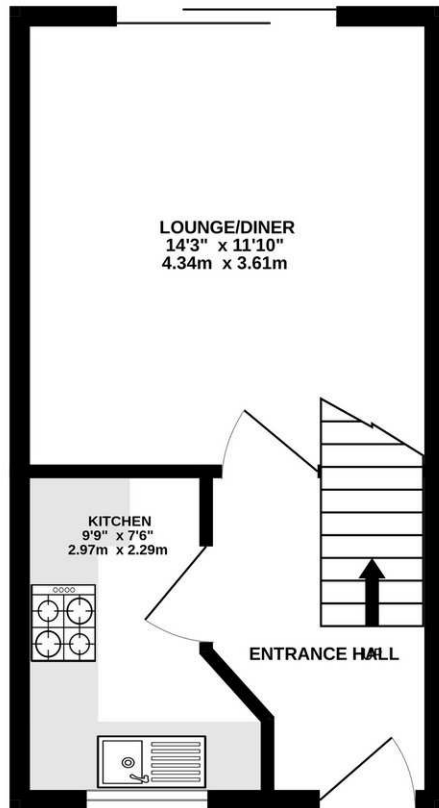

1ST FLOOR
270 sq.ft. (25.1 sq.m.) approx.

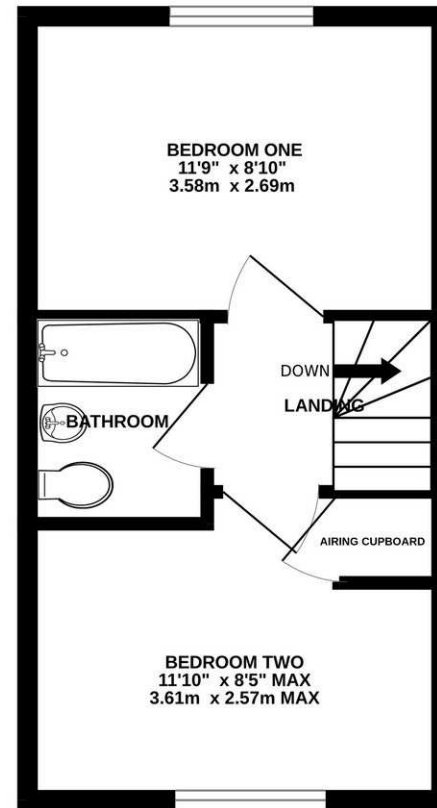

TOTAL FLOOR AREA : 541 sq.ft. (50.2 sq.m.) approx.

Whilst every attempt has been made to ensure the accuracy of the floorplan contained here, measurements of doors, windows, rooms and any other items are approximate and no responsibility is taken for any error, omission or mis-statement. This plan is for illustrative purposes only and should be used as such by any prospective purchaser. The services, systems and appliances shown have not been tested and no guarantee as to their operability or efficiency can be given.
Made with Metropix ©2025

DISCLAIMER

CONSUMER PROTECTION FROM UNFAIR TRADING REGULATIONS 2008. The Agent has not tested any apparatus, equipment, fixtures and fittings or services and so cannot verify that they are in working order or fit for the purpose. A Buyer is advised to obtain verification from their Solicitor or Surveyor. References to the Tenure of a Property are based on information supplied by the Seller. The Agent has not had sight of the

title documents. A Buyer is advised to obtain verification from their Solicitor. Items shown in photographs are not included unless specifically mentioned within the sales particulars. They may however be available by separate negotiation. Buyers must check the availability of any property and make an appointment to view before embarking on any journey to see a property.

DATA PROTECTION. Personal information provided by customers wishing to receive information and/or services from the estate agent and the Property Sharing Experts (of which it is a member) for the purpose of providing services associated with the business of an estate agent but specifically excluding mailing or promotions by a third party. If you do not wish your personal information to be used for any of these purposes, please notify us.