



# Larch Road

## Cricklewood, NW2

£3,250 per month  
(£750 per week)

\*VIDEO TOUR AVAILABLE\*. A 3 bedroom ground floor apartment in new building with wood floors throughout and a private terrace in quiet residential road in Cricklewood.

CHESTERTONS



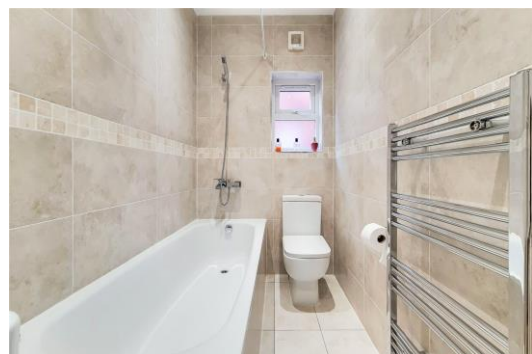

# Larch Road

## Cricklewood, NW2

- A Ground Floor Apartment in New Building
- 3 Bedrooms, 2 Bathrooms, Reception, Fitted Kitchen
- Wood Floors Throughout,, Private Terrace, Sharers Accepted
- Situated in a Quiet Residential Road in Cricklewood





\*VIDEO TOUR AVAILABLE\*. A 3 bedroom ground floor apartment with wood floors throughout and a private terrace. The property is situated in a quiet residential road in Cricklewood. Accommodation comprises reception room, open plan fully fitted eat in kitchen leading to the terrace, master bedroom with en-suite shower room, 2 further double bedrooms, family bathroom.

**Minimum Term:** 12 months  
**Deposit Required:** £3,750.00  
**Local Authority:** Brent London Borough Council  
**Council Tax Band:** E  
**EPC Rating:** C  
**Furnished**

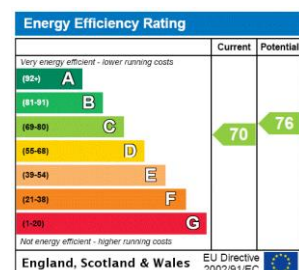

### *Chestertons Hampstead Lettings*

55-56 Hampstead High Street  
 Hampstead  
 London  
 NW3 1QH  
[hampsteadlettingsusers@chestertons.co.uk](mailto:hampsteadlettingsusers@chestertons.co.uk)  
 02077941125  
[chestertons.co.uk](http://chestertons.co.uk)

Additional tenant charges apply (fees apply to non-AST tenancies only)  
 Tenancy Agreement Fee: £300  
 References per Tenant/Guarantor: £60  
 Inventory check (approx. £100 – £250 inc. VAT)  
[chestertons.co.uk/property-to-rent/applicable-fees](http://chestertons.co.uk/property-to-rent/applicable-fees)



Larch Road, NW2

CAPTURE DATE 14/09/2022 LASER SCAN POINTS 66,264,845

GROSS INTERNAL AREA

72.42 sqm / 779.52 sqft

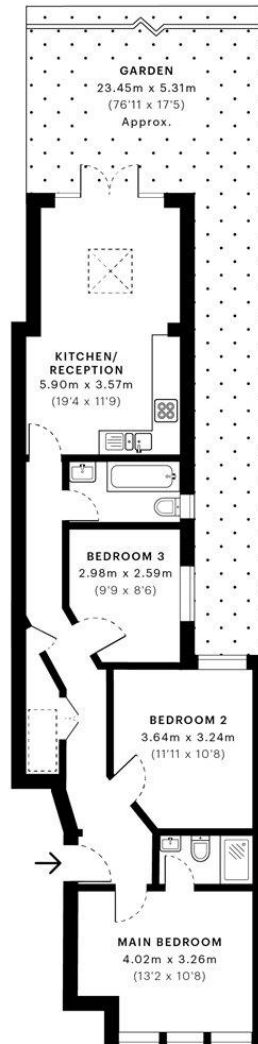

— Ground Floor



GROSS INTERNAL AREA (GIA)  
The footprint of the property  
72.42 sqm / 779.52 sqft



NET INTERNAL AREA (NIA)  
Excludes walls and external features  
Includes vestibules, restricted head height  
68.89 sqm / 741.53 sqft

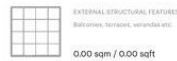

EXTERNAL STRUCTURAL FEATURES  
Balconies, terraces, verandas etc.  
0.00 sqm / 0.00 sqft



RESTRICTED HEAD HEIGHT  
Limited use area under 1.5m  
1.44 sqm / 15.50 sqft



Spec Verified floor plans are produced in accordance with:  
Royal Institution of Chartered Surveyors' Property Measurement Standards.  
Plans and gardens are illustrative only and excluded from all area calculations.  
Due to rounding, numbers may not add up precisely.  
All measurements shown for the individual room lengths and widths  
are the maximum points of measurements captured in the scan.

IPMS 1B RESIDENTIAL 72.01 sqm / 764.82 sqft  
IPMS 2C RESIDENTIAL 69.39 sqm / 746.80 sqft

SPEC ID 563209350635d440e32c3887d

Chesterton UK Services Limited trading as Chestertons for themselves and for the vendor of this property whose agents they are, give notice that (i) these particulars do not constitute any part of an offer or contract, (ii) all statements contained within these particulars are made without responsibility on the part of Chestertons or the vendor, (iii) whilst made in good faith, none of the statements contained within these particulars are to be relied upon as a statement or representation of fact, (iv) any intending purchasers must satisfy themselves by inspection or otherwise as to the correctness of each of the statements contained within these particulars, (v) the vendor does not make or give either Chestertons or any person in their employment any authority to make or give representation or warranty whatsoever in relation to this property. Wide angle lenses may be used. ©Copyright Chestertons | Chesterton Global Ltd | Registered Office 40 Connaught Street, Hyde Park, London W2 2AB Registered Company Number 05334580.



This paper is  
100% recyclable