



## Bromyard Avenue, London W3

Price £2,400 per month - Furnished







## Description

A stylish second floor apartment (with lift) in this gated development in West London. The property consists of master bedroom with en suite bathroom, second double bedroom, one shower room, reception room and a fully fitted, open plan kitchen. Further benefits include wooden flooring in the reception room, a balcony and 24 hour concierge. Napier House is conveniently located close to Westfield Shopping Centre and the open spaces of Acton Park.

- 2 Double Bedrooms
  - 2 Bathrooms
  - 24 Hour Concierge
  - Furnished
  - Close to Transport Links
  - 693 Sq Ft (64.36 Sq M)
-

# Floorplan

693 sq ft | 64 sq m

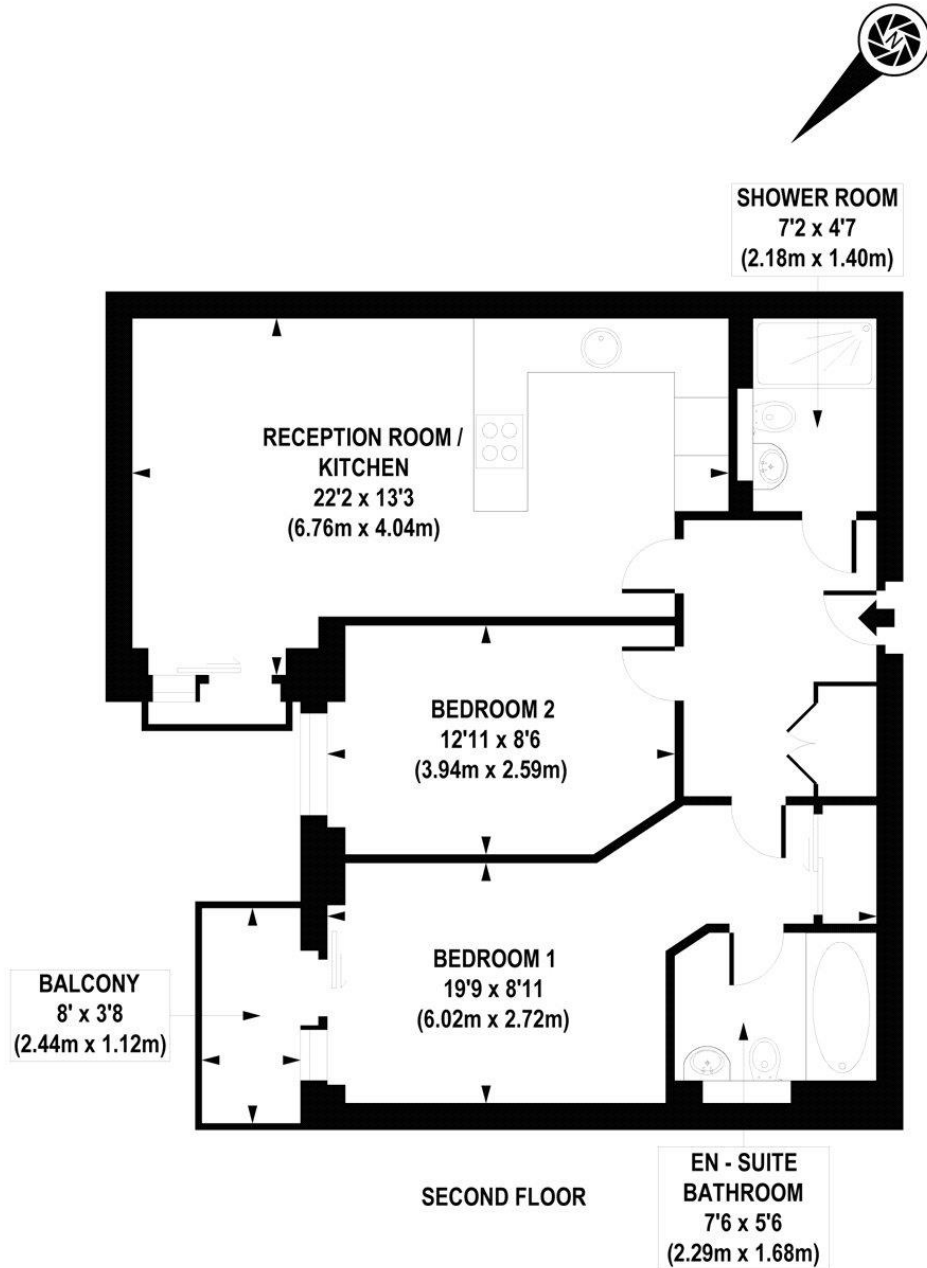

APPROX. GROSS INTERNAL FLOOR AREA 693 sq. ft / 64.36 sq. m

COMPLIANT WITH RICS CODE OF MEASURING PRACTICE Floorplan is for illustrative purposes only and is not to scale. Every attempt has been made to ensure the accuracy of the floorplan shown, however all measurements, fixtures, fittings and data shown are an approximate interpretation for illustrative purposes only. Liability for errors, omissions or mis-statement through negligence or otherwise is hereby excluded.



Kew Bridge  
12 Capital Interchange Way,  
London TW8 0SP  
020 3147 1880  
lettingskewbridge@jll.com

*Urban living, your way.*

[jll.co.uk/residential](http://jll.co.uk/residential)

© 2019 Jones Lang LaSalle IP, Inc. All rights reserved. All information contained herein is from sources deemed reliable; however, no representation or warranty is made to the accuracy thereof.

