



Flat 6 Queensgate House, 16 Cookham Road, Maidenhead SL6 8BD

welcome to

Flat 6 Queensgate House, 16 Cookham Road, Maidenhead

A well-presented one-bedroom apartment offering modern, low-maintenance living in a highly convenient central Maidenhead location. Situated within a popular and well-maintained development, this stylish property benefits from allocated parking and is ideal for first-time buyers and/or investors.



Cookham Road, Maidenhead, SL6

Approximate Area = 384 sq ft / 35.7 sq m

For identification only - Not to scale

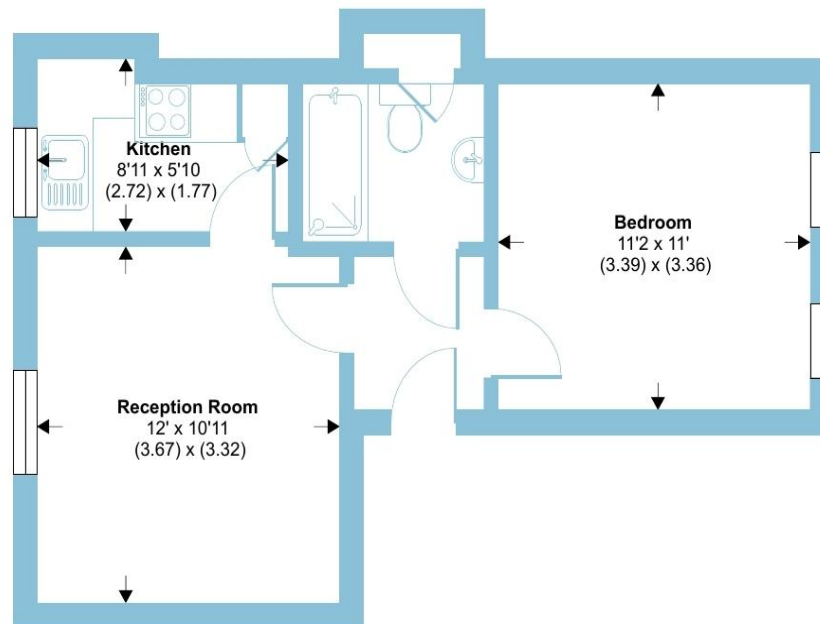

THIRD FLOOR

Queensgate House benefits from secure entry and allocated parking, offering added convenience and peace of mind. The development is ideally located within easy walking distance of Maidenhead town centre, local amenities, and the Elizabeth Line station, providing fast and direct links into London Paddington and the West End.

With excellent transport connections, modern interiors and a desirable central setting, Queensgate House represents an excellent opportunity for buyers looking to secure a smart, well-positioned home. Early viewing is highly recommended.

welcome to

Flat 6 Queensgate House

- WELL MAINTAINED DEVELOPMENT
- CONVENIENT CENTRAL MAIDENHEAD LOCATION
- IDEAL FOR FIRST TIME BUYERS AND/OR INVESTORS
- LOW MAINTENANCE LIVING
- GOOD SIZE DOUBLE BEDROOM
- CONTEMPORARY BATHROOM
- SECURE ENTRY
- ALLOCATED PARKING

Tenure: Leasehold EPC Rating: E

Council Tax Band: C Service Charge: 402.00

Ground Rent: 275.00

This is a Leasehold property with details as follows; Term of Lease 125 years from 24 Jun 2006. Should you require further information please contact the branch. Please Note additional fees could be incurred for items such as Leasehold packs.

offers in excess of

£200,000



Please note the marker reflects the postcode not the actual property

check out more properties at rogerplatt.co.uk



Property Ref:
MHD123319 - 0004

1. MONEY LAUNDERING REGULATIONS Intending purchasers will be asked to produce identification documentation at a later stage and we would ask for your co-operation in order that there is no delay in agreeing the sale. 2. These particulars do not constitute part or all of an offer or contract. 3. The measurements indicated are supplied for guidance only and as such must be considered incorrect. Potential buyers are advised to recheck measurements before committing to any expense. 4. We have not tested any apparatus, equipment, fixtures or services and it is in the buyers interest to check the working condition of any appliances. 5. Where an EPC, or a Home Report (Scotland only) is held for this property, it is available for inspection at the branch by appointment. If you require a printed version of a Home Report, you will need to pay a reasonable production charge reflecting printing and other costs. 6. We are not able to offer an opinion either written or verbal on the content of these reports and this must be obtained from your legal representative. 7. Whilst we take care in preparing these reports, a buyer should ensure that his/her legal representative confirms as soon as possible all matters relating to title including the extent and boundaries of the property and other important matters before exchange of contracts.

Roger Platt is a trading name of Sequence (UK) Limited which is registered in England and Wales under company number 4268443, Registered Office is Cumbria House, 16-20 Hockliffe Street, Leighton Buzzard, Bedfordshire, LU7 1GN. VAT Registration Number is 500 2481 05.

roger platt



01628 773333



Maidenhead@rogerplatt.co.uk



25-29 Queen Street, MAIDENHEAD, Berkshire,
SL6 1NB



rogerplatt.co.uk