



Havil Street | London | SE5

Leasehold

£350,000

- Two double bedrooms
- Open plan
- Family bathroom
- First floor
- Long lease
- Off street parking
- Denmark Hill Station
- Local amenities
- Peckham
- Excellent bus routes



Two bedroom flat on the first floor of a purpose built block with private parking. The open plan kitchen / living room is spacious for entertaining and relaxing and windows, heating and kitchen have all recently been replaced. Conveniently located for all amenities in Camberwell and Peckham where you will find numerous pubs, coffee shops and cafes. Camberwell is well served by excellent bus routes, the over ground trains run from Denmark Hill a short walk away and have frequent services to Shoreditch, Clapham Junction, Clapham High Street, London Bridge and Blackfriars. Numerous local amenities make Camberwell a vibrant area with a great community.

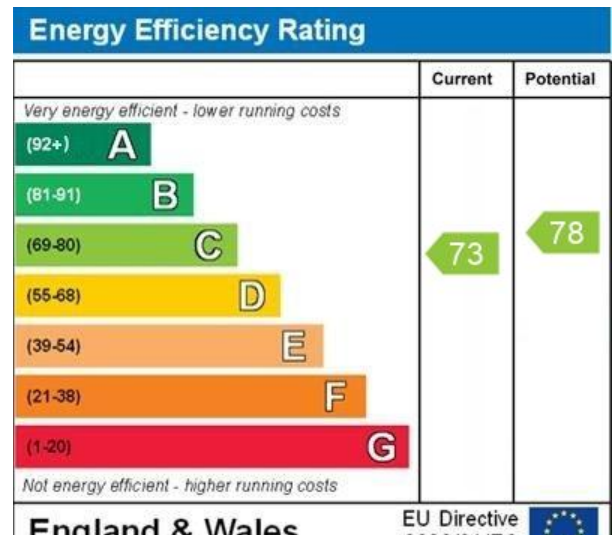

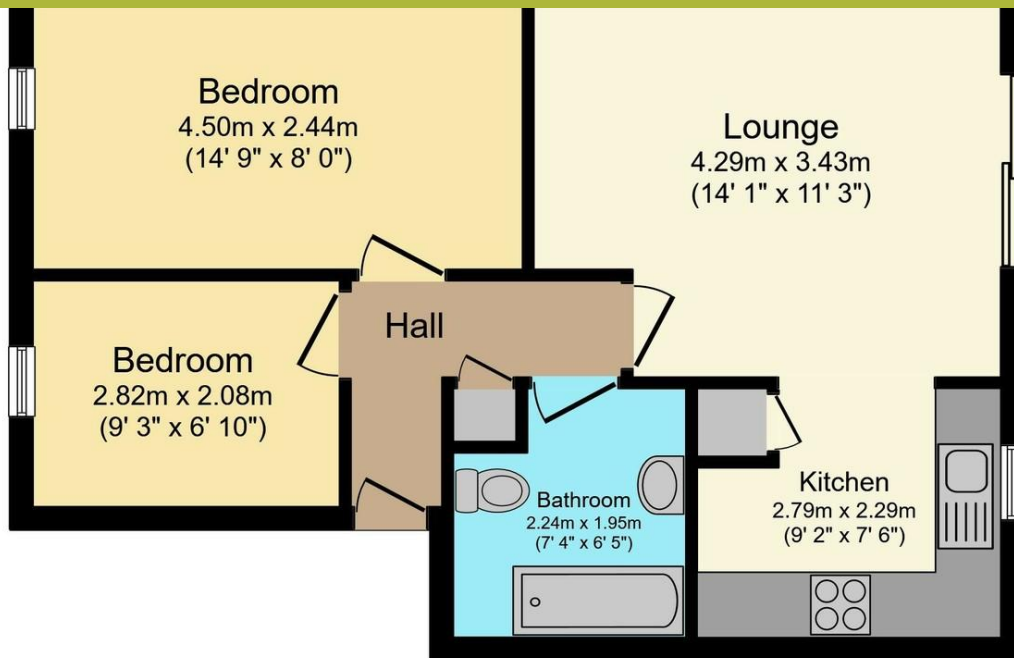

**Floor Plan**

Total floor area 47.0 sq. m. (506 sq. ft.) approx

Whilst every attempt has been made to ensure the accuracy of this floor plan, all measurements are approximate and no responsibility is taken for any error, omission or misstatement. This plan is for illustration purposes only and may not be representative of the property. Plan not to scale. Specifically no guarantee is given on the total square footage of the property if shown on this plan. Any figure given is for initial guidance only and should not be relied on as a basis of valuation. Plan produced for Purple Bricks. Powered by [www.audioagent.com](http://www.audioagent.com)

## Viewing Arrangements

Strictly by appointment

## Contact Details

121 Denmark Hill

London

SE5 8EN

[www.urbanvillagehomes.co.uk](http://www.urbanvillagehomes.co.uk)

[sales@urbanvillagehomes.com](mailto:sales@urbanvillagehomes.com)

020 3519 9121

Agents Note: Whilst every care has been taken to prepare these sales particulars, they are for guidance purposes only. All measurements are approximate are for general guidance purposes only and whilst every care has been taken to ensure their accuracy, they should not be relied upon and potential buyers are advised to recheck the measurements