

The Ashtons logo is displayed in white text on a dark blue rectangular background in the top right corner of the image. The letter 'A' is stylized with a green leaf-like shape extending from its top left.

Apartment 20 Castle Chambers 5 Clifford Street YO1 9RG

£1,750 PCM

2



2



1



C

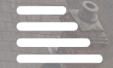

Located in the heart of the city centre is this large two bedroom apartment. Castle Chambers occupies a prime position on Clifford Street, just moments from Clifford's Tower, King's Staith, and a wealth of shops, restaurants, and cultural attractions. This luxurious apartment is offered on a furnished or Unfurnished basis and is located on the top floor top the building. Enter via spacious entrance hall with utility cupboard housing washer/dryer, leading to large open plan living/kitchen with appliances including induction hob, oven, fridge/freezer and dishwasher and breakfast bar; main bathroom with shower over bath and two large double bedrooms with fitted wardrobes, one with ensuite shower room. No onsite parking. Bike storage.

Available Now.

Council Tax Band D / EPC Rating C / Deposit £2015

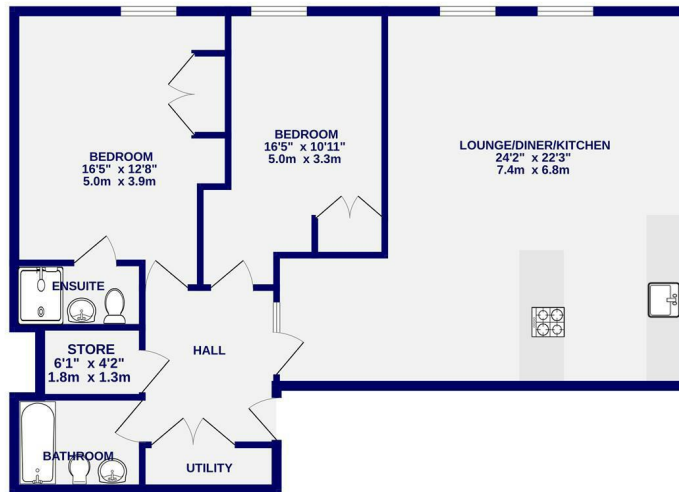

TOTAL FLOOR AREA: 972 sq.ft. (90.3 sq.m.) approx.
 Whilst every attempt has been made to ensure the accuracy of the foregoing measurements of areas and any other items are approximate. If included in the plan the dimensions will form part of the overall offer and we accept no responsibility for any errors, omissions or misstatements. This plan is for illustrative purposes only and should be used as such by any prospective purchaser. The services, systems and appliances shown have not been checked and no guarantee as to their operability.
 Made with Memento 02/25



Ashtons Lettings

01904 731404

lettings@ashtonsnet.com