

**Harlestone Road, Northampton, NN5 7AQ**

Offers Over £625,000

4 2 3



**A very handsome 4/5 Bedrooms Victorian Residence - 2500 Sq Ft private gated Driveway and garage**

Open House Coming Soon - please contact the agent to register. Property ref LO 0765

No Onwards Chain

A distinguished family home of both character and heritage, this substantial four/five-bedroom detached property sits proudly on Harlestone Road, Northampton – once forming part of the celebrated Spencer Estate, under the ownership of The Right Honourable John Poyntz Spencer,

LOUISE OWEN



@louise.owen@exp.uk.com

 louiseowen.exp.uk.com

 07774 122 959

5th Earl Spencer, Knight of the Garter. Offering five bedrooms, off road parking and garage, front and rear gardens.

Freehold

Property ref LO 0765

### Key Features

- Elegant four/five bedroom detached home on Harlestone Road, Northampton
- Substantial plot with gated driveway and landscaped gardens
- Detached two-storey garage with first-floor studio / home office
- Spacious kitchen/breakfast room perfect for family living
- Excellent transport links & proximity to town
- Local amenities & cafés within easy reach
- Green space & countryside close-by
- Well-Regarded Primary Schools Nearby
- Large basement – utility, workshop, or gym potential
- Flexible study / fifth bedroom – ideal for guests or working from home

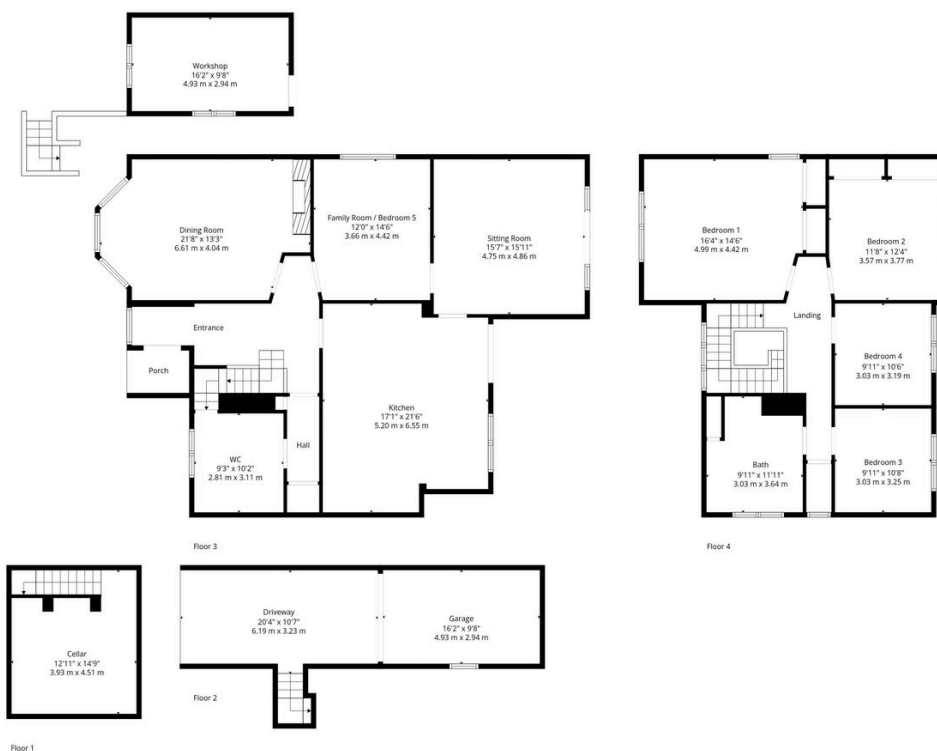

**TOTAL: 2497 sq. ft, 232 m2**  
 BELOW GRADE: 0 sq. ft, 0 m2, BELOW GRADE: 0 sq. ft, 0 m2, FLOOR 3: 1546 sq. ft, 144 m2, FLOOR 4: 951 sq. ft, 88 m2  
 EXCLUDED AREAS: CELLAR: 191 sq. ft, 18 m2, DRIVEWAY: 215 sq. ft, 20 m2, GARAGE: 156 sq. ft, 14 m2,  
 PORCH: 28 sq. ft, 3 m2, " " : 170 sq. ft, 16 m2, WALLS: 257 sq. ft, 25 m2

Floor Plan Created By Harper & Reid. Measurements Deemed Highly Reliable But Not Guaranteed

