

abbotFox



Skipper House, Norwich, NR1
£875 PCM

“

We are a team of genuine individuals who hold a deep passion for both property and marketing. Collectively, we bring over 70 years of experience in the property market of Norfolk and Suffolk. Our affection for both counties runs deep, and we are enthusiastic about sharing our passion with you.

Colin McKenzie | **Branch Partner**







THE DETAIL _____

Skipper House, Norwich

abbotFox presents this beautifully finished contemporary apartment set within the sought-after Skipper House development.

Offering bright and spacious accommodation throughout, the property features a stunning open-plan living space with modern fitted kitchen, sleek white cabinetry, integrated appliances and stylish wooden work surfaces. Large windows flood the apartment with natural light while providing an impressive outlook across the waterfront.

The bedroom accommodation is generously proportioned with a clean, modern finish and floor-to-ceiling glazing creating a bright and airy feel. The luxury bathroom has been finished to a high standard with contemporary tiling, floating vanity unit and shower over bath.

Finished throughout in neutral tones with quality wood flooring, recessed lighting and modern fixtures, this apartment is ideal for professionals seeking stylish city living.

Perfectly positioned close to Norwich City Centre, the Riverside development and Norwich Train Station, Skipper House offers convenient access to a wide range of local amenities, restaurants and transport links.

An internal viewing is highly recommended.

THE HIGHLIGHTS _____

- One bedroom ground floor apartment
- High specification fixtures and fittings
- City centre location
- Lift to all floors
- Secure video intercom
- Smart WiFi underfloor heating

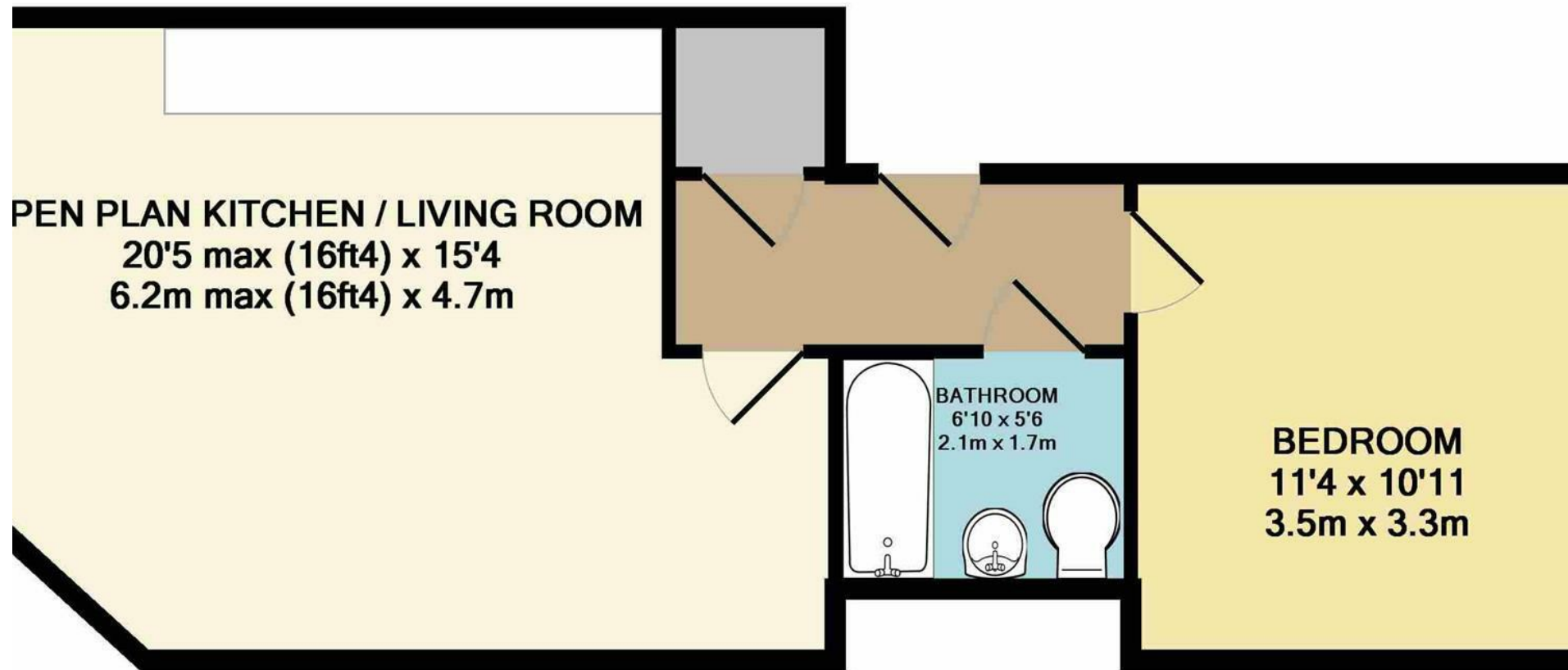

TOTAL APPROX. FLOOR AREA 481 SQ.FT. (44.7 SQ.M.)

Whilst every attempt has been made to ensure the accuracy of the floor plan contained here, measurements of doors, windows, rooms and any other items are approximate and no responsibility is taken for any error, omission, or mis-statement. This plan is for illustrative purposes only and should be used as such by any prospective purchaser. The services, systems and appliances shown have not been tested and no guarantee as to their operability or efficiency can be given

Made with Metropix ©2017

Let's talk

01603 660000

sales@abbotfox.co.uk

@abbotfox

EPC RATING -

Disclaimer – In accordance with the Property Misdescriptions Act, the company abbotFox gives notice that all descriptions, references to condition, necessary permissions for use and other details are given in good faith and believed to be correct, but any purchaser should not rely on them as statements of fact, and must satisfy themselves by inspection or other means, as to their accuracy.