



## EDGE HILL, SW19

£2,750 per month

Three bedrooms  
Two bathrooms  
Communal gardens  
Garage  
Off-street parking  
Energy rating: c

@marshandparsons  
marshandparsons.co.uk

MARSH &  
PARSONS



# ABOUT THE PROPERTY

A three bedroom apartment available to rent in Tina Court. The property benefits from a private garage and parking on a first come first served basis.

Located moments from Wimbledon Common and close to Wimbledon Village.



# STEP INSIDE EDGE HILL

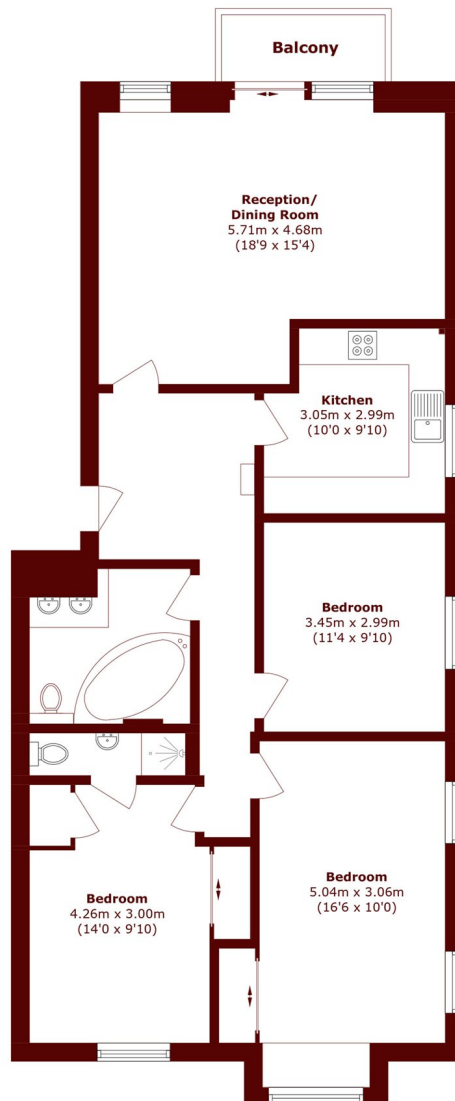

Total area (approx.): 98.9 sq. m (1064.5 sq. ft)

Balcony area (approx.): 2.9 sq. m (31.2 sq. ft)

Wimbledon  
020 8879 6661

Energy Rating: C We aim to make our particulars both accurate and reliable. However, they are not guaranteed; nor do they form part of an offer or contract. If you require clarification on any points then please contact us, especially if you're traveling some distance to view. Please note that appliances and heating systems have not been tested and therefore no warranties can be given as to their good working order

MARSH &  
PARSONS